

CartStop Adjustable Rack Guard Installation Instructions

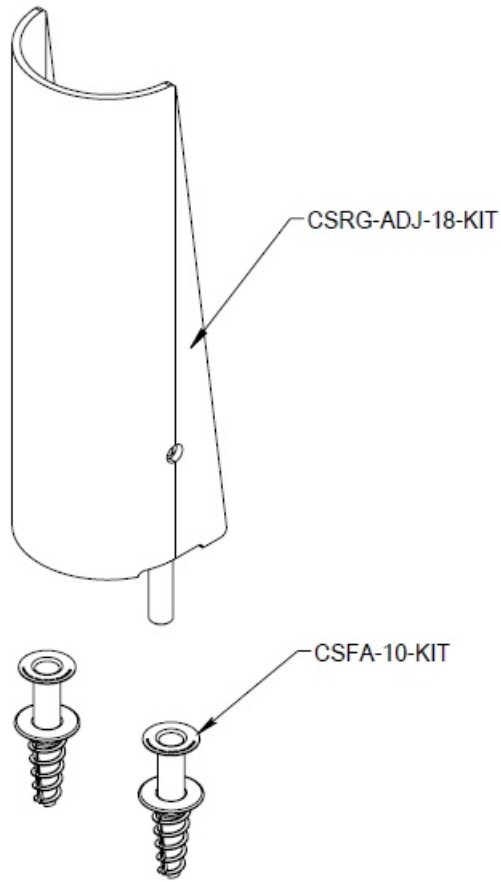

Tools Required:

- Hammer Drill with 1" Carbide bit
- Tape Measure
- Pencil
- Allen Wrench Set
- Rubber Mallet
- Straight Edge
- Brush and Dust Pan
- Chalk Line
- Carpenter Square or Framing Square
- Plumb Bob

Step 1: Layout

Measure $\frac{3}{4}$ " away from the rack column and snap a chalk line.

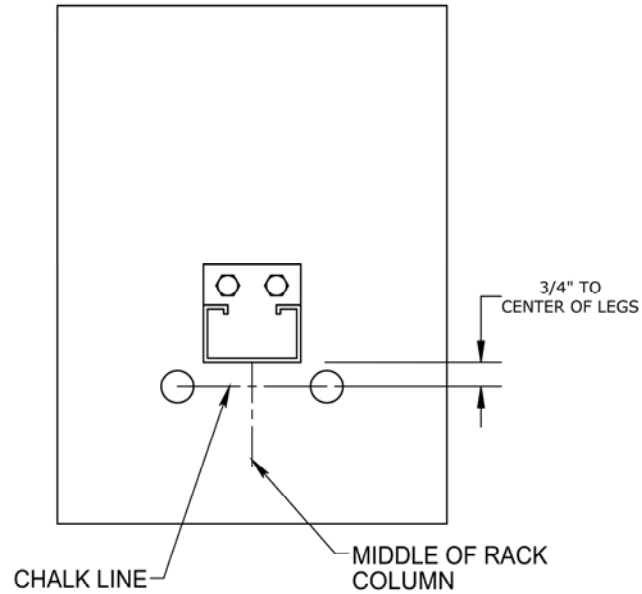

Position the CartStop Adjustable Rack Guard on the chalk line so that the chalk line is at the center of each leg. Trace a circle around the base of each leg with a pencil to mark two circles on the floor.

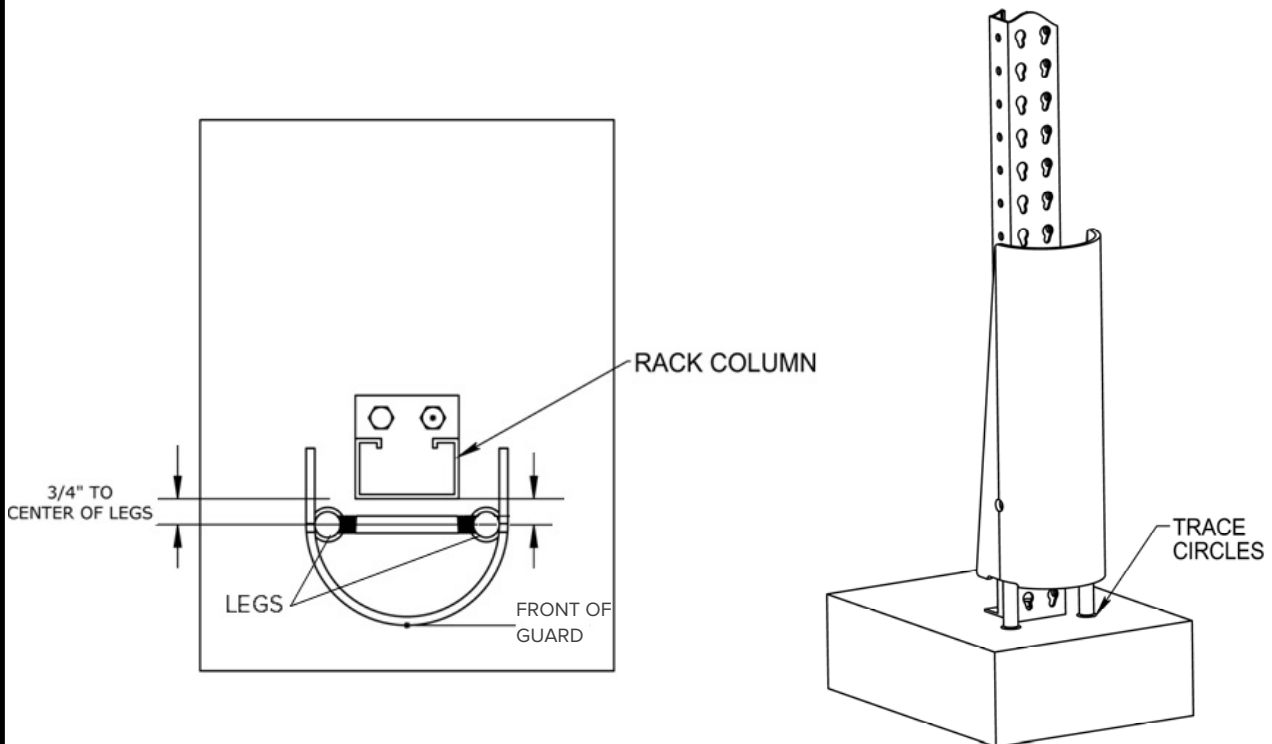

Step 2: Drilling the Leg Holes

Drill a hole that is 1" diameter and 3 1/4" deep for each marked circle.

Remove dust and debris from holes.

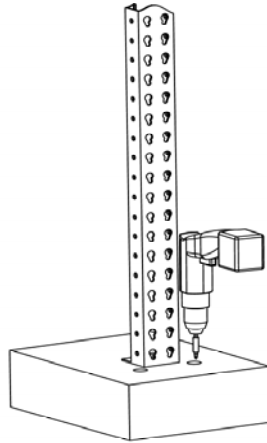

Step 3: Installing the Flange Anchor Assemblies

1. Insert the flange anchor assembly into the holes.
2. Use a rubber mallet to strike the flange anchors until they are secure in the floor holes.
3. Be sure the top of stainless steel sleeve is flush and fully seated on top of the plastic flange anchor.

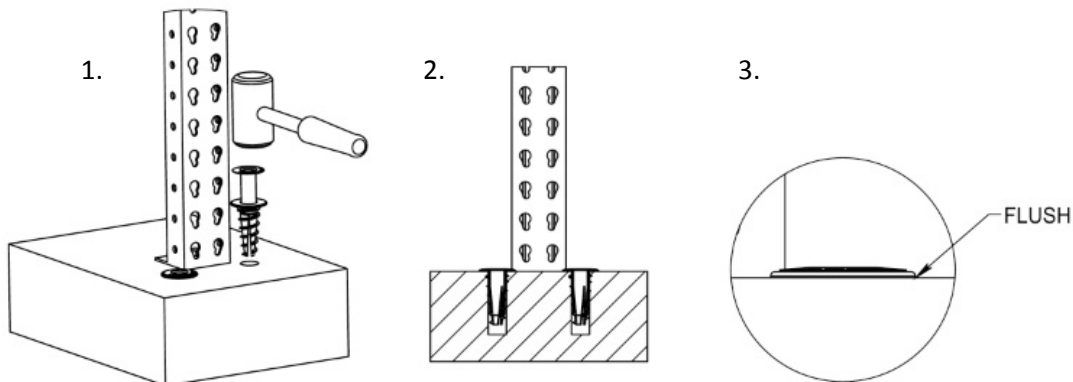

Epoxy Installation Option: If you wish to use epoxy, fill about half the floor hole with Simpsons Acrylic Anchoring Adhesive. Remove the plastic sleeve from the anchor flange assembly and push the metal sleeve into the hole. The top of the flange should fit flush against the floor. Let anchoring adhesive dry and chip away excess adhesive.

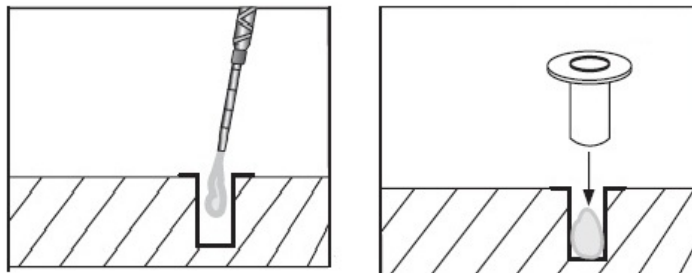

Step 4: Installing and Adjusting Legs

Insert the legs of the CartStop Adjustable Rack Guard into the flange assemblies that have been installed in the floor.

If adjustment is needed, use a 1/4" wrench to adjust legs inward or outward to fit the center to center dimension. Rotate level arm up to move legs outward or rotate level arm down to move legs inward.

TIP: to fully lock guard into place, once situated in flange sleeves, rotate the level arm in either direction to ensure a snug fit.

Once the legs are situated in the flange assemblies, push the guard down so that it is fully seated in the flange sleeves.

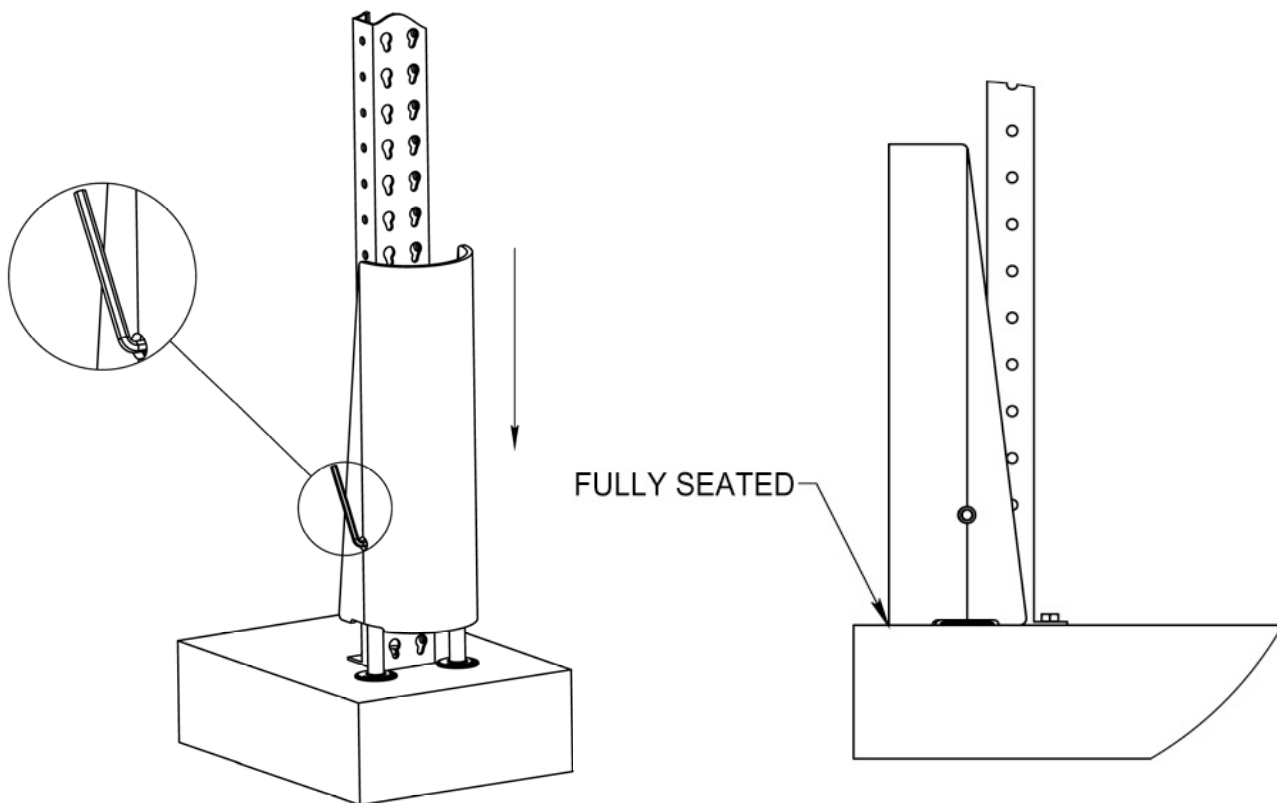

Step 5: Installation is Complete

