

FlexCore Bollard

INSTALLATION INSTRUCTIONS

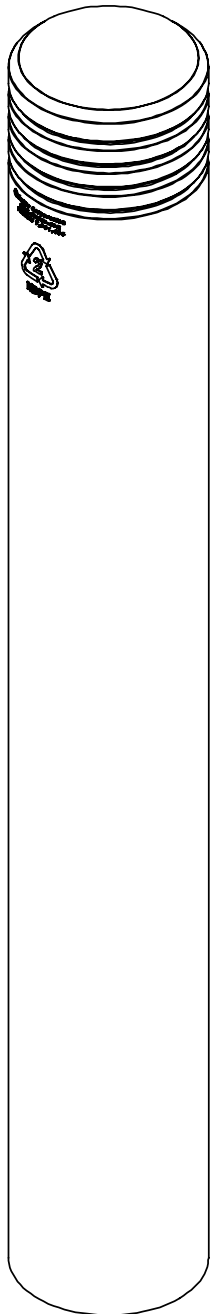

FlexCore 6

FC6

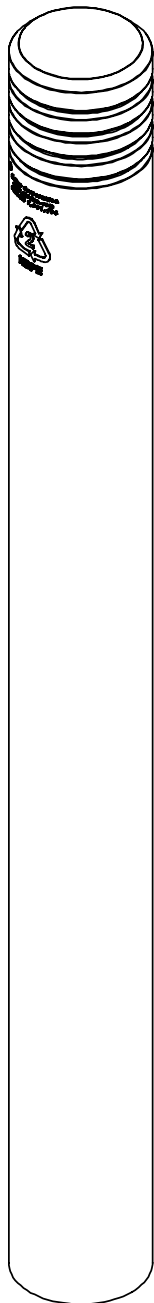

FlexCore 4

FC4

Components

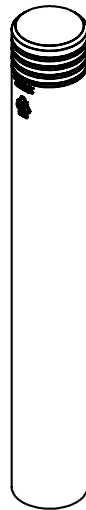

Shell

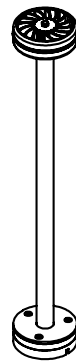

Core Assembly

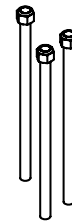

Fixings (3)



Epoxy / Resin

Optional

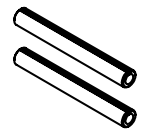

Locking Pin (2)

Tools Required

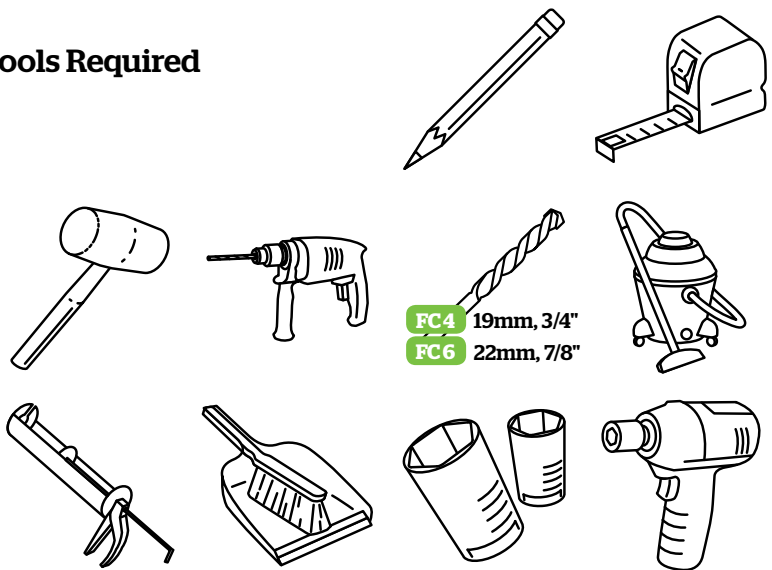

FC4 19mm, 3/4"
FC6 22mm, 7/8"



McCue Corporation
Peabody, Massachusetts, USA
+1 (800) 800 8503
customer@McCue.com

McCue UK & Europe
Milton Keynes, United Kingdom
+44 (0)1908 365 511
uksales@McCue.com

McCue Asia
迈客(厦门)有限公司
Xiamen, Fujian, China
+86-592-2200790

mccue.com





1

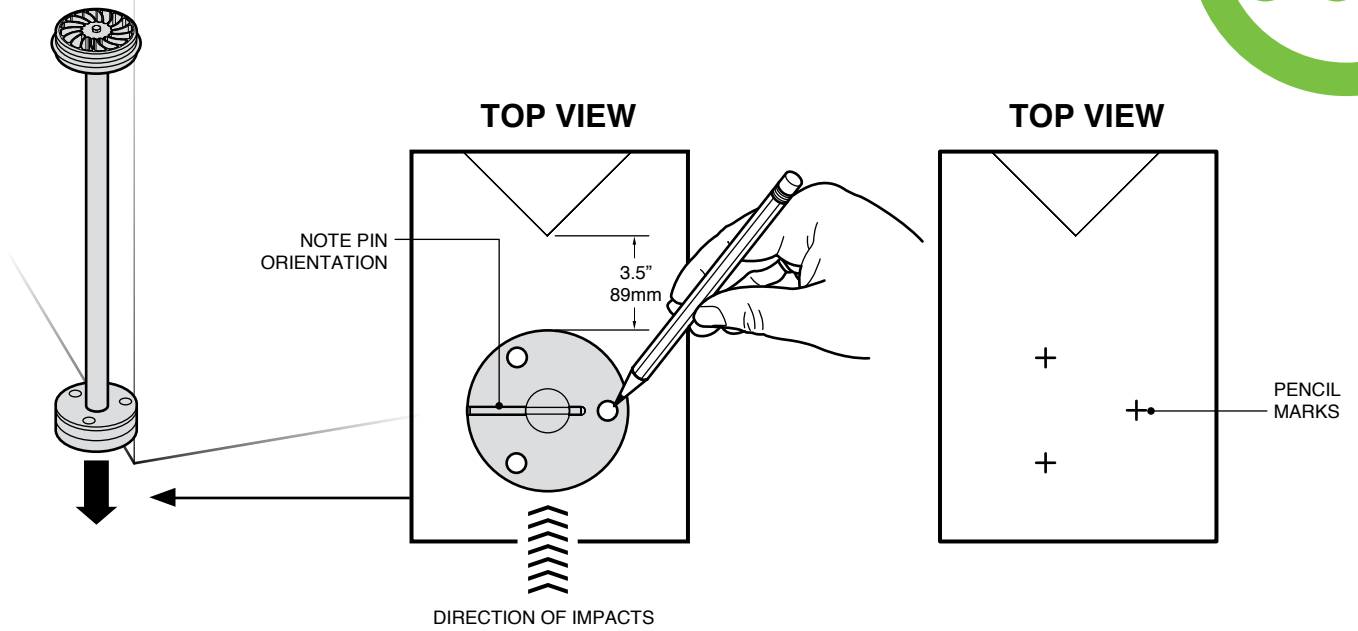

2

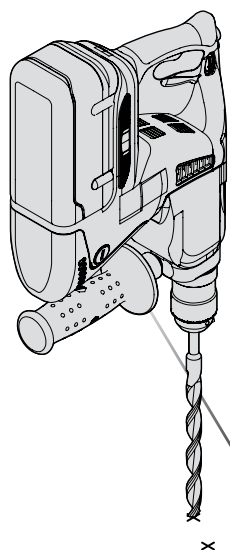

FlexCore 6

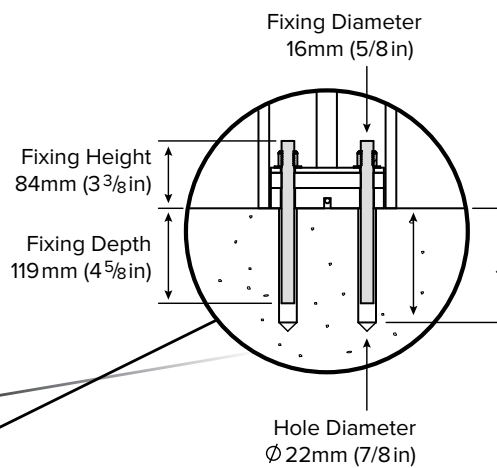

FlexCore 4

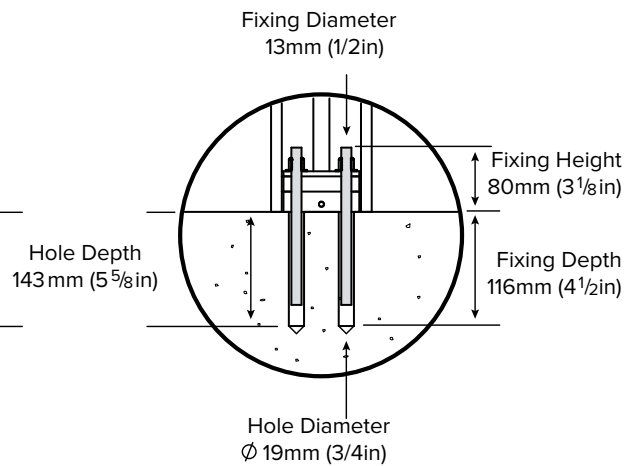



3

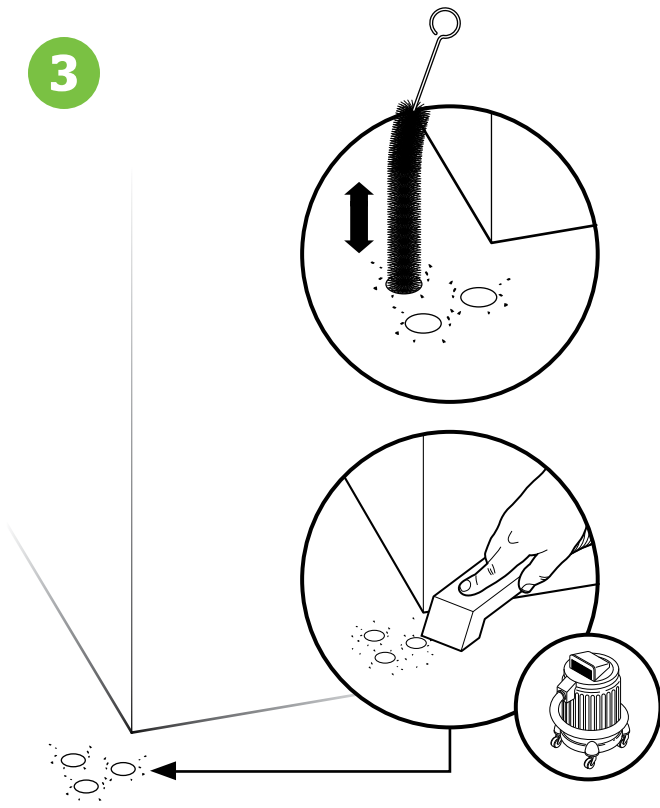

4

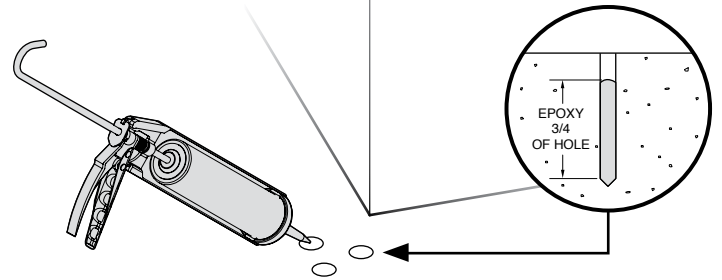

5

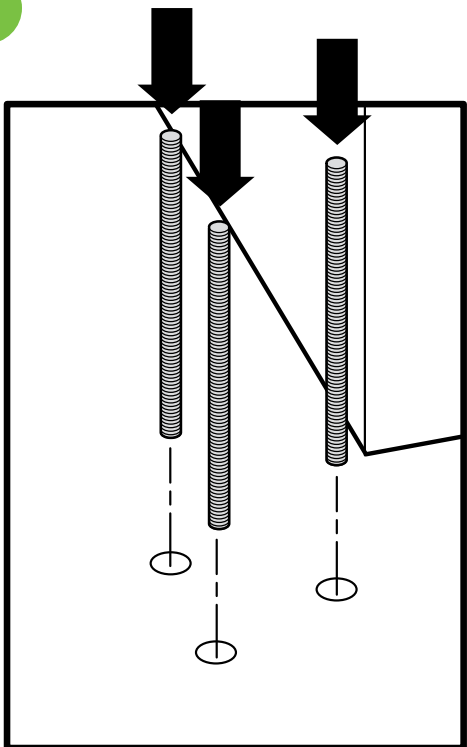

6

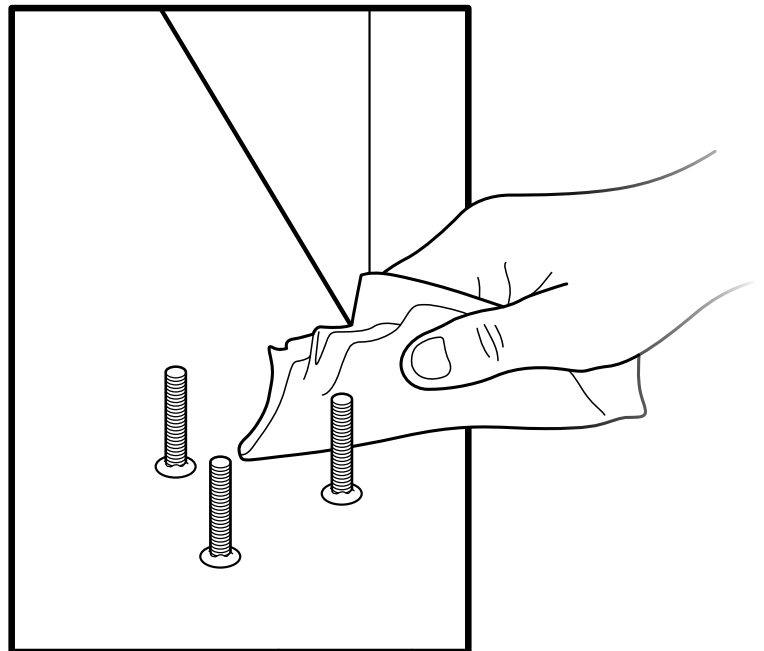



7

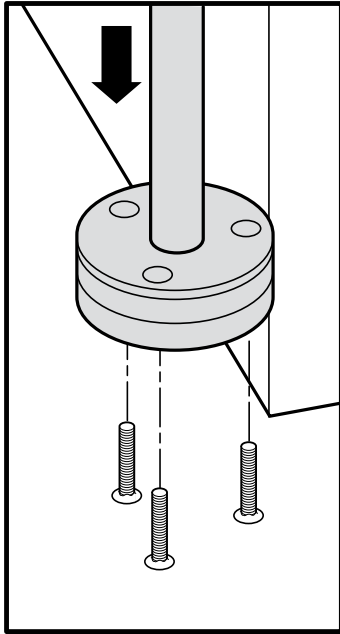

8

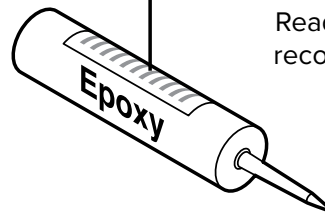
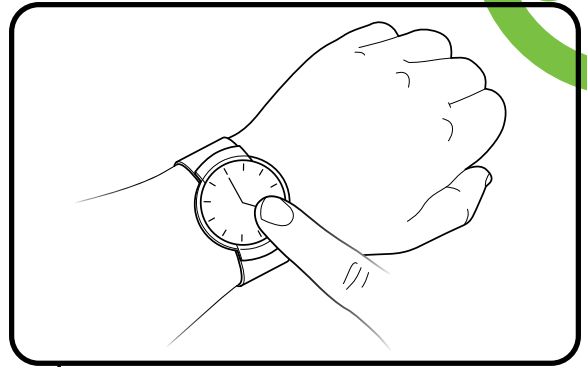

Read Epoxy instructions for recommended drying times.

9

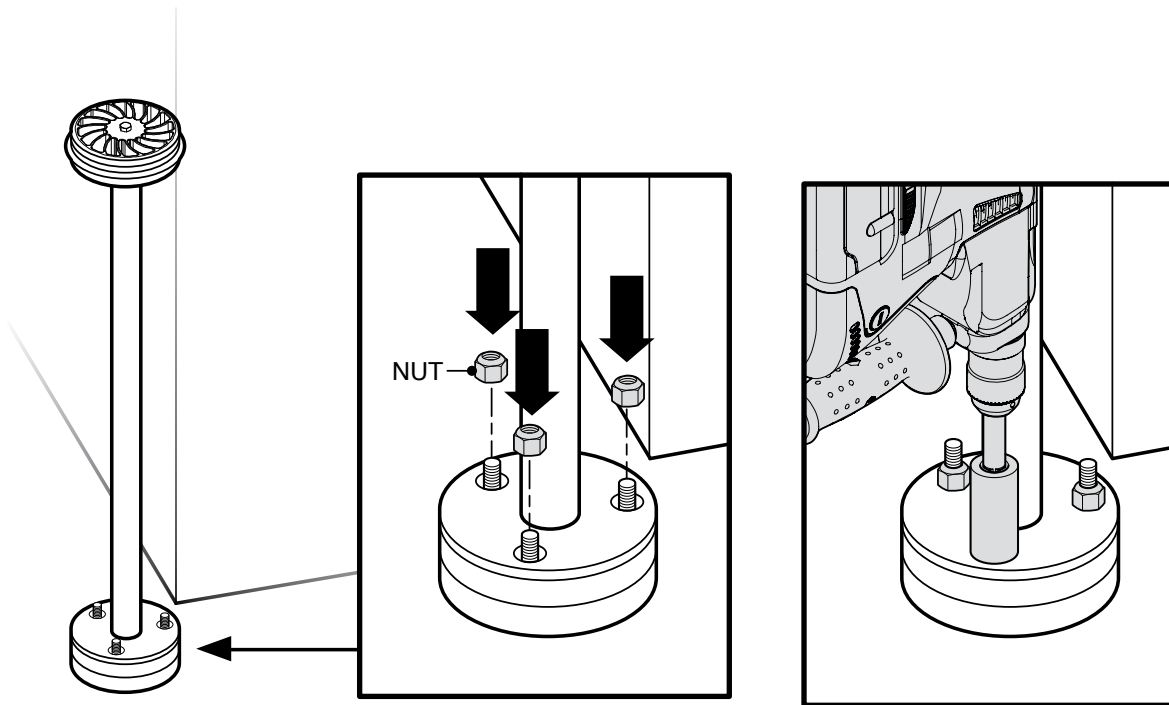



10

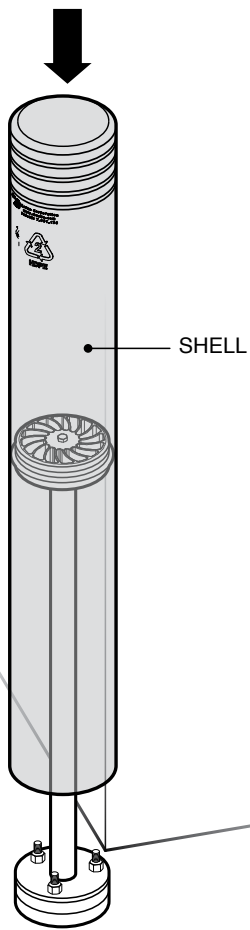

11



Optional

Opcional
Fakultativ
Optionnel
可选

