

FLEX+ Bollard



Installation Instructions



Components

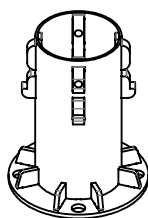

FLX-COR
Base Core

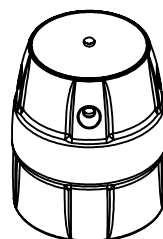

FLX-C-B
PolyCore Base
and Hardware

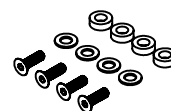

FLX-C-CAP
Cap, Post Washers
and Hardware

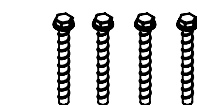

HW-C-A12-5 OR
HW-C-M12-130
Concrete Anchors

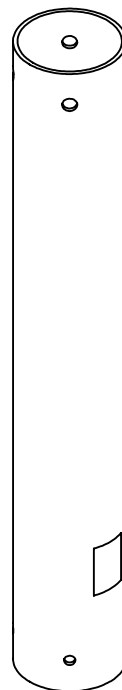

FBL-C-P
Post

Required Tools

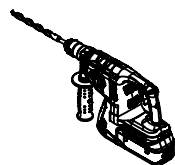

Hammer Drill With
Ø 12mm [1/2in] Masonry Bit



Impact
Driver

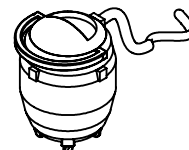

Vacuum



Marker

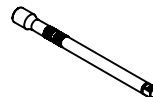

Extender



Hex Socket
17mm [3/4in]



Hex Bit
8mm [5/16in]



McCue Corporation
Danvers, Massachusetts, USA
+1(800) 800 8503
cservices@mccue.com

McCue UK
Milton Keynes, United Kingdom
+44 (0)1908 365 511
uksales@mccue.com

McCue Asia
Xiamen, Fujian, China
+8 592 2200790
rchen@mccue.com

McCue Europe
Magirus-Deutz-Straße 14
89077 Ulm, Germany
+49 731 40 38 82 68
eusales@mccue.com

mccue.com

Step 1

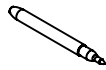

Marker

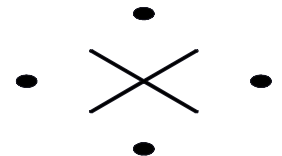
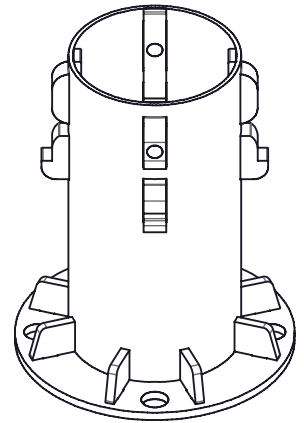
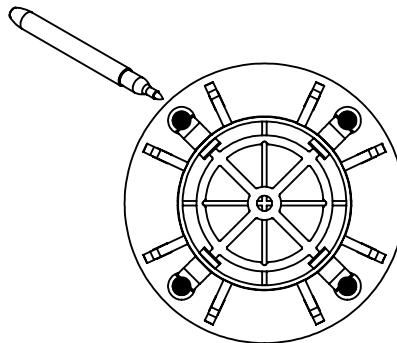
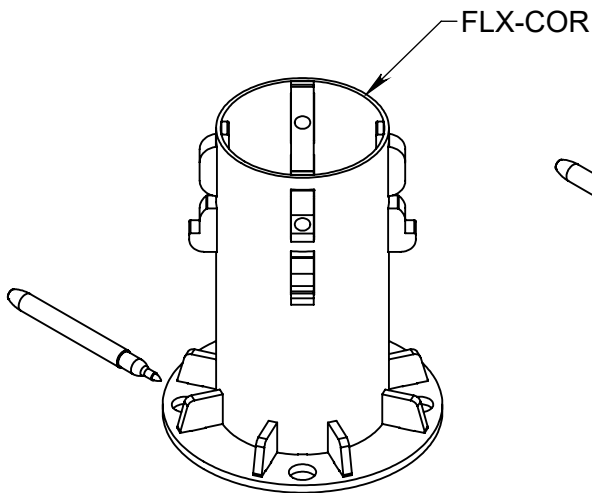

Step 2

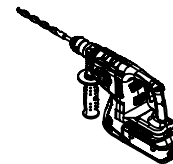
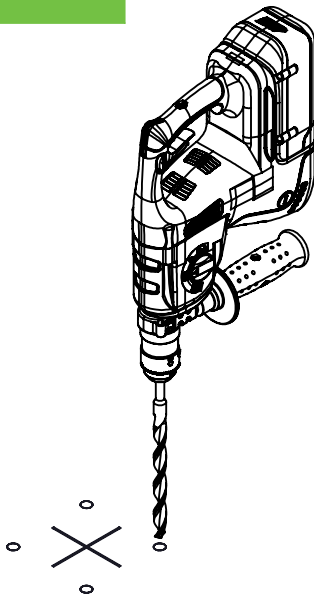

Hammer Drill With
Ø 12mm or 1/2in Masonry Bit

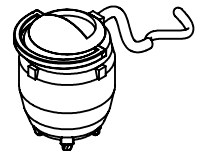

Vacuum

HW-C-A1250
IMPERIAL
ANCHOR DETAIL

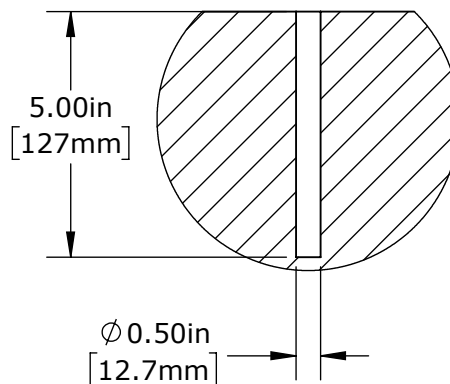

HW-C-AM12-130
METRIC
ANCHOR DETAIL

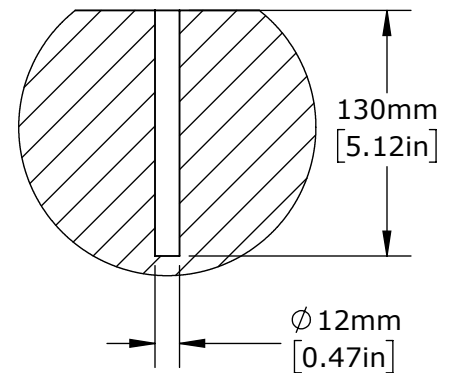

Step 3

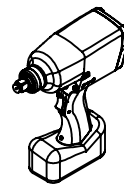

Impact Driver

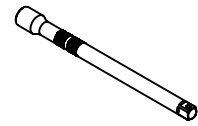

Extender



17mm [3/4in]
Hex Socket

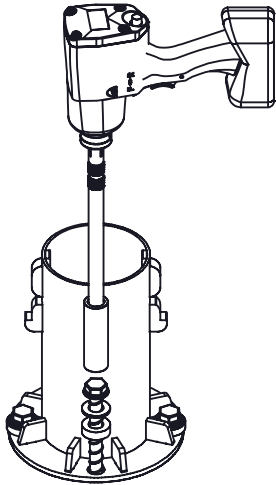

HW-C-A1250 or
HW-C-AM12-130

HW-WSH-ANC

HW-DPR

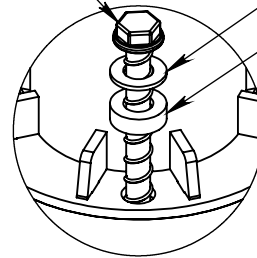

ANCHOR DETAIL

Step 4

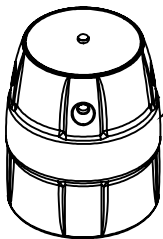
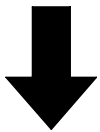

FLX-C-B

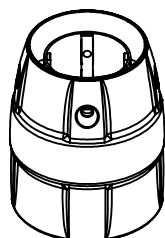
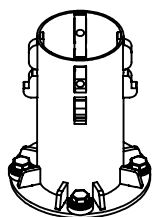

Step 5

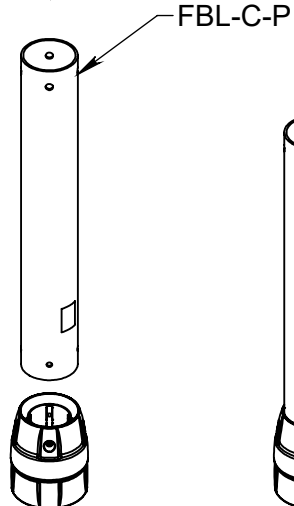
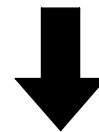

FBL-C-P

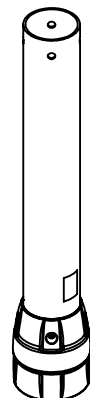

Step 6



Impact
Driver



Hex Bit
8mm [5/16in]

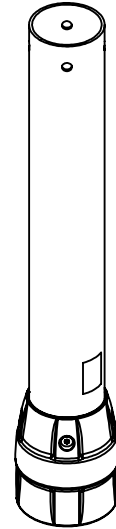
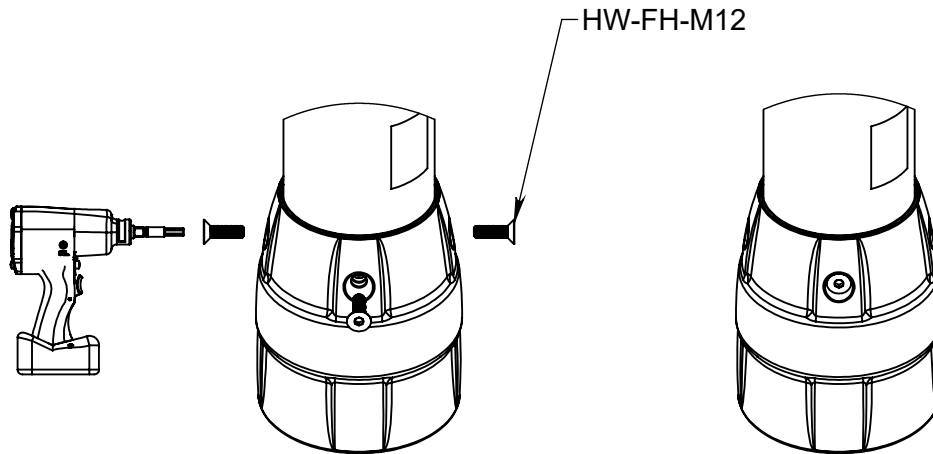

Step 7

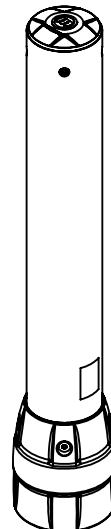
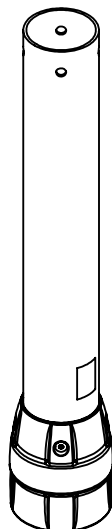
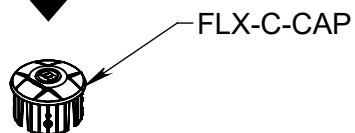
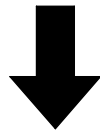

Step 8



Impact
Driver



Hex Bit
8mm [5/16in]

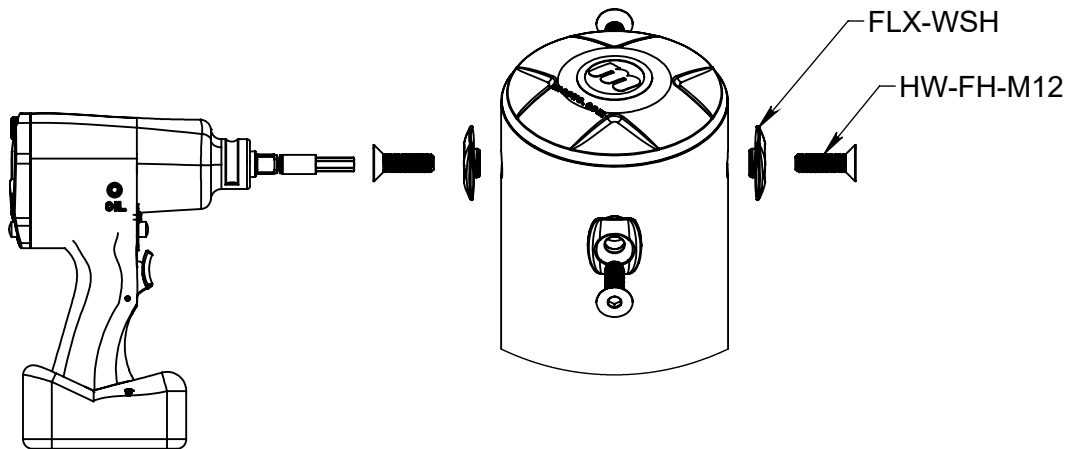

Installation Complete

