

FLEX+ Ground Guard Installation Instructions

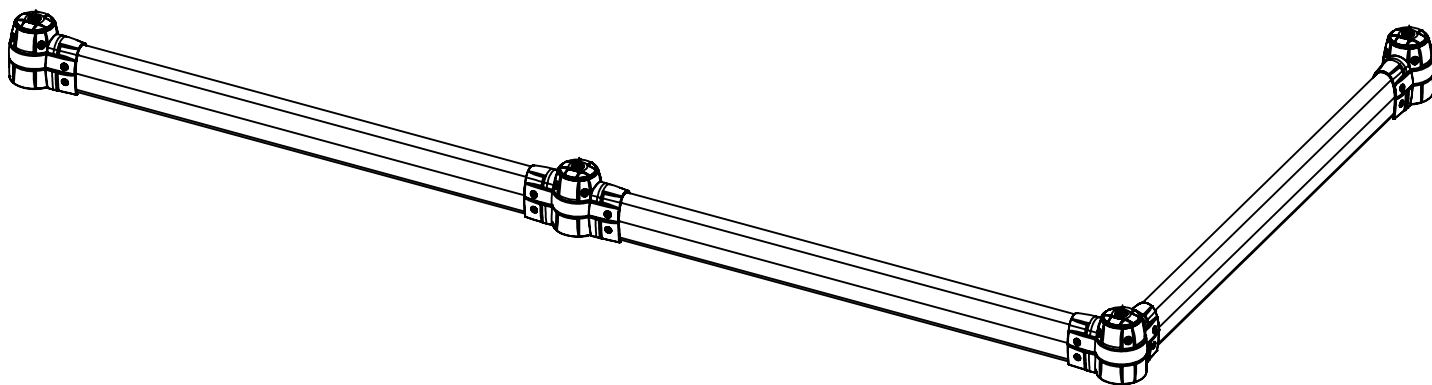

Kits

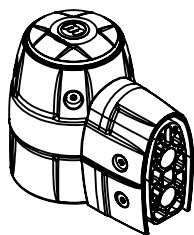

FGG-K-END
Ground Guard
End Post

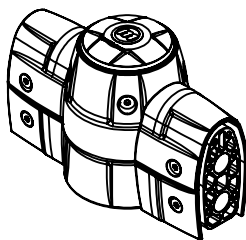

FGG-K-MID
Ground Guard
Mid Post

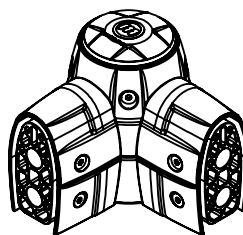

FGG-K-CNR
Ground Guard
Corner Post

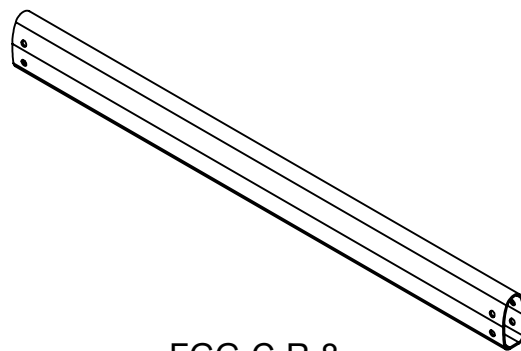

FGG-C-R-8
Ground Guard
Rail



McCue Corporation
Danvers, Massachusetts, USA
+1(800) 800 8503
cservices@mccue.com

McCue UK
Milton Keynes, United Kingdom
+44 (0)1908 365 511
uksales@mccue.com

McCue Asia
Xiamen, Fujian, China
+8 592 2200790
rchen@mccue.com

McCue Europe
Magirus-Deutz-Straße 14
89077 Ulm, Germany
+49 731 40 38 82 68
eusales@mccue.com

mccue.com



Components

PolyCore Base End FLX-C-B-END

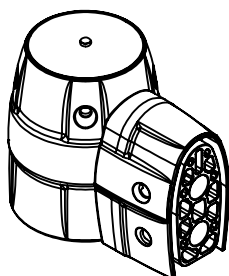

Base Cover End
FLX-BCV-END
QTY: 1

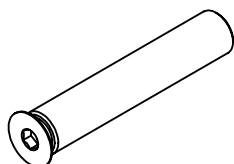

100mm Pin (Black)
PIN-100
QTY: 2

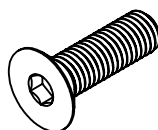

Flat Head Screw
HW-FH-M12
QTY: 6



Anchor Washer
HW-WSH-ANC
QTY: 4



Damper
HW-DPR
QTY: 4

PolyCore Base Mid FLX-C-B-MID

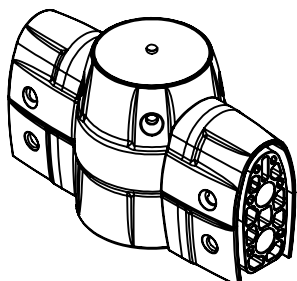

Base Cover Mid
FLX-BCV-MID
QTY: 1

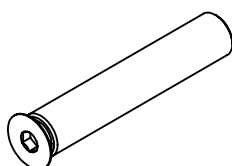

100mm Pin (Black)
PIN-100
QTY: 4

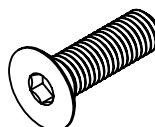

Flat Head Screw
HW-FH-M12
QTY: 8



Anchor Washer
HW-WSH-ANC
QTY: 4



Damper
HW-DPR
QTY: 4

PolyCore Base Corner FLX-C-B-CNR

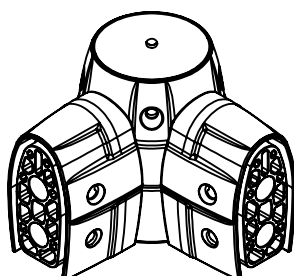

Base Cover Corner
FLX-BCV-CNR
QTY: 1

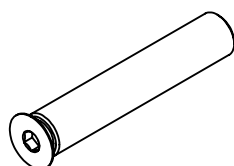

100mm Pin (Black)
PIN-100
QTY: 4

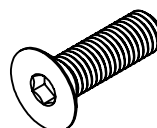

Flat Head Screw
HW-FH-M12
QTY: 8



Anchor Washer
HW-WSH-ANC
QTY: 4



Damper
HW-DPR
QTY: 4

Components

Ground Guard Base Core FLX-COR-GG

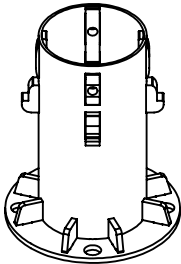

Ground Guard Base Core
(YELLOW)
FLX-COR

Ground Guard Cap FLX-CAP-GG

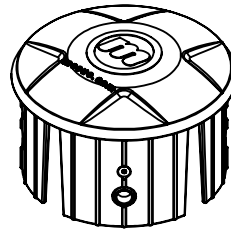

Ground Guard Cap
FLX-CAP-GG

Concrete Anchor (Imperial or Metric) HW-C-A1250 or HW-C-AM12-130

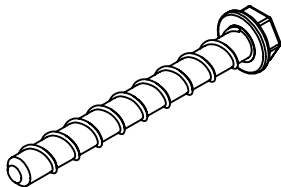

Concrete Anchor
HW-C-A1250 or
HW-C-AM12-130

Post FGG-C-P

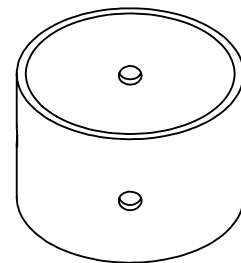

Post
FGG-C-P

Ground Guard Rail FGG-C-R-8

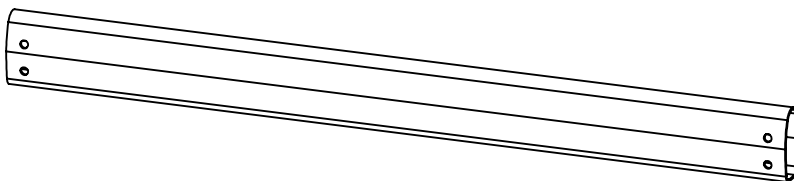

Ground Guard Rail
FGG-C-R-8

Required Tools

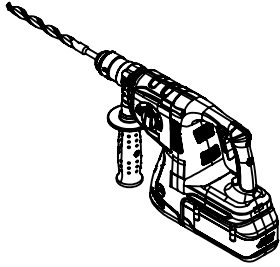

Hammer Drill With
Ø 12mm [1/2in] Masonry Bit

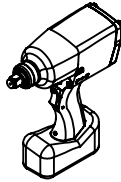

Impact
Driver



Vacuum

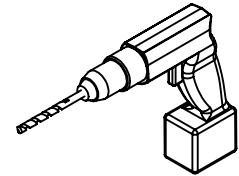

Drill with
Ø 20mm [3/4in] Bit

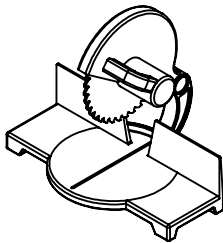

Mitre Saw



Hex Key
8mm [5/16in]

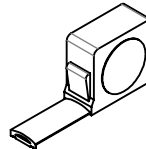

Measuring Tape

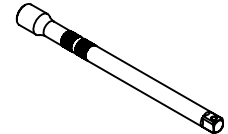

Socket Extender

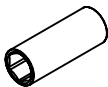

Hex Socket
17mm [3/4in]

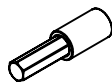

Hex Bit
8mm [5/16in]



Chalk Line

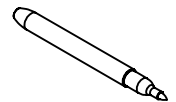

Marker



PPE recommended: High Visibilty Vest, Steel Toe Boots, Work Gloves, Ear Protection, Dust Mask, Eye Protection.

Step 1

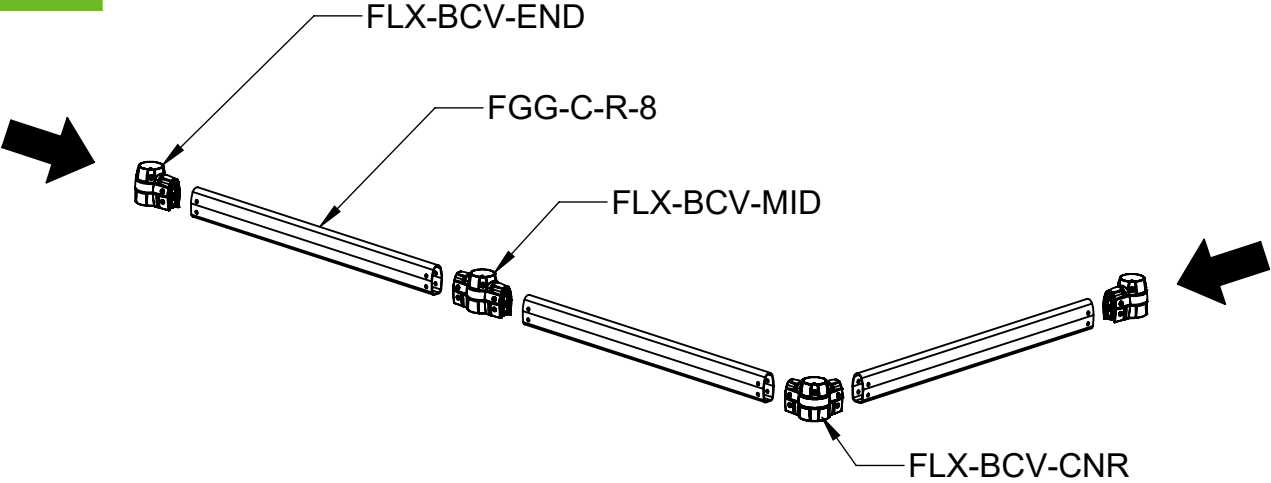

Step 2

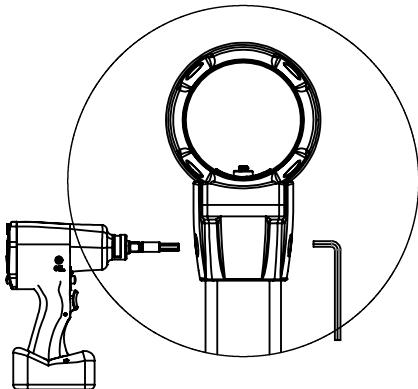
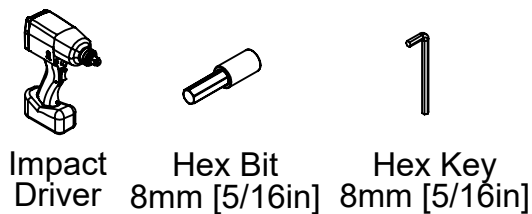
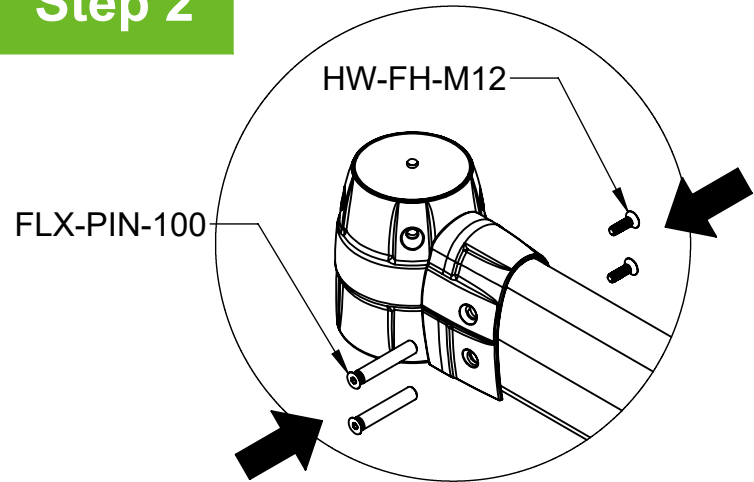

Step 3



Chalk Line

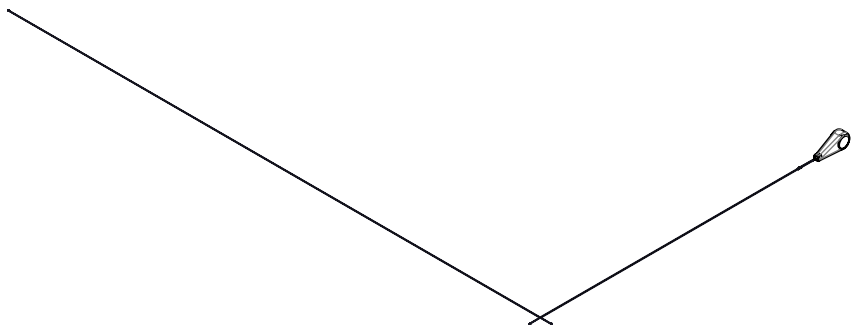

Step 4

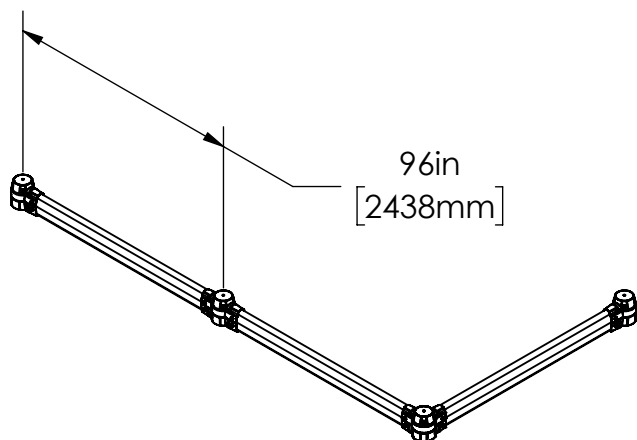
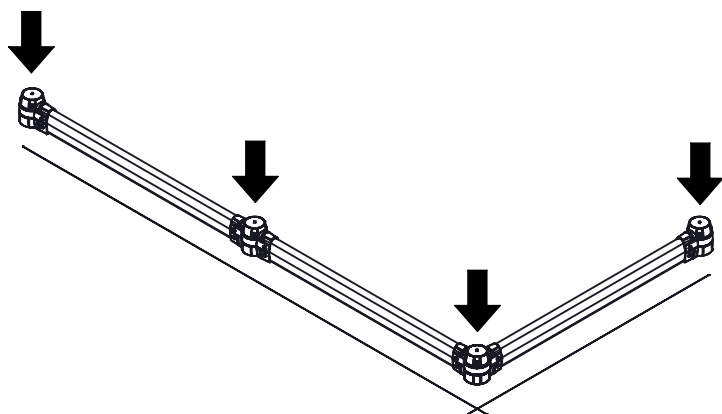

Step 5



Marker



Centermark
Template

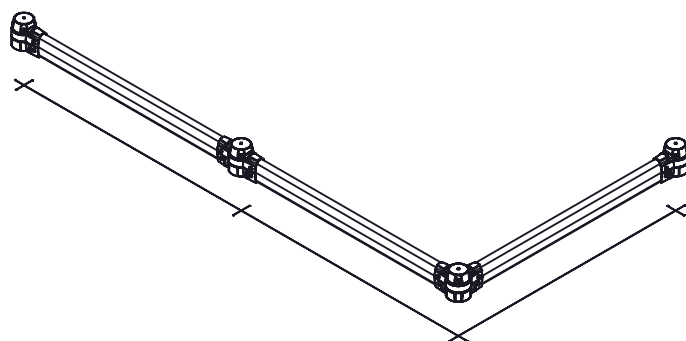
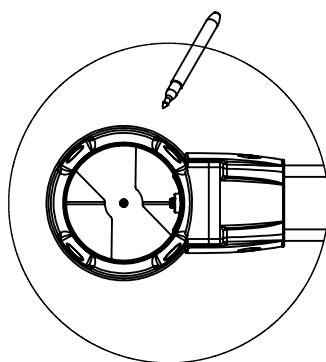
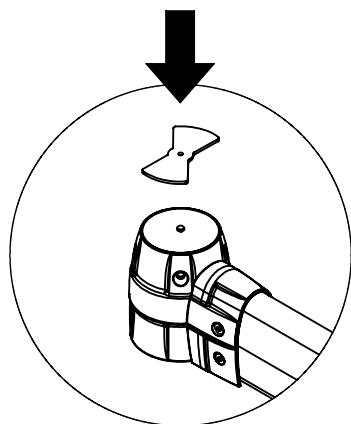

Step 6

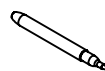

Marker

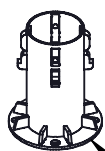

Base Core
FLX-COR

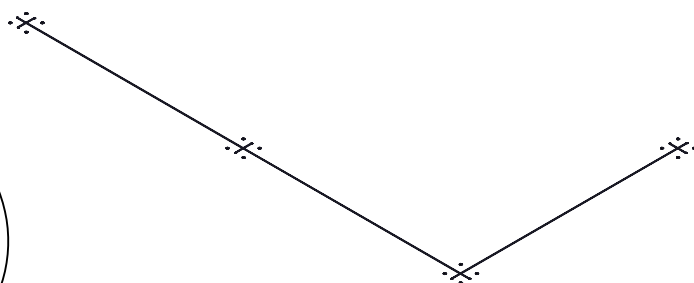
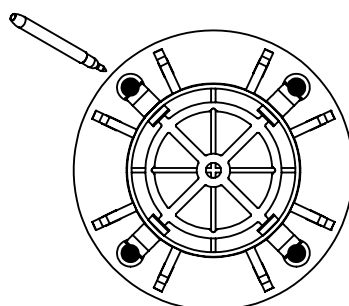

Step 7

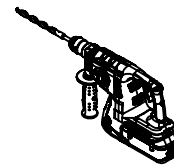
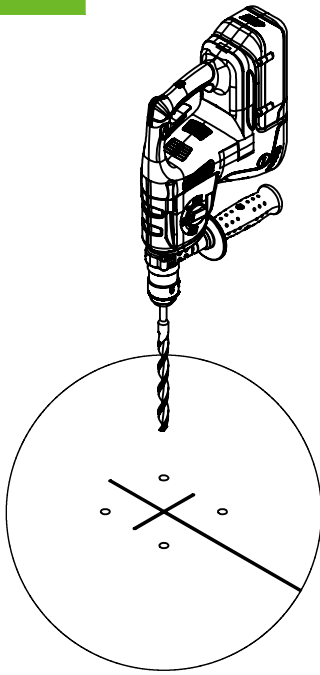

Hammer Drill With
 \varnothing 12mm [1/2in]
 Masonry Bit



Vacuum

HOLE DETAIL
 IMPERIAL
 HW-C-A1250

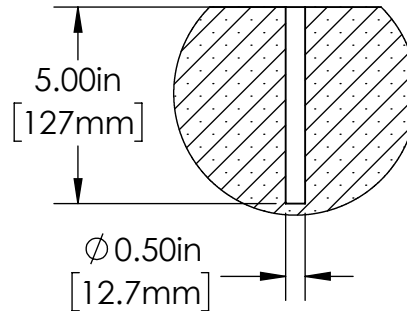

HOLE DETAIL
 METRIC
 HW-C-AM12-130

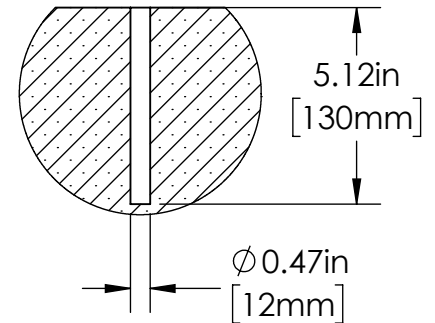

- PPE recommended: High Visibility Vest, Steel Toe Boots, Work Gloves, Ear Protection, Dust Mask, Eye Protection.
- Clean concrete dust by running the vacuum during drilling.

Step 8

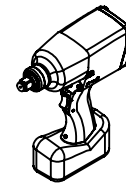
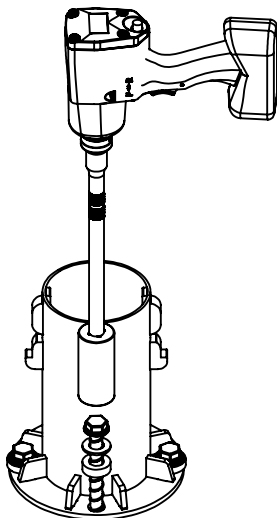

Impact
 Driver

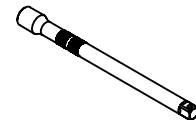

Extender



17mm [3/4in]
 Hex Socket

HW-C-A1250 or
 HW-C-AM12-130

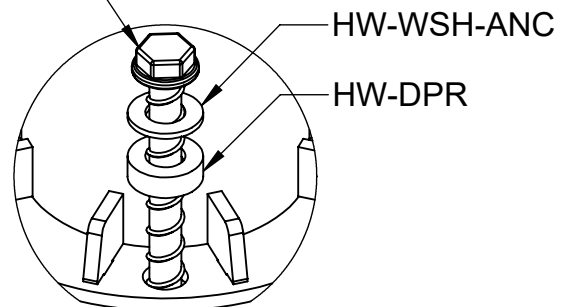

ANCHOR DETAIL

Step 9

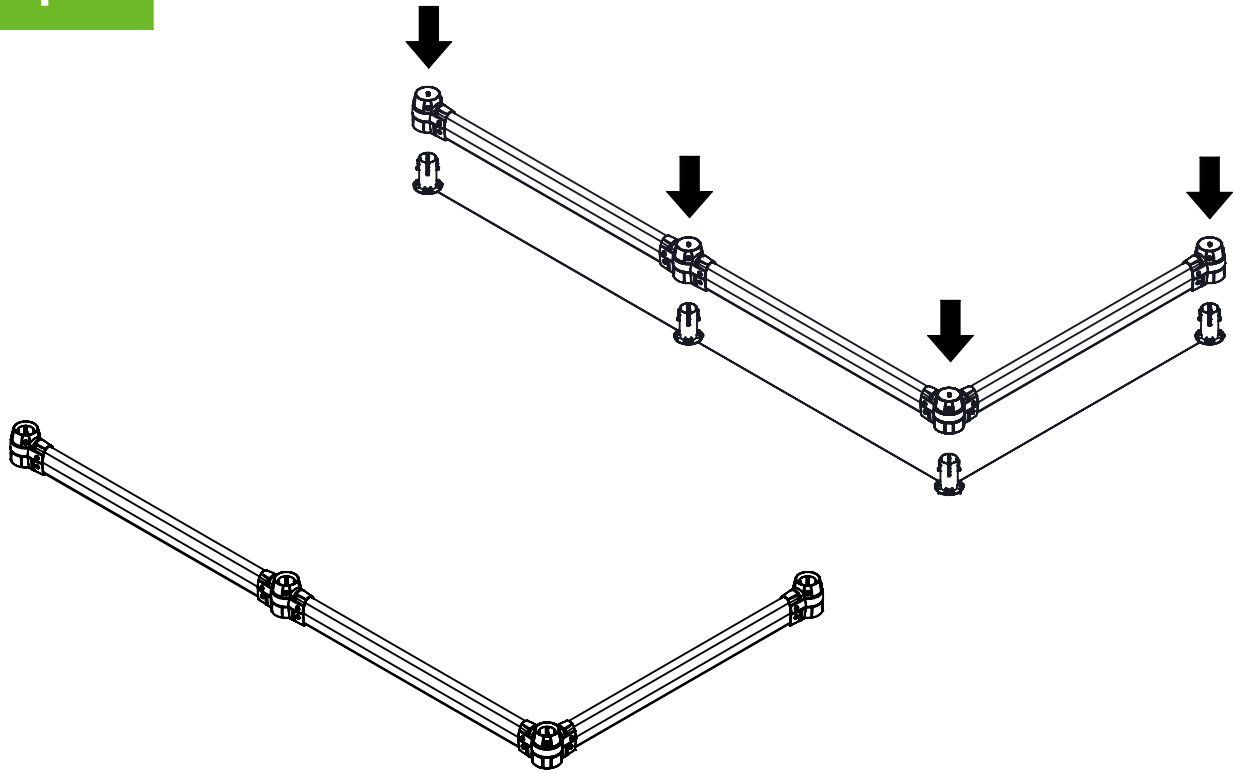

Step 10

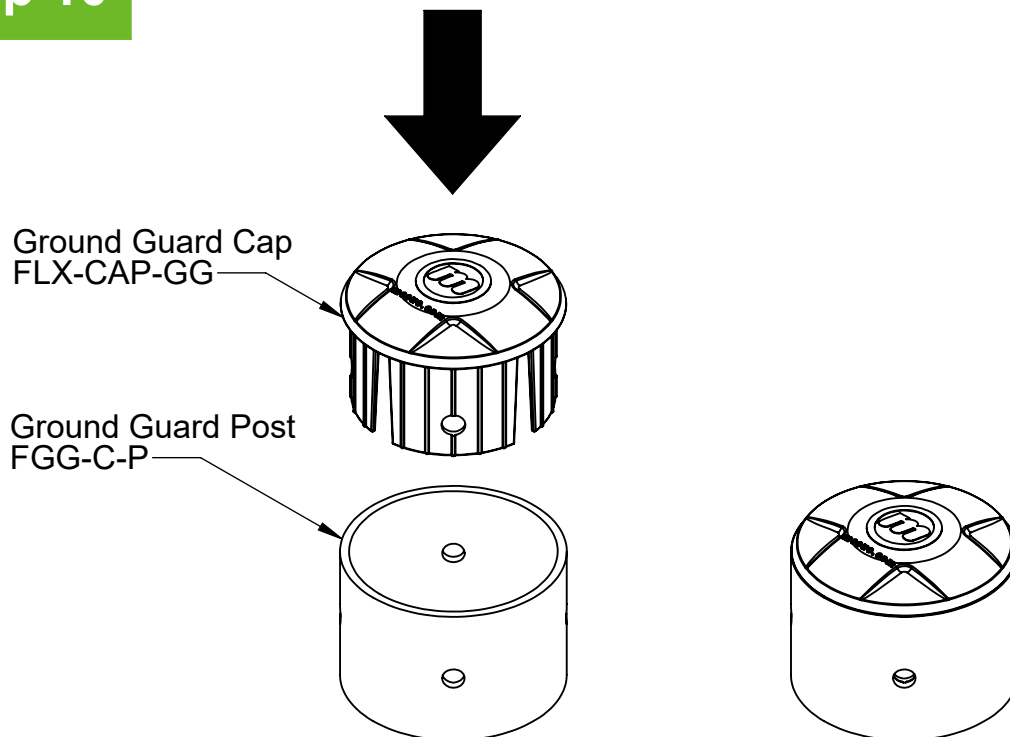

Step 11

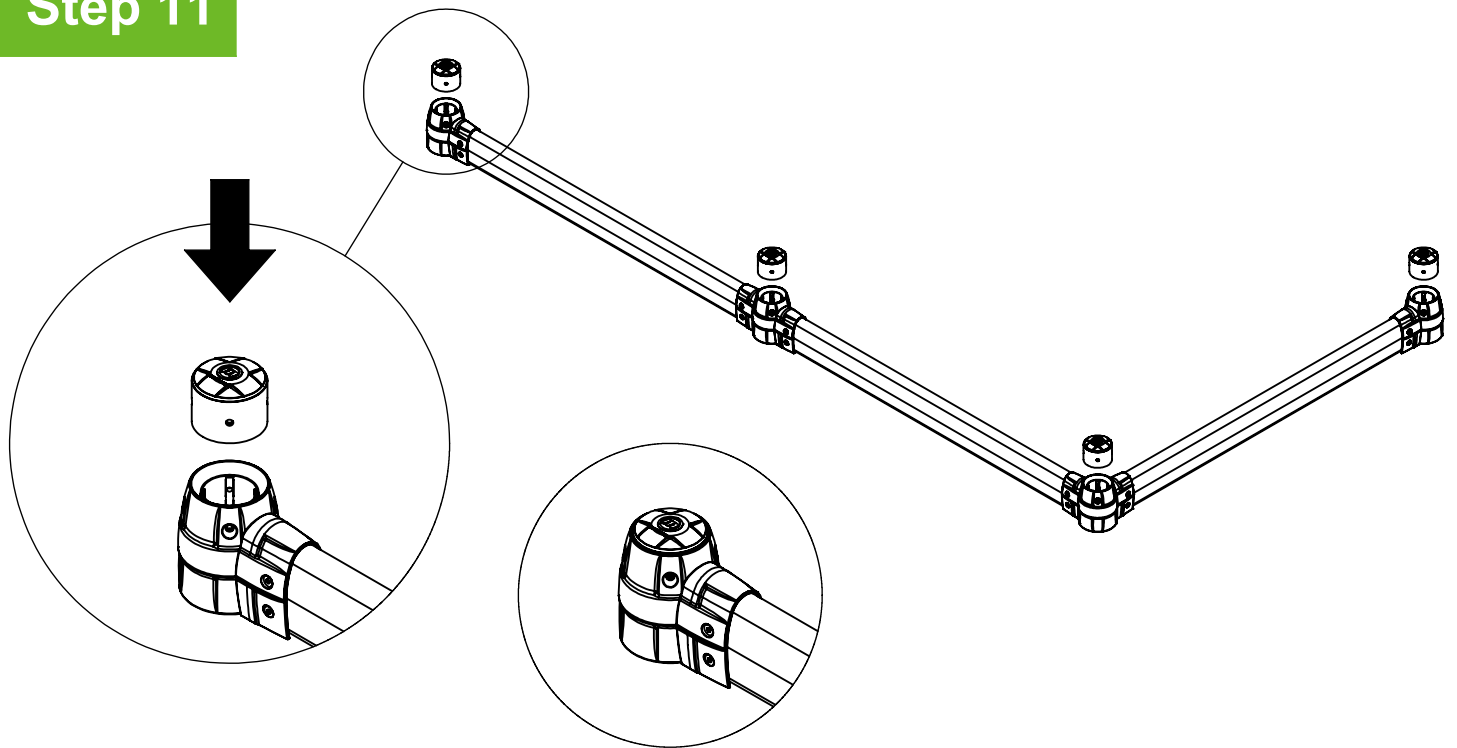

Step 12

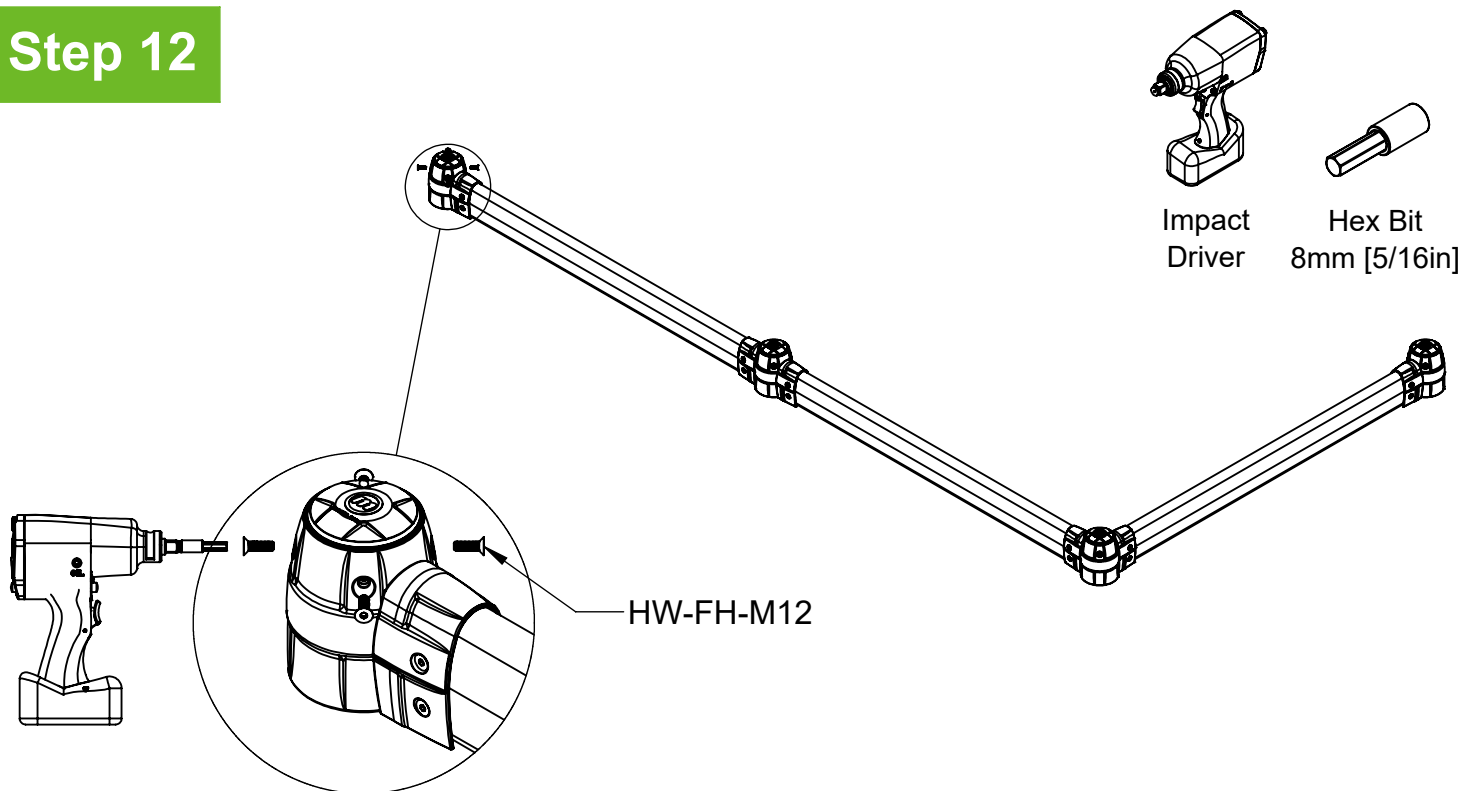

REPEAT FOR ALL POSTS

Appendix A: Custom Length Rails

Step A1

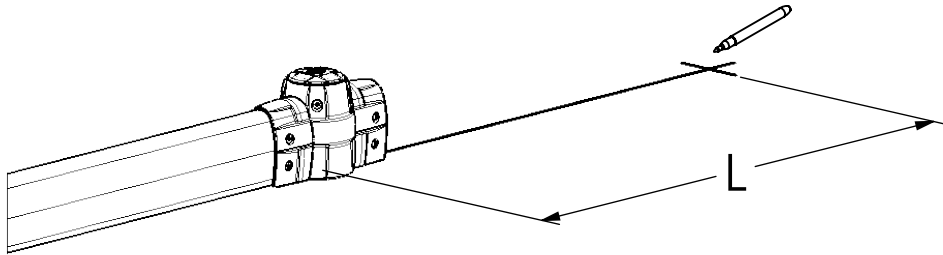
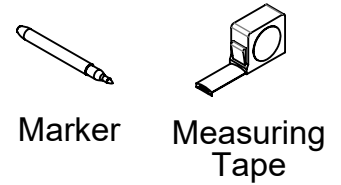

Step A2

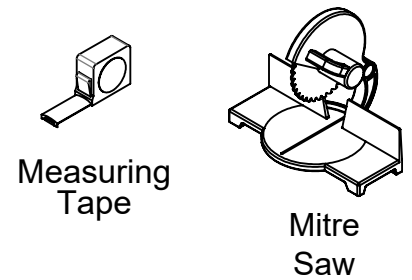

Ground Guard Rail FGG-C-R-8

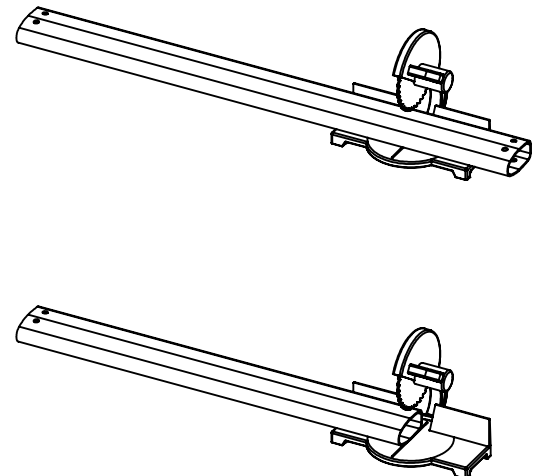
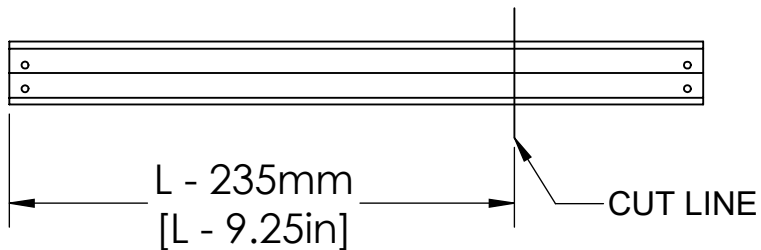

Step A3



Marker

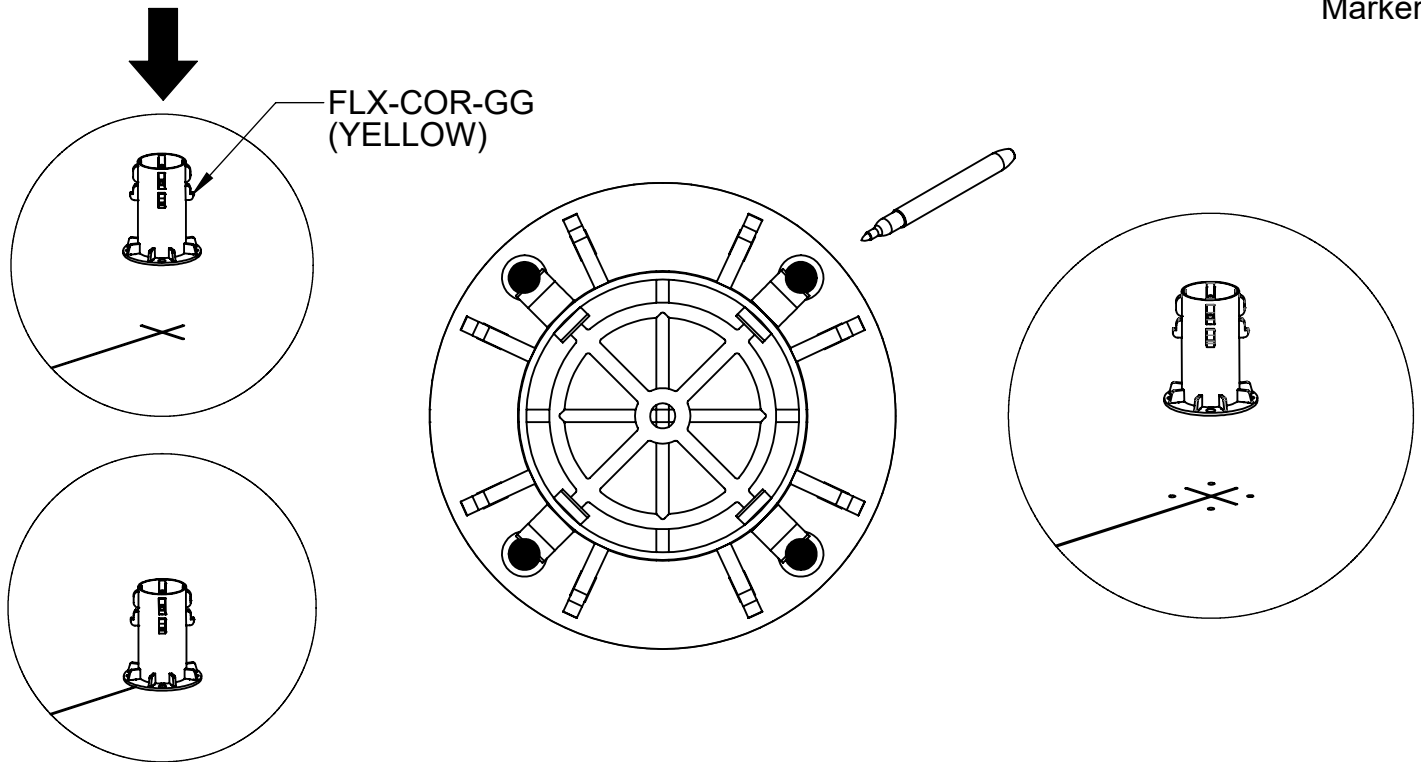

Step A4

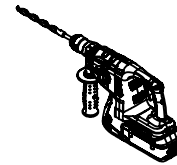

Hammer Drill With
 \varnothing 12mm or \varnothing 1/2in
Masonry Bit



Vacuum

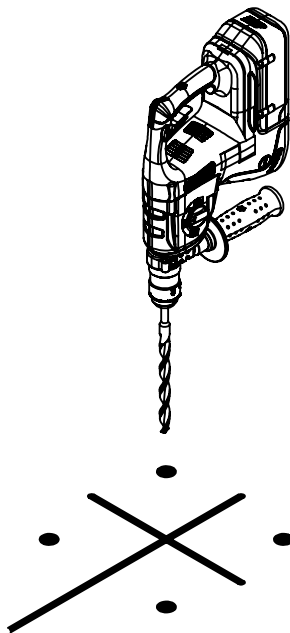

HOLE DETAIL
IMPERIAL
HW-C-A1250

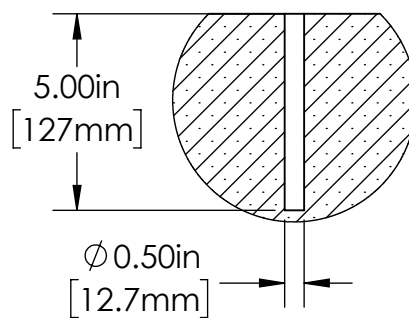

HOLE DETAIL
METRIC
HW-C-AM12-130

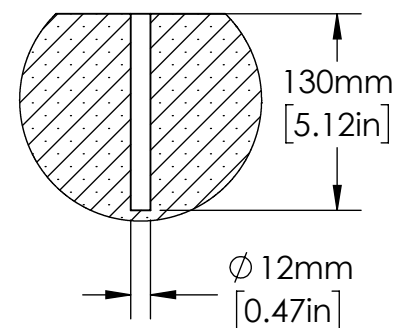

- PPE recommended: High Visibility Vest, Steel Toe Boots, Work Gloves, Ear Protection, Dust Mask, Eye Protection.
- Clean concrete dust by running the vacuum during drilling.

Step A5

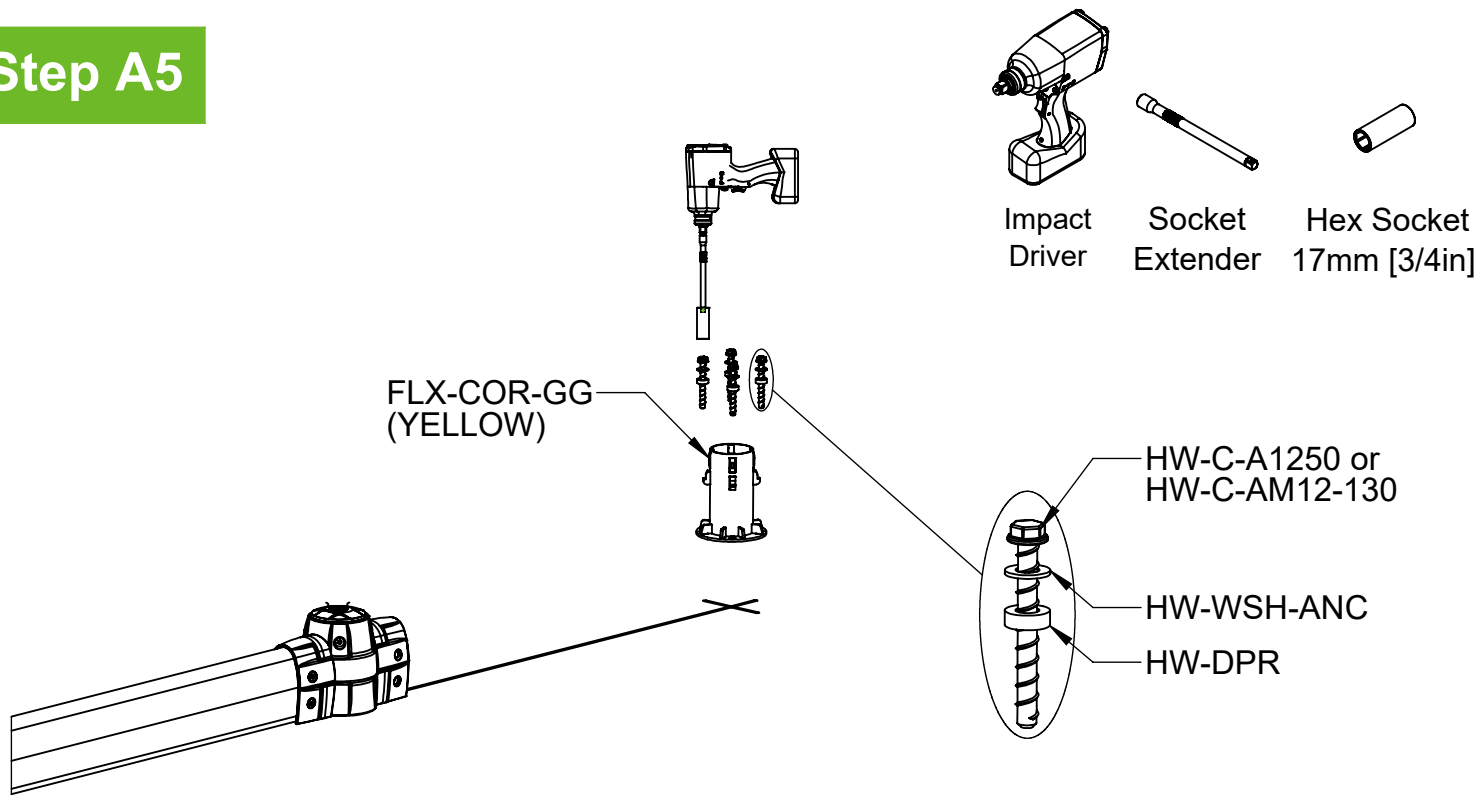

Step A6

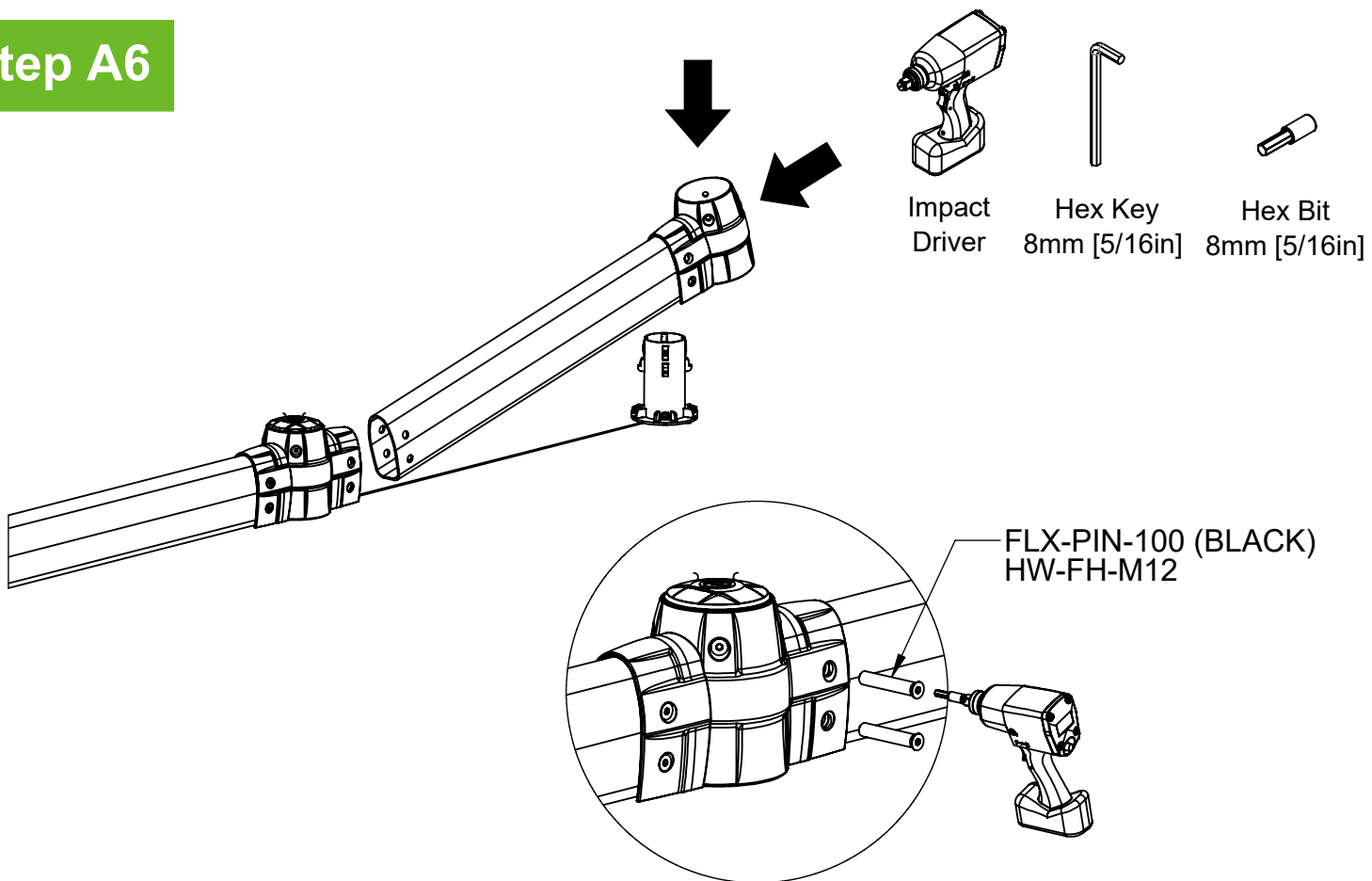

Step A7

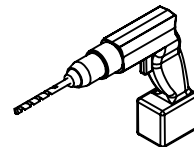

Drill with
20mm [3/4in] Bit

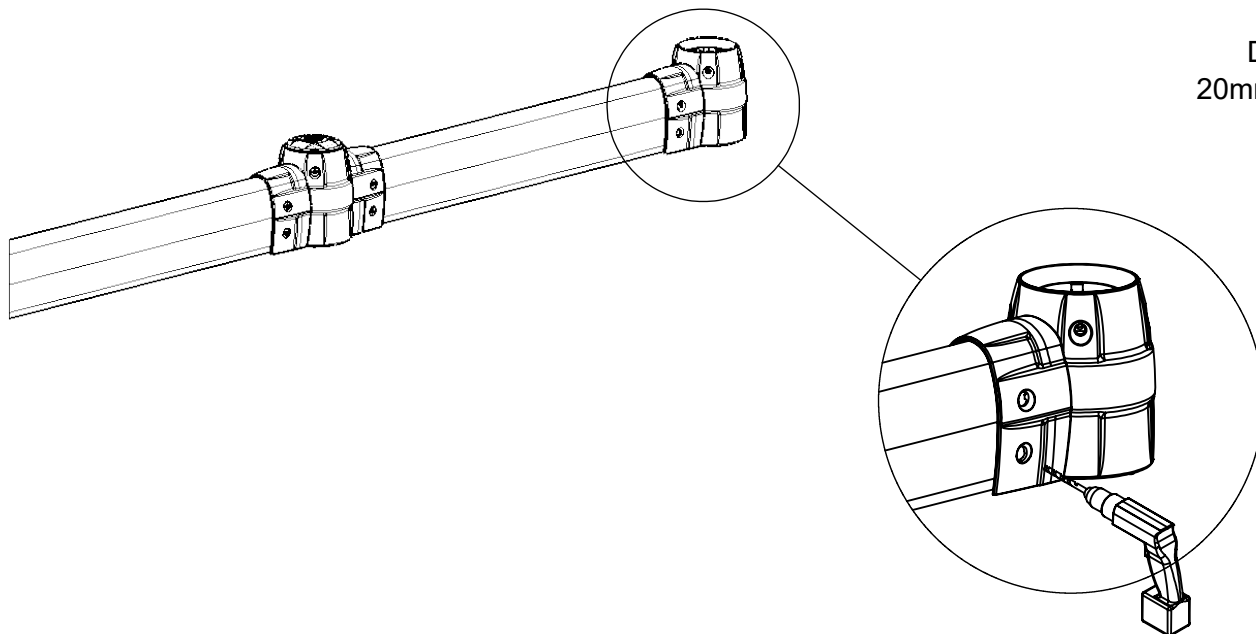

Step A8



FLX-CAP-GG

FGG-C-P

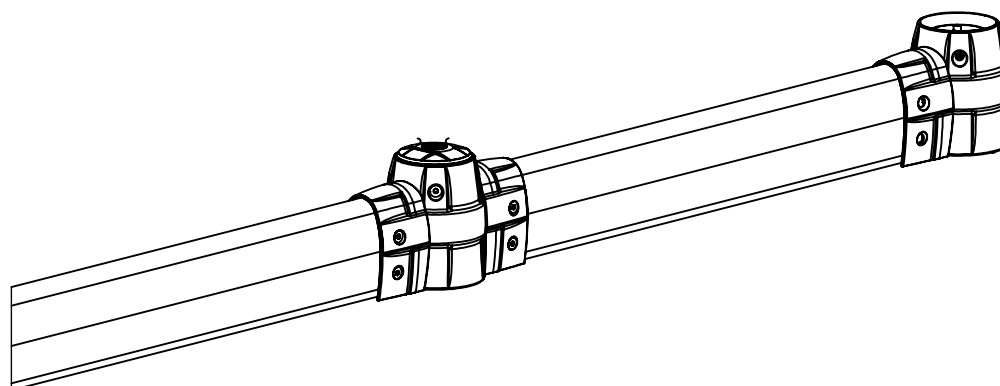

Step A7

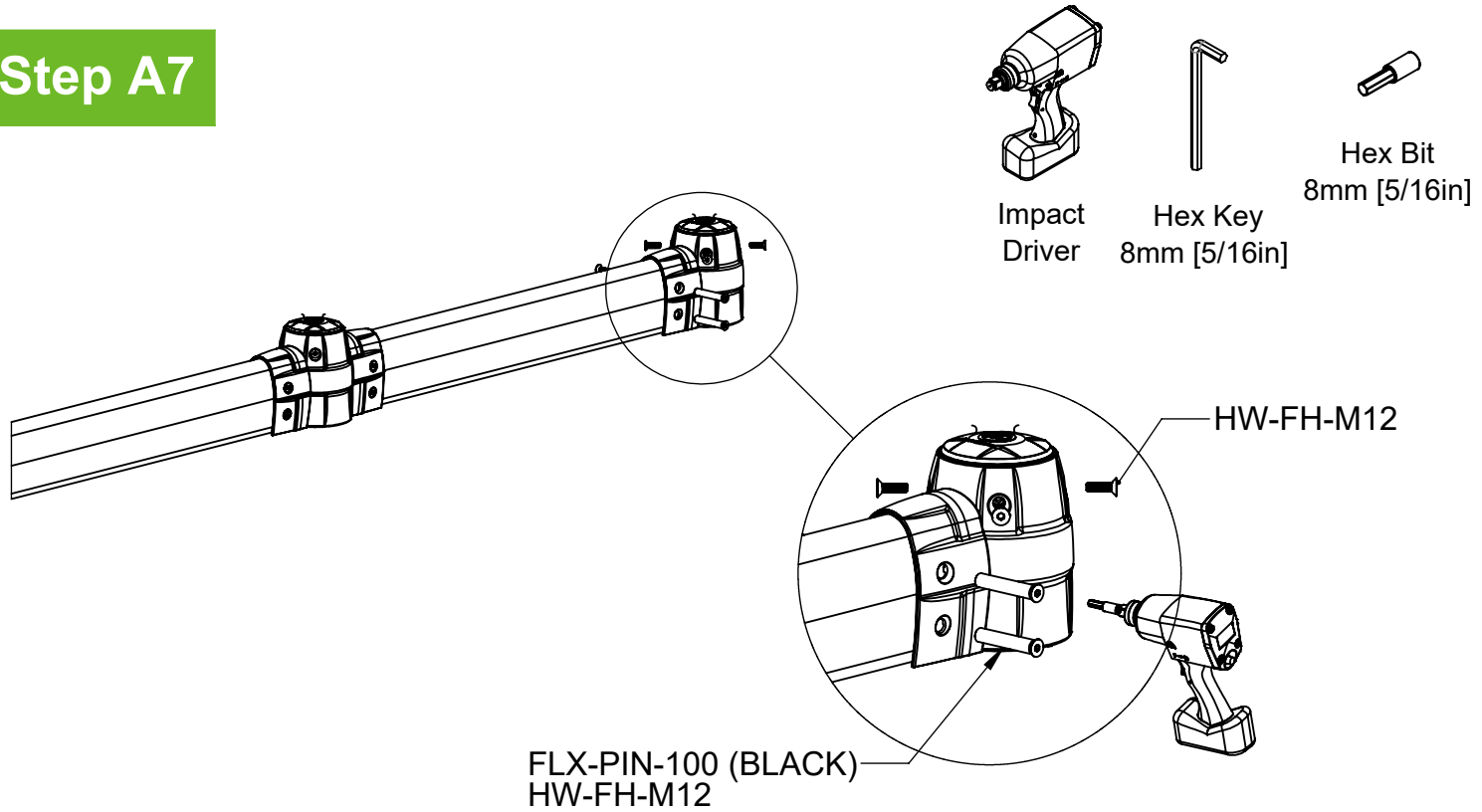

Installation Complete

