

FLEX+ Pedestrian Guard

Installation Instructions

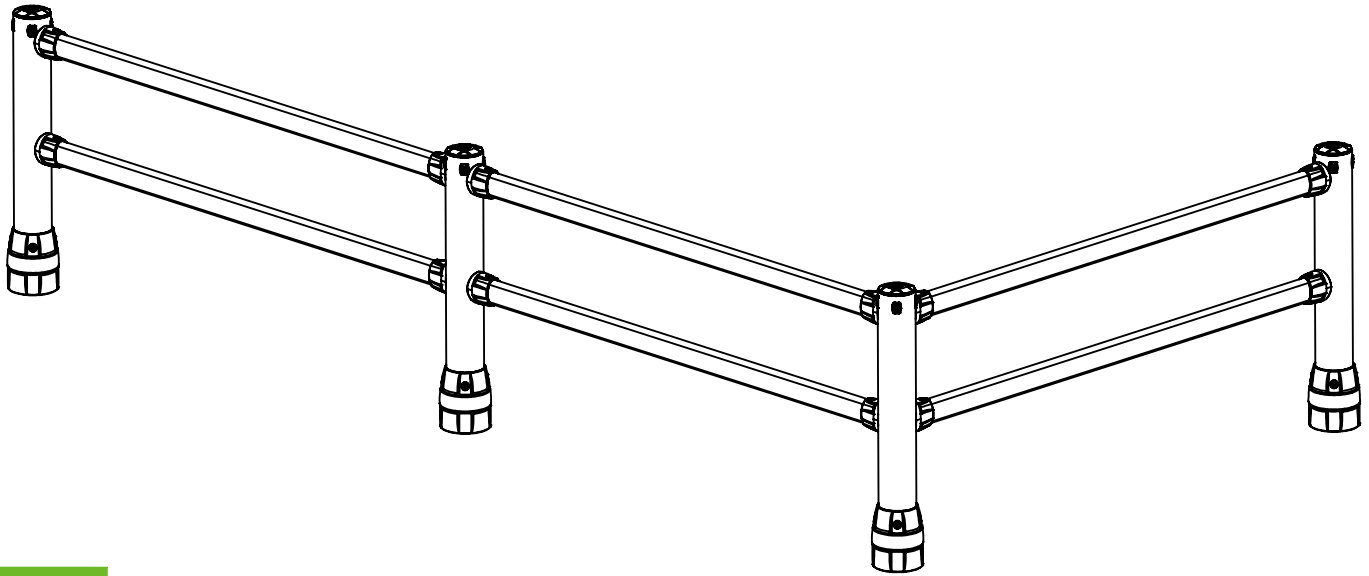

Kits

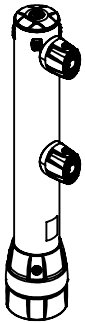

FPG-K-END
Pedestrian Guard
End Post

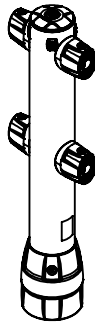

FPG-K-MID
Pedestrian Guard
Mid Post

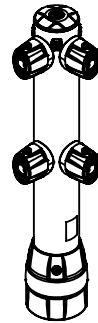

FPG-K-CNR
Pedestrian Guard
Corner Post

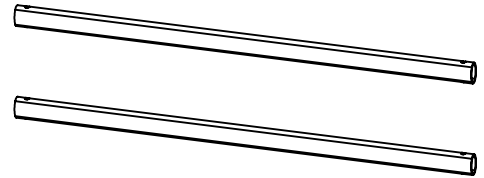

FPG-K-R-8
Pedestrian Guard
Rail Kit



McCue Corporation
Danvers, Massachusetts, USA
+1(800) 800 8503
cservices@mccue.com

McCue UK
Milton Keynes, United Kingdom
+44 (0)1908 365 511
uksales@mccue.com

McCue Asia
Xiamen, Fujian, China
+8 592 2200790
rchen@mccue.com

McCue Europe
Magirus-Deutz-Straße 14
89077 Ulm, Germany
+49 731 40 38 82 68
eusales@mccue.com

mccue.com



Components

PolyCore Base FLX-C-B-END

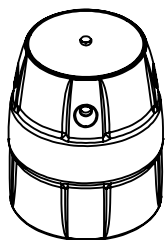

Base Cover
FLX-BCV
QTY: 1

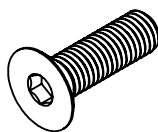

Flat Head Screw
HW-FH-M12
QTY: 4

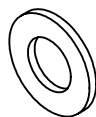

Anchor Washer
HW-WSH-ANC
QTY: 4



Damper
HW-DPR
QTY: 4

Base Core FLX-COR

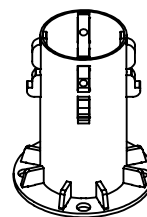

Base Core
FLX-COR
QTY: 1

Cap FLX-C-CAP

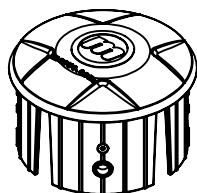

Cap
FLX-CAP
QTY: 1



Post Washer
FLX-WSH
QTY: 4

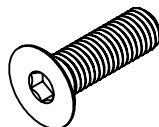

Flat Head Screw
HW-FH-M12
QTY: 4

Top Rail Connector FLX-C-TRC

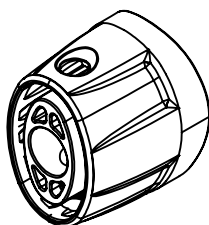

Top Rail Connector
FLX-TRC
QTY: 1

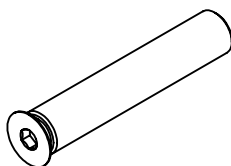

100mm Pin (Black)
FLX-PIN-100
QTY: 1

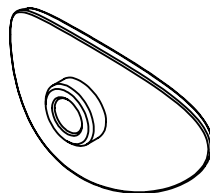

FastFit Insert
FLX-INS
QTY: 1

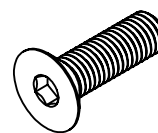

Flat Head Screw
HW-FH-M12
QTY: 1

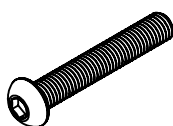

Button Head Screw
HW-BH-M12
QTY: 1



Connector Washer
HW-WSH-M12
QTY: 1



Damper
HW-DPR
QTY: 1

Concrete Anchor (Imperial or Metric) HW-C-A1250 or HW-C-AM12-130

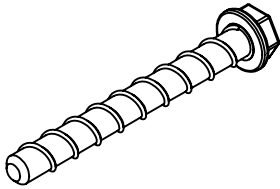

Concrete Anchor
HW-C-A1250 or
HW-C-AM12-130

Ground Guard Rail FGG-C-R-8

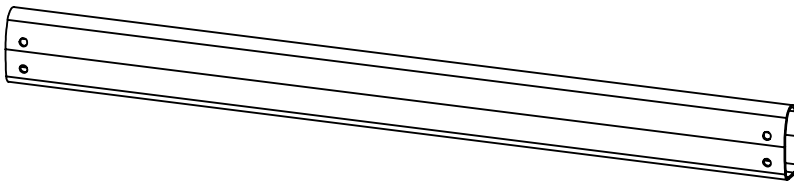

Ground Guard Rail
FGG-C-R-8

Top Rail FTR-C-R-8

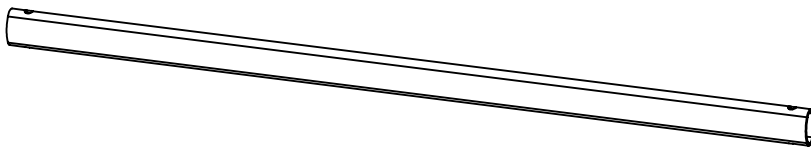

Top Rail
FTR-C-R-8

Post FPG-C-P-XXX

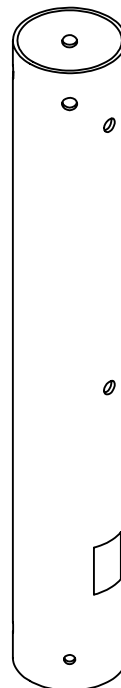

FPG-C-P-END
FPG-C-P-MID
FPG-C-P-CNR
Post

Required Tools

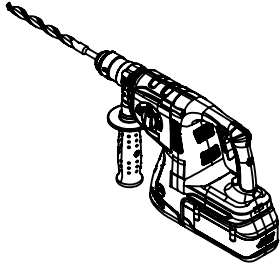

Hammer Drill With
Ø 12mm or Ø 1/2in
Masonry Bit

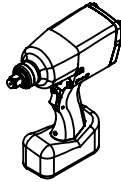

Impact
Driver



Vacuum

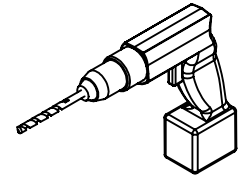

Drill with
Ø 20mm [3/4in] Bit

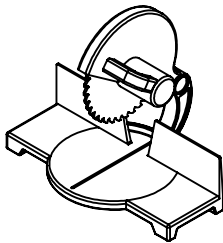

Mitre Saw



Hex Key
8mm [5/16in]

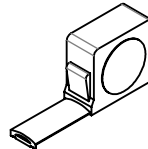

Measuring Tape

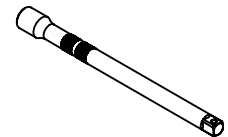

Socket Extender

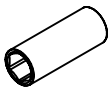

Hex Socket
17mm [3/4in]

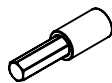

Hex Bit
8mm [5/16in]



Chalk Line

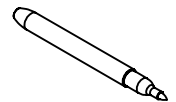

Marker



PPE recommended: High Visibilty Vest, Steel Toe Boots, Work Gloves, Ear Protection, Dust Mask, Eye Protection.

Step 1

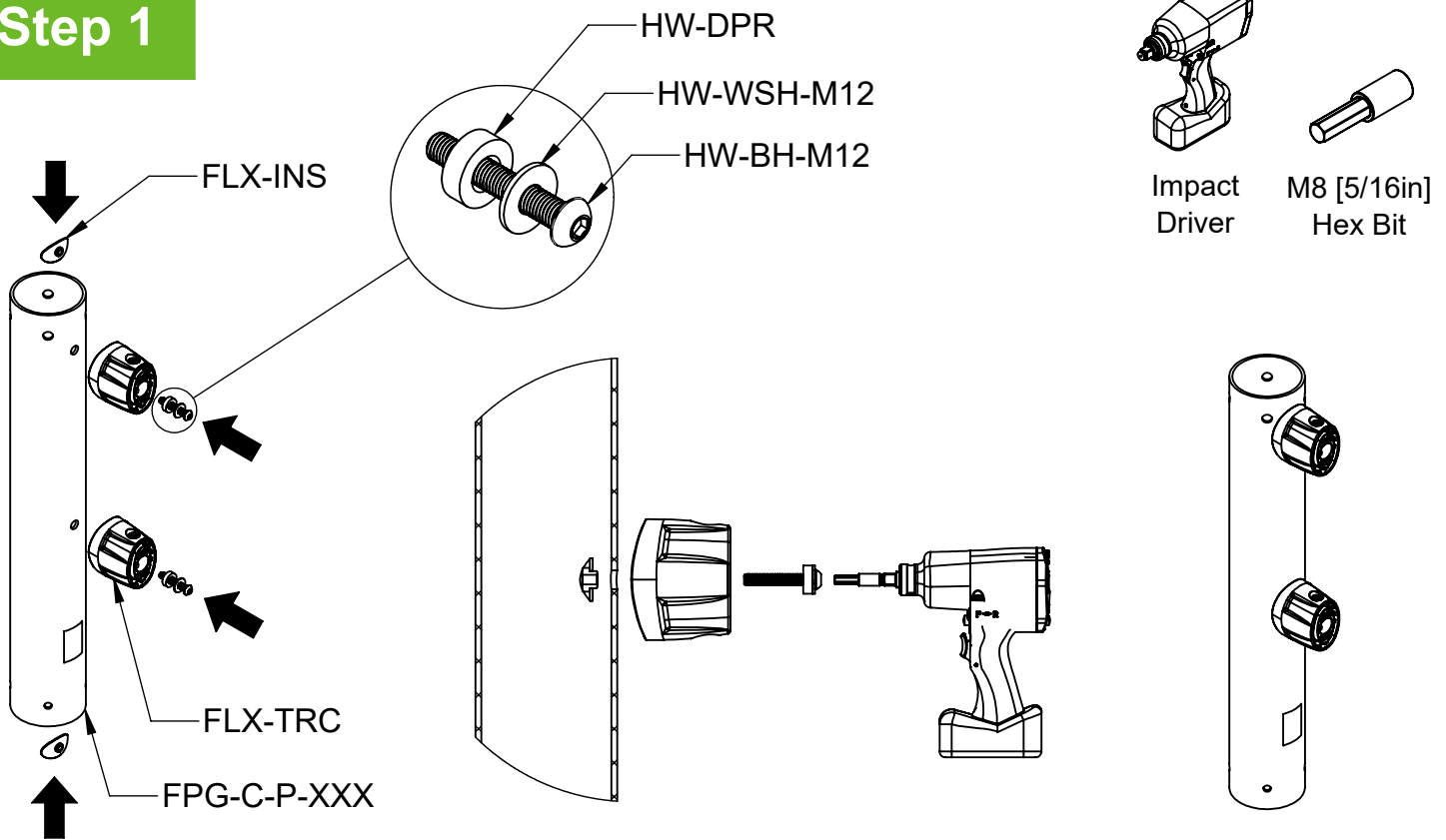

REPEAT FOR ALL POSTS

Step 2

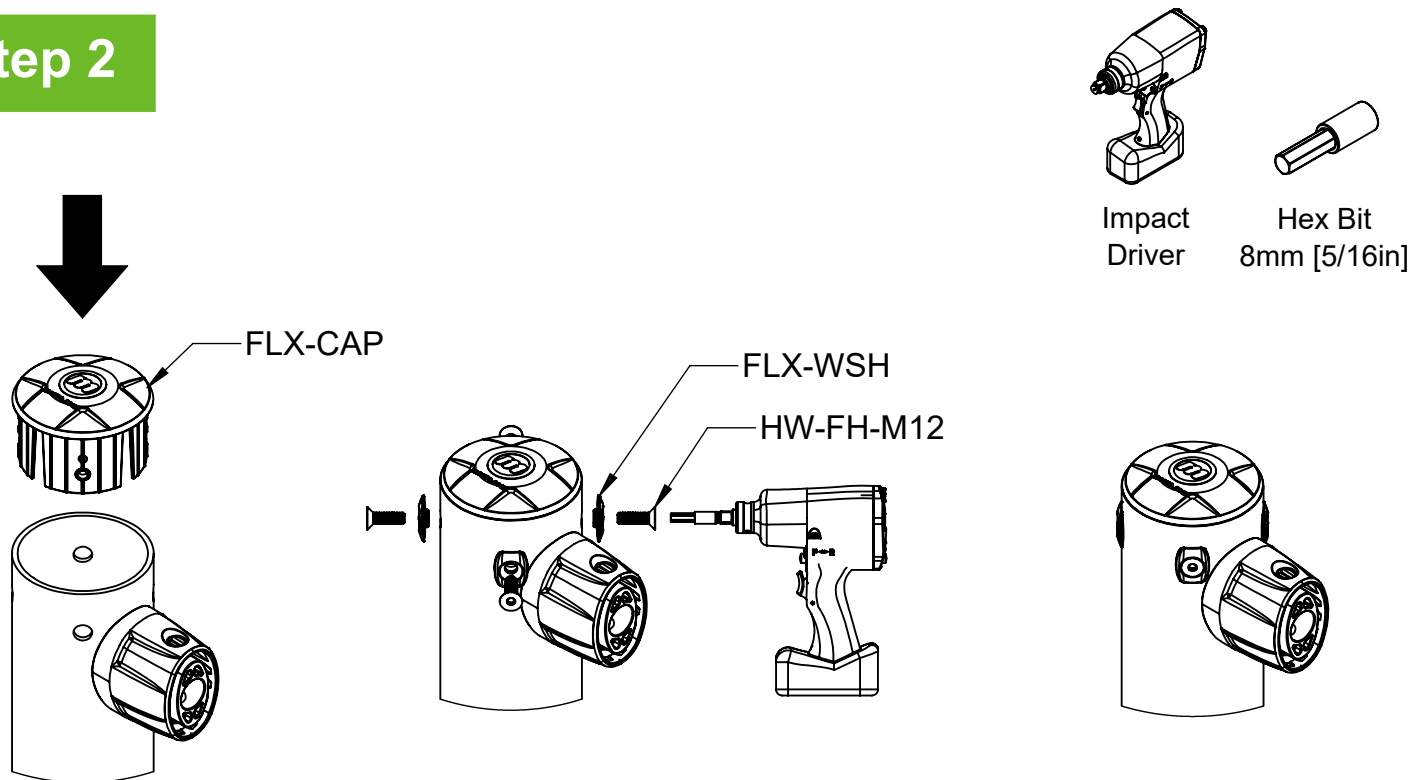

REPEAT FOR ALL POSTS

Step 3

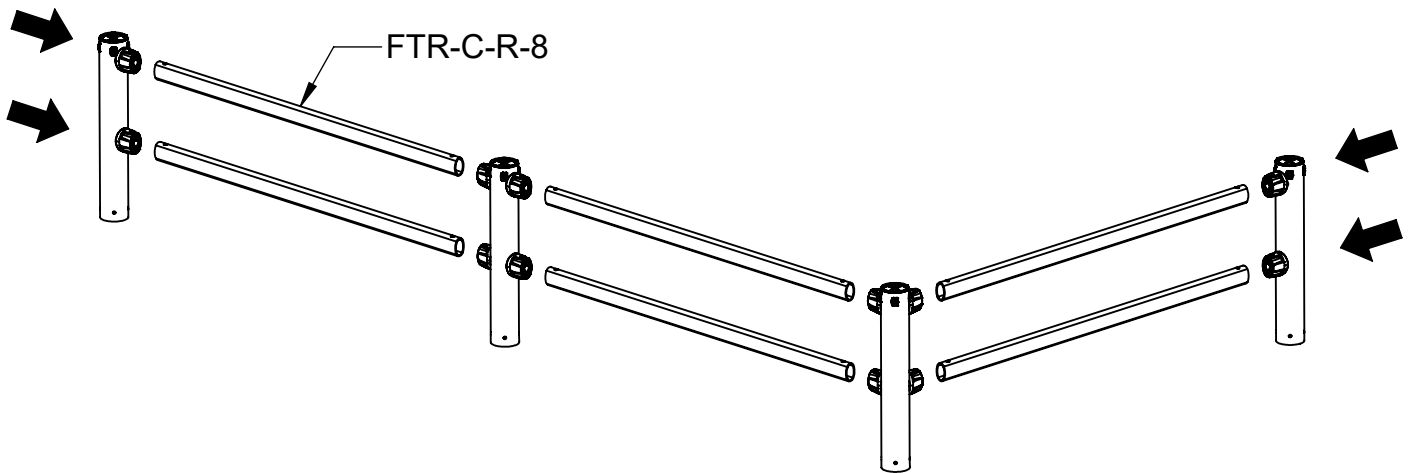

Step 4

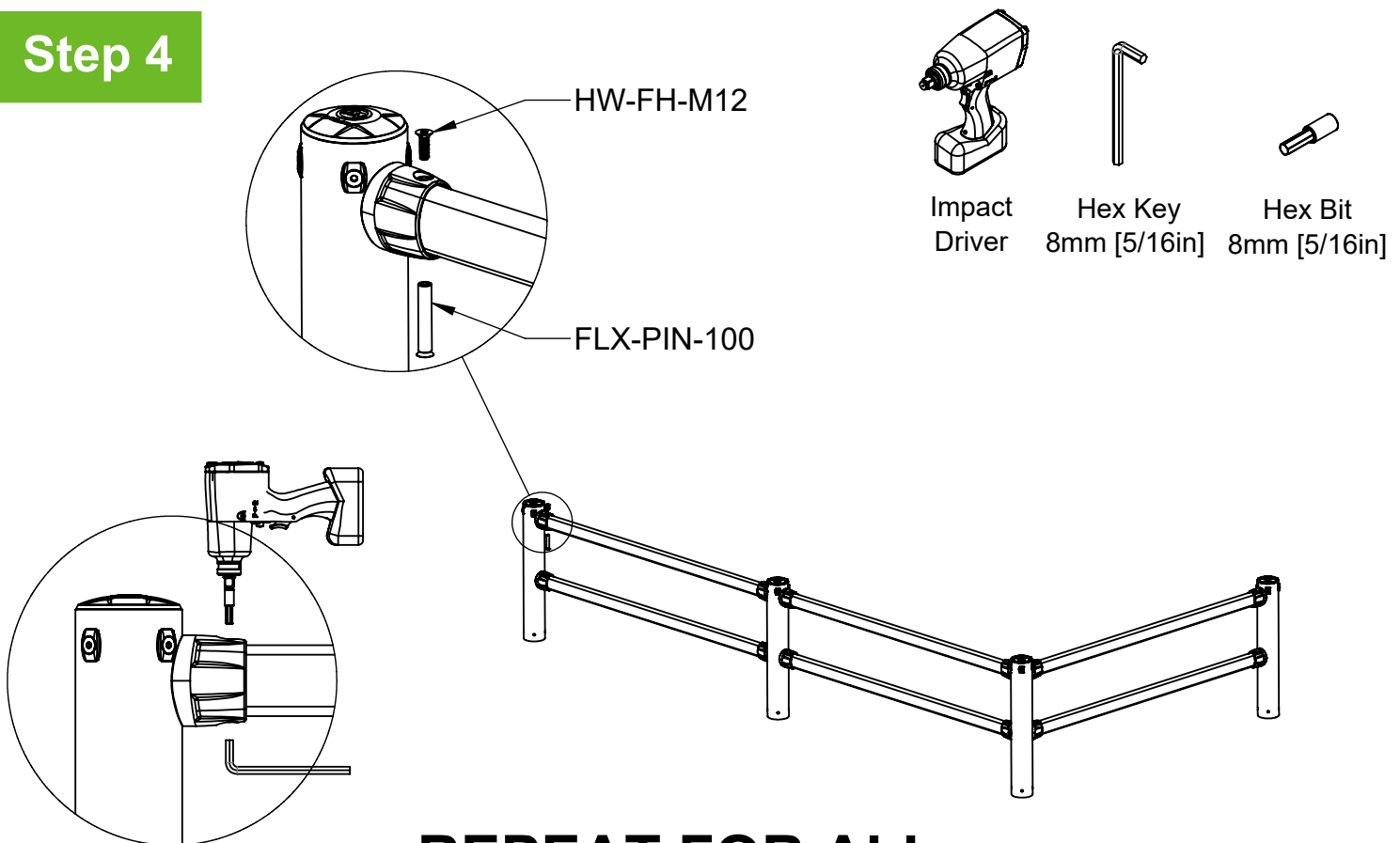

**REPEAT FOR ALL
RAIL CONNECTORS**

Step 5

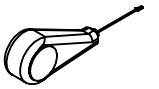

Chalk Line

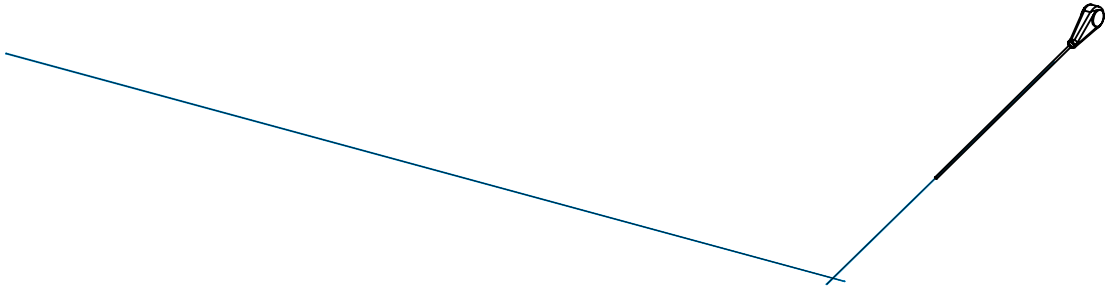

Step 6

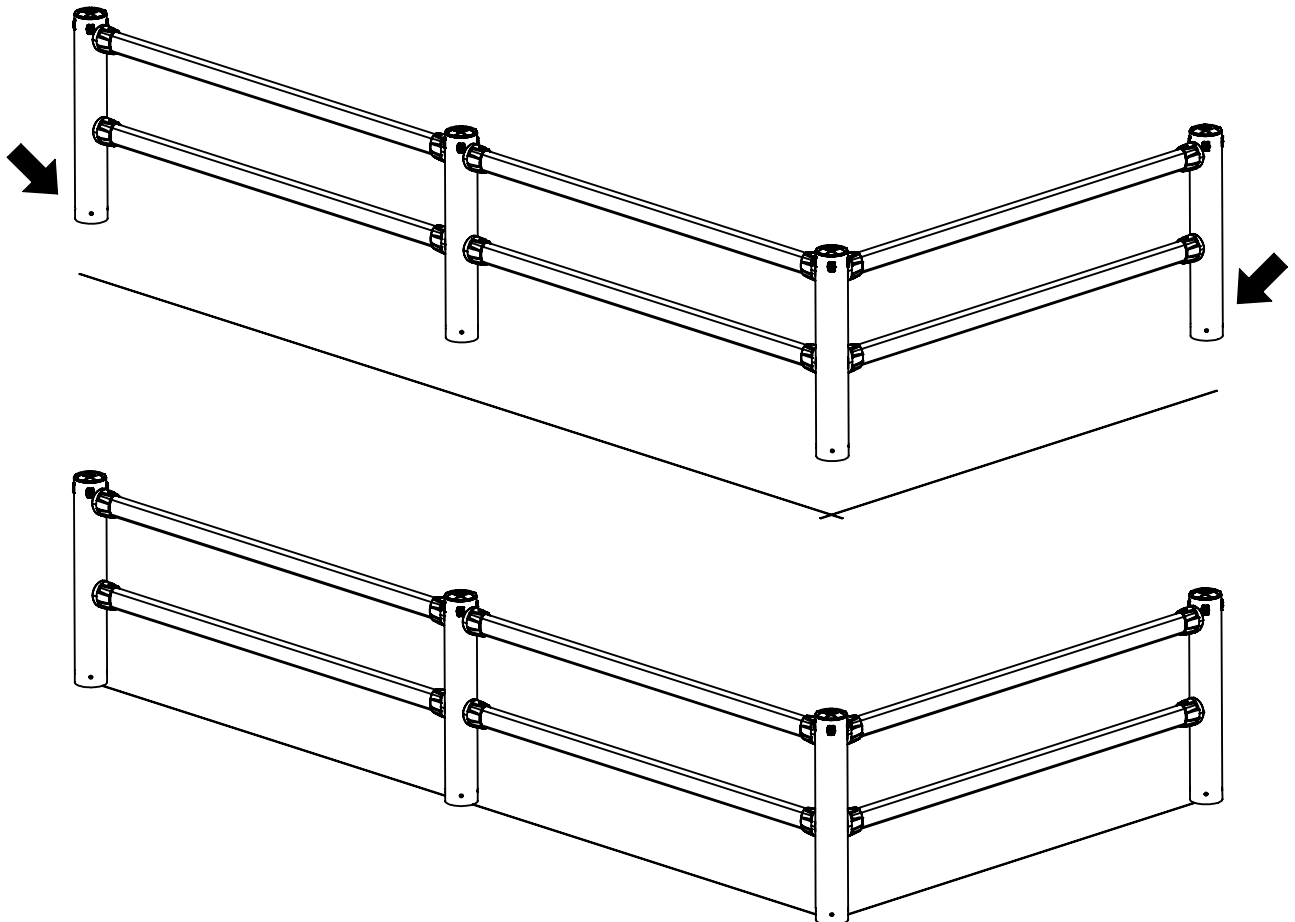

Step 7

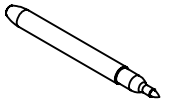

Marker

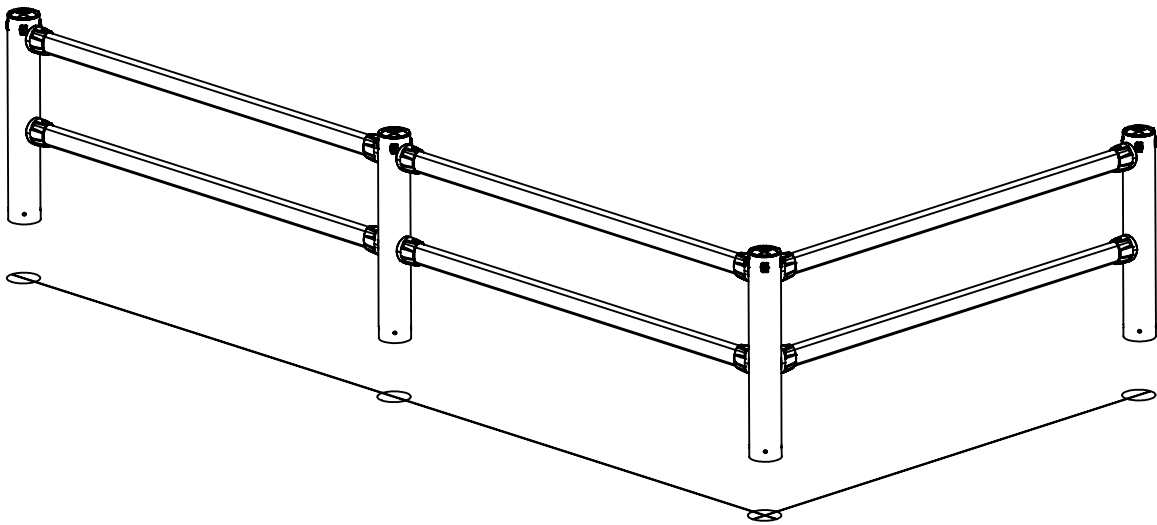
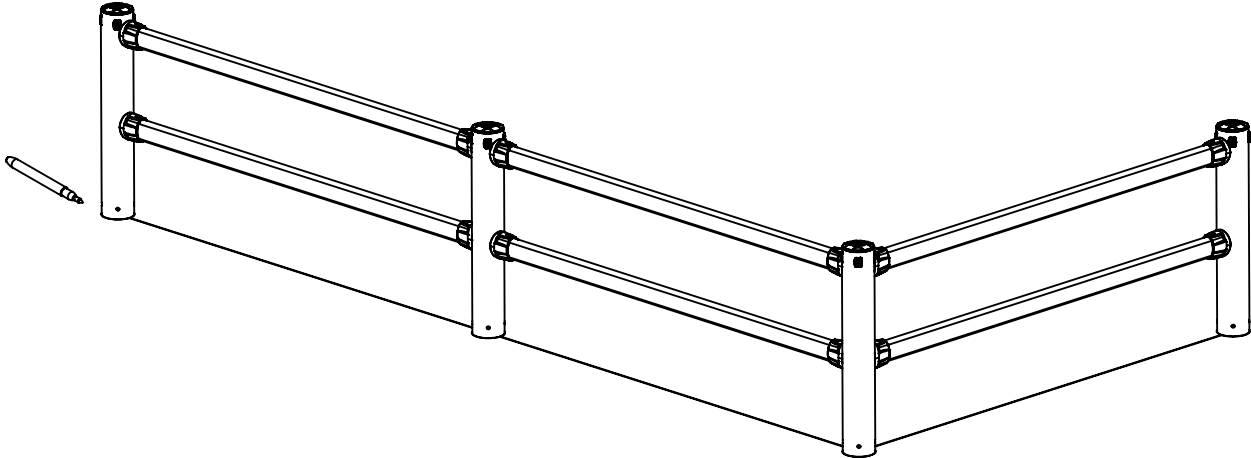

Step 8

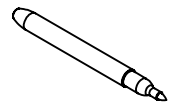

Marker

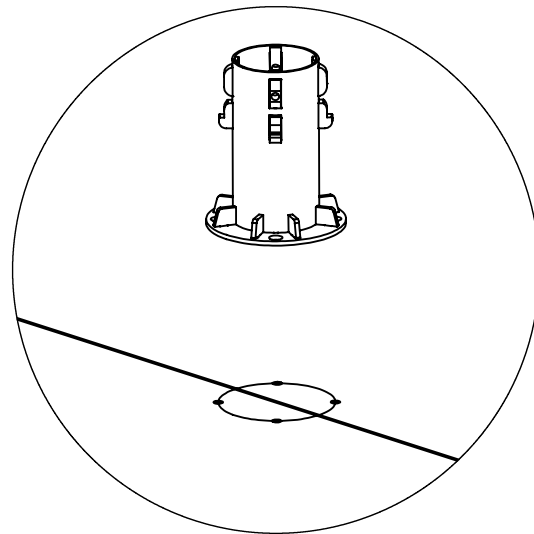
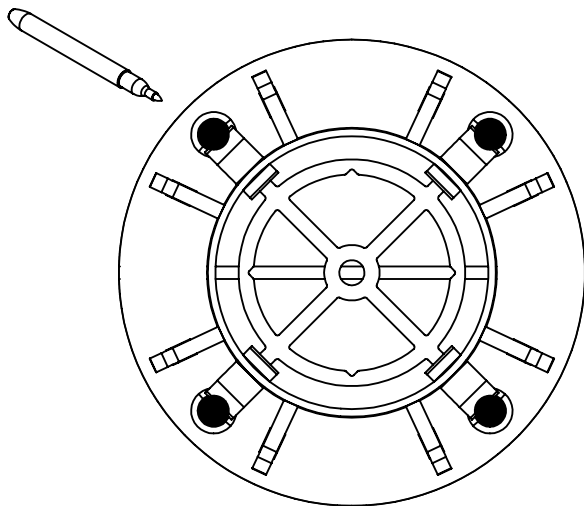
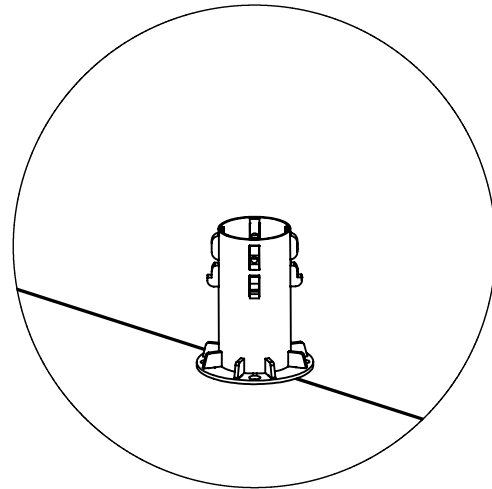
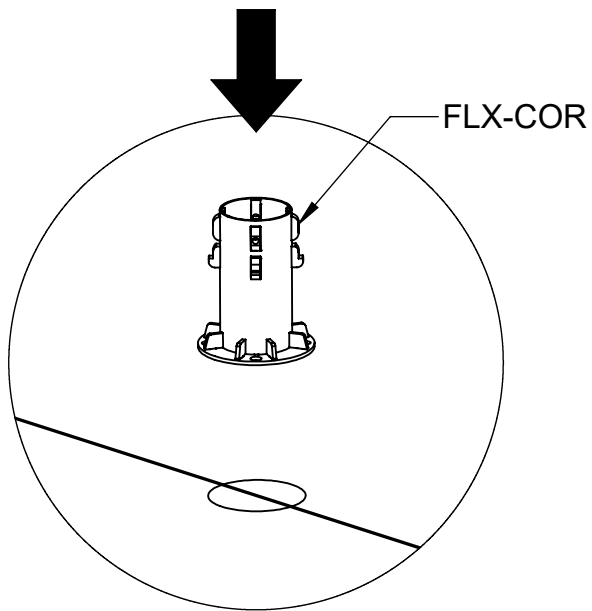

REPEAT FOR ALL BASE CORES

Step 9

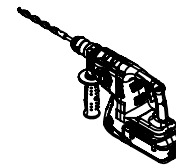
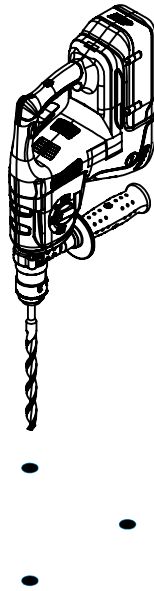

Hammer Drill With
 \varnothing 12mm or \varnothing 1/2in
 Masonry Bit



Vacuum

HOLE DETAIL
 IMPERIAL
 HW-C-A1250

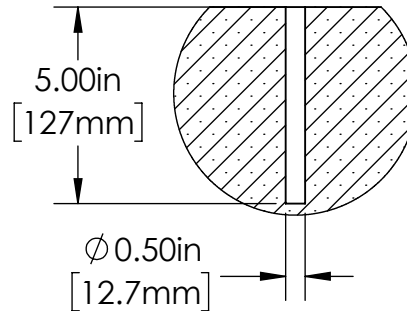

HOLE DETAIL
 METRIC
 HW-C-AM12-130

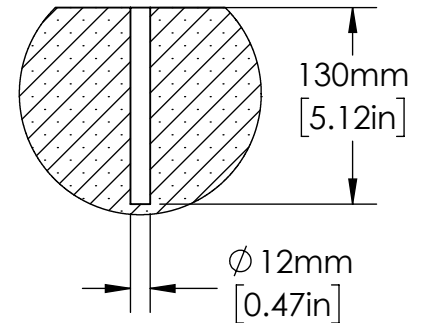

- PPE recommended: High Visibility Vest, Steel Toe Boots, Work Gloves, Ear Protection, Dust Mask, Eye Protection.
- Clean concrete dust by running the vacuum during drilling.

Step 10

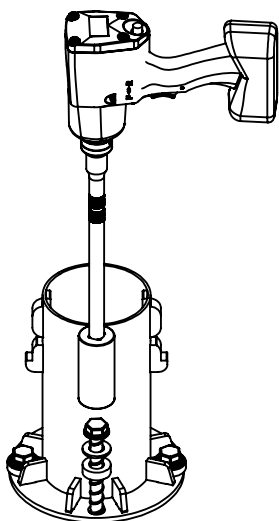

Impact
 Driver

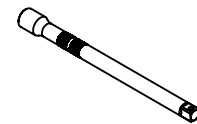

Extender



17mm or 3/4in
 Hex Socket

HW-C-A1250 or
 HW-C-AM12-130

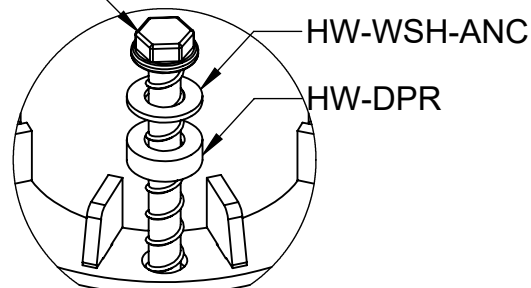

ANCHOR DETAIL

REPEAT FOR ALL BASE CORES

Step 11

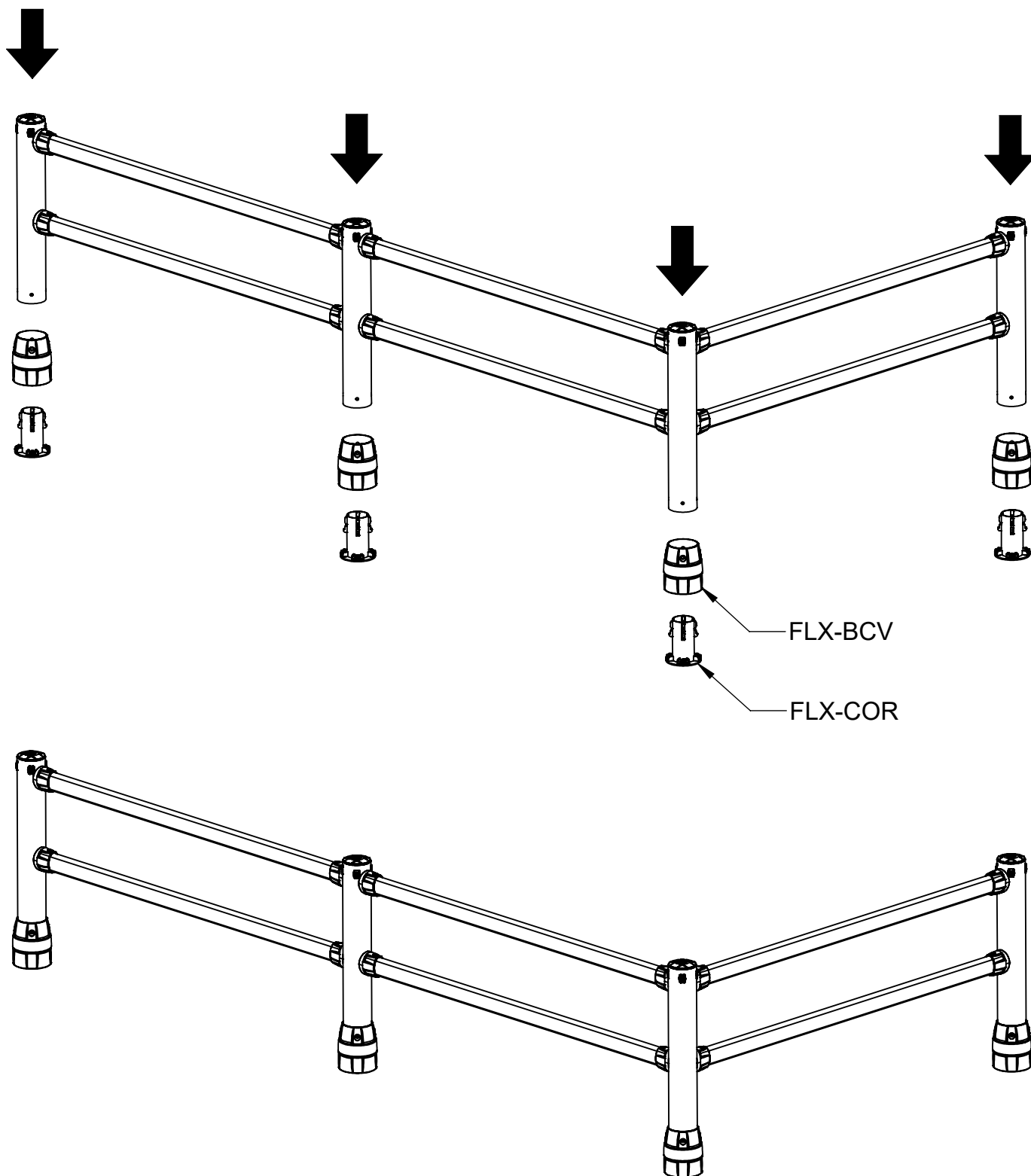

Step 12



Impact
Driver

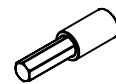

Hex Bit
8mm [5/16in]

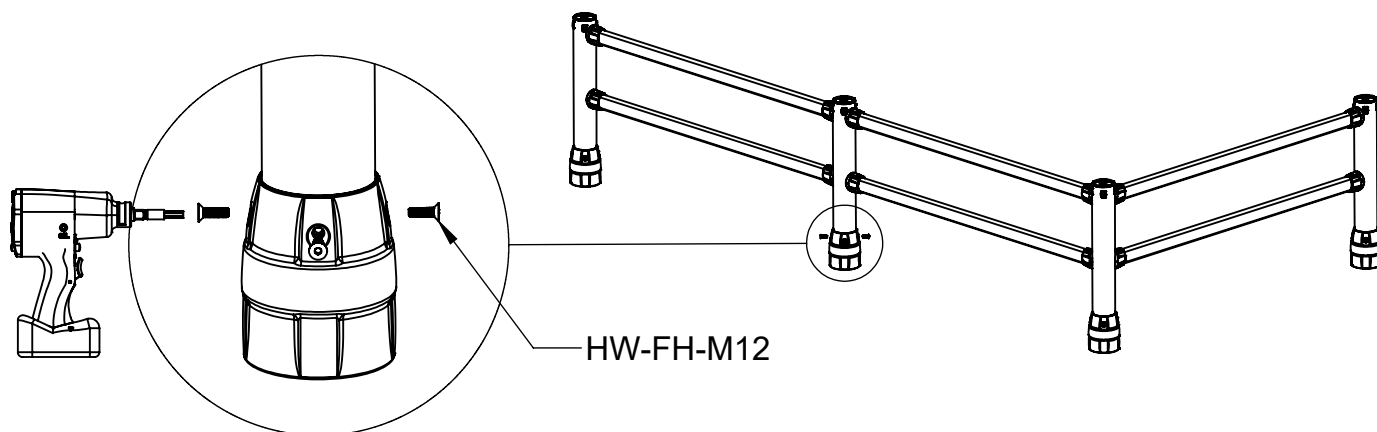

Installation Complete

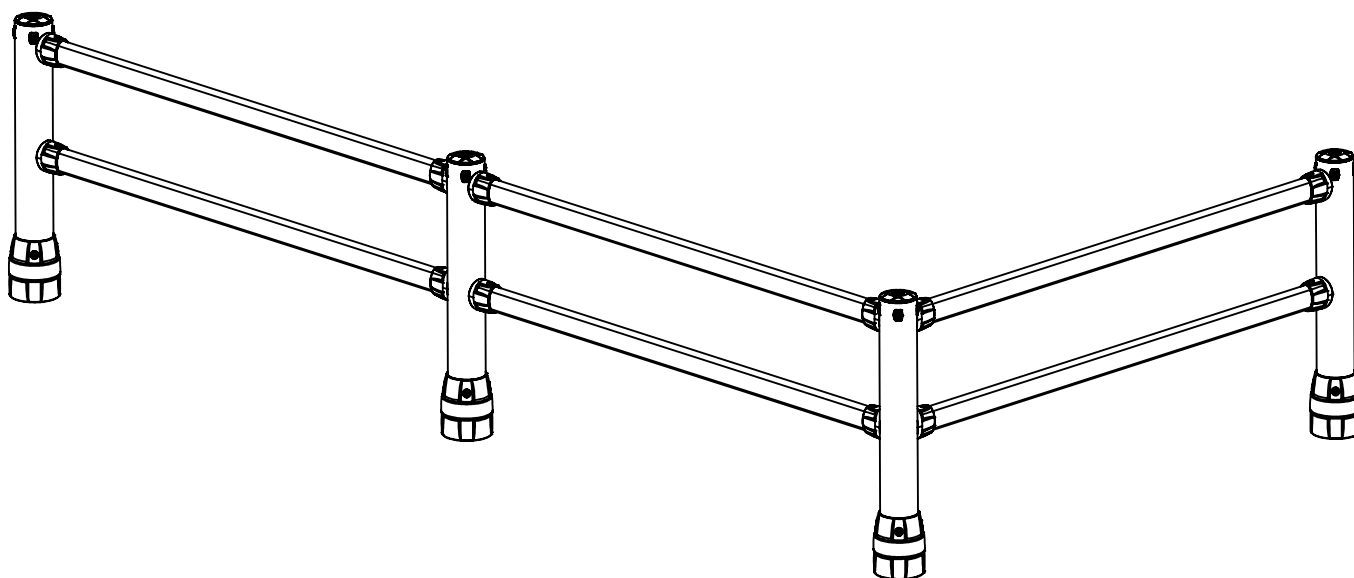

Appendix A: Custom Length Rails

Step A1

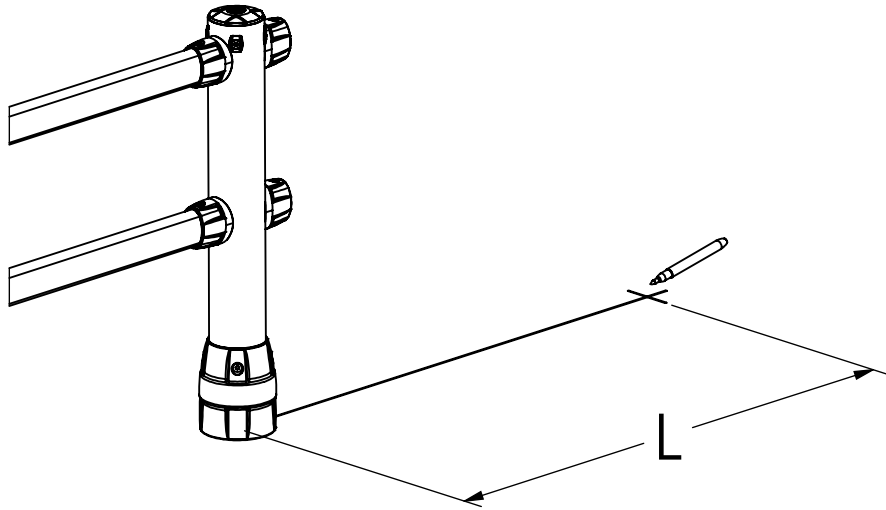
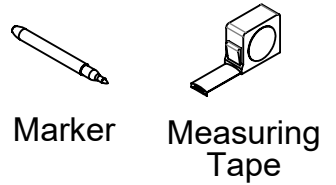

Step A2

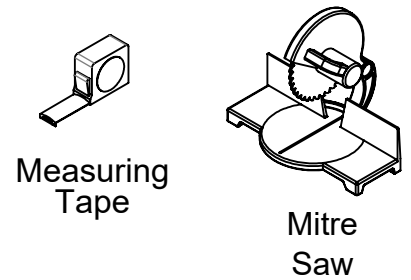

Top Rail FTR-C-R-8

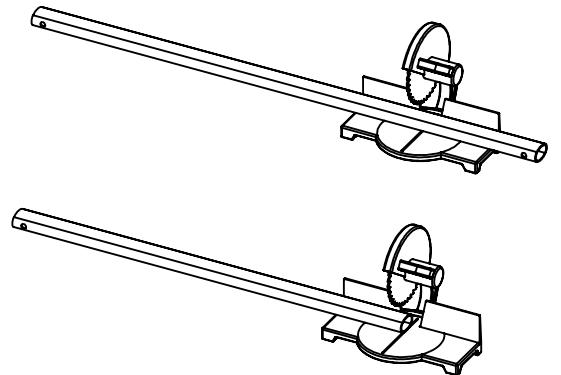
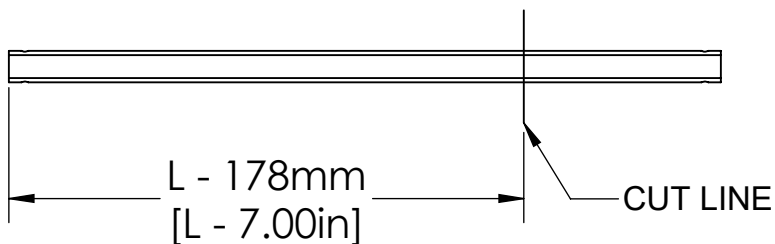

Step A3

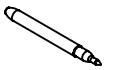

Marker

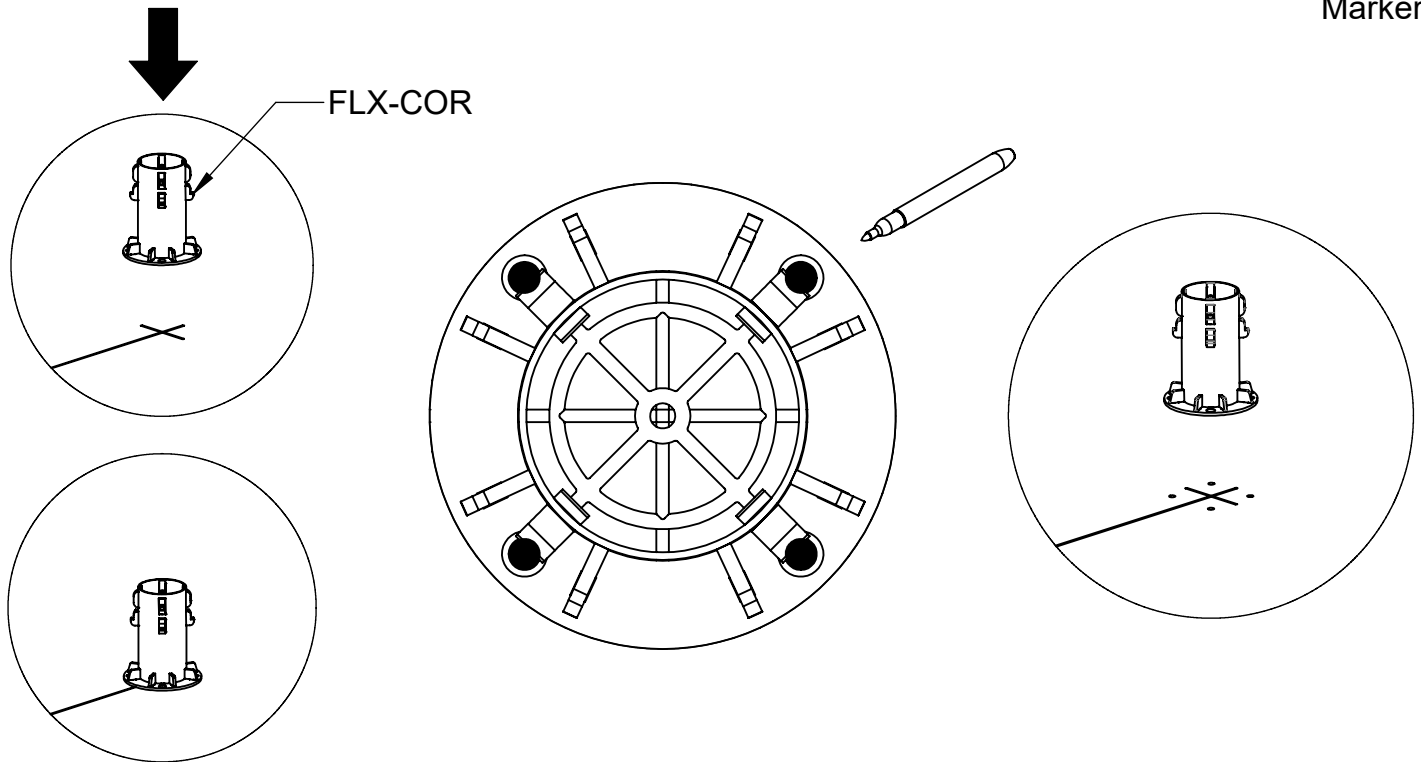

Step A4

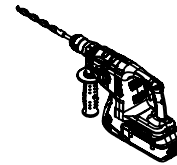

Hammer Drill With
 \varnothing 12mm OR \varnothing 1/2in
 Masonry Bit



Vacuum

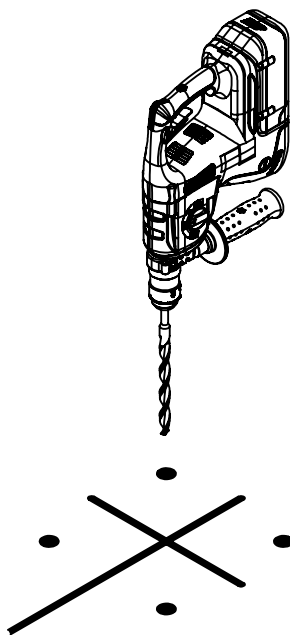

HOLE DETAIL
 IMPERIAL
 HW-C-A1250

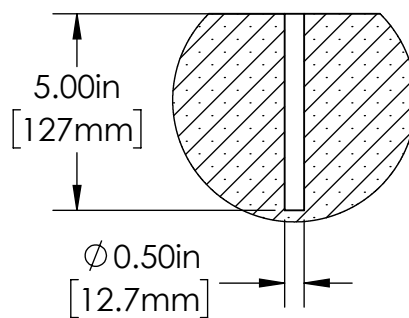

HOLE DETAIL
 METRIC
 HW-C-AM12-130

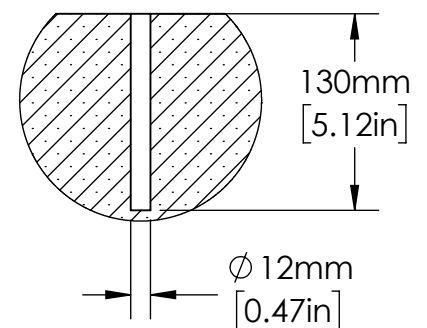

- PPE recommended: High Visibility Vest, Steel Toe Boots, Work Gloves, Ear Protection, Dust Mask, Eye Protection.
- Clean concrete dust by running the vacuum during drilling.

Step A5

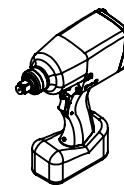

Impact
Driver

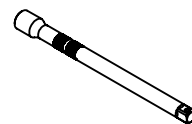

Extender



17mm or 3/4in
Hex Socket

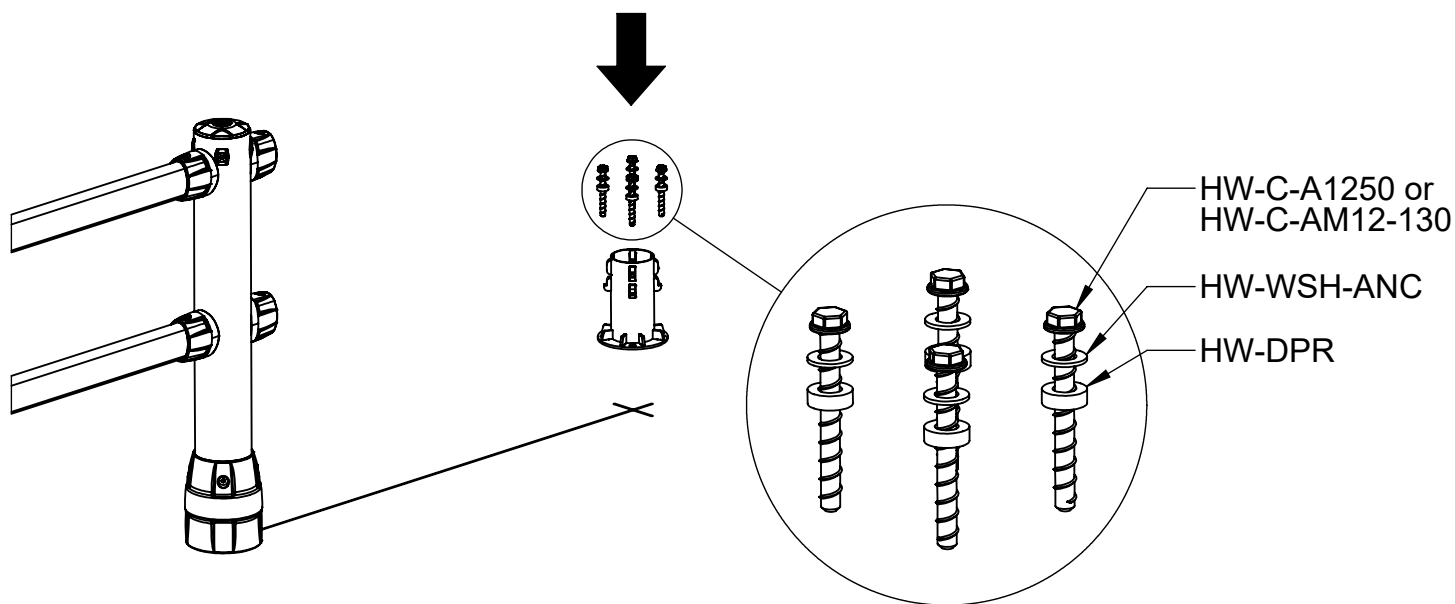

Step A6

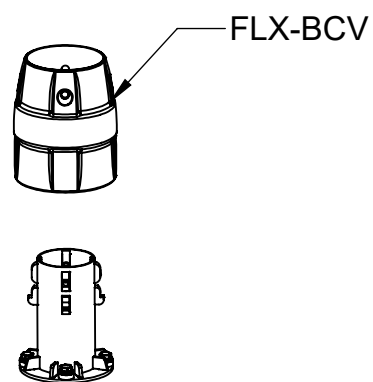
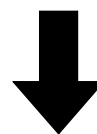
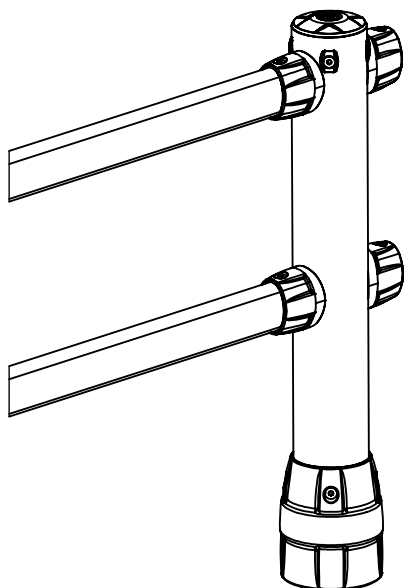

Step A5

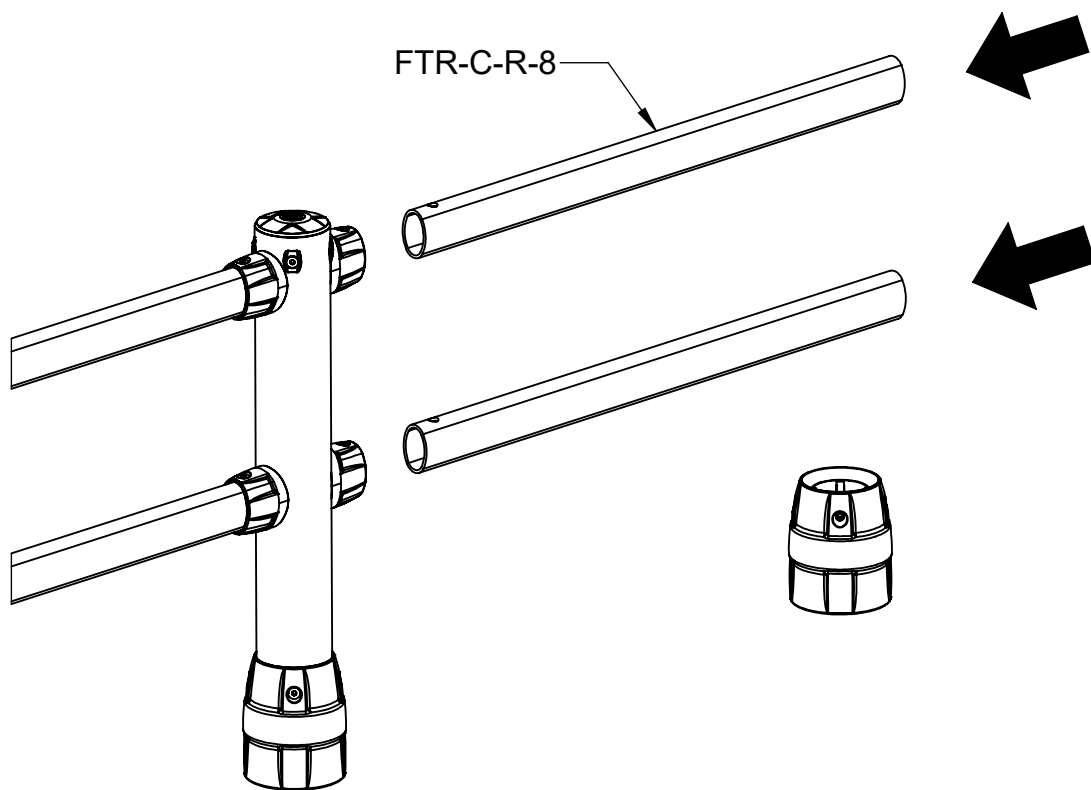

Step A6

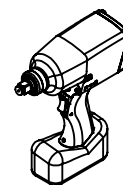
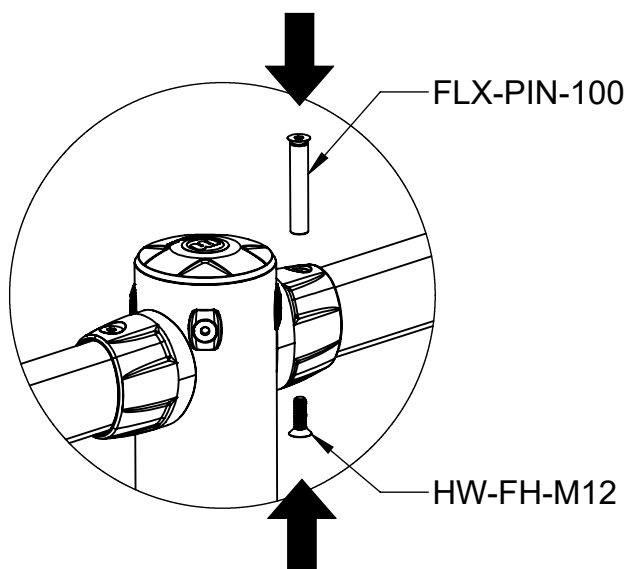

Impact
Driver



Hex Key
8mm [5/16in]



Hex Bit
8mm [5/16in]

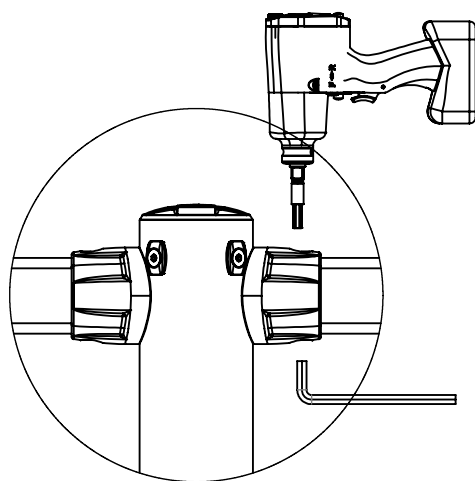

Step A7

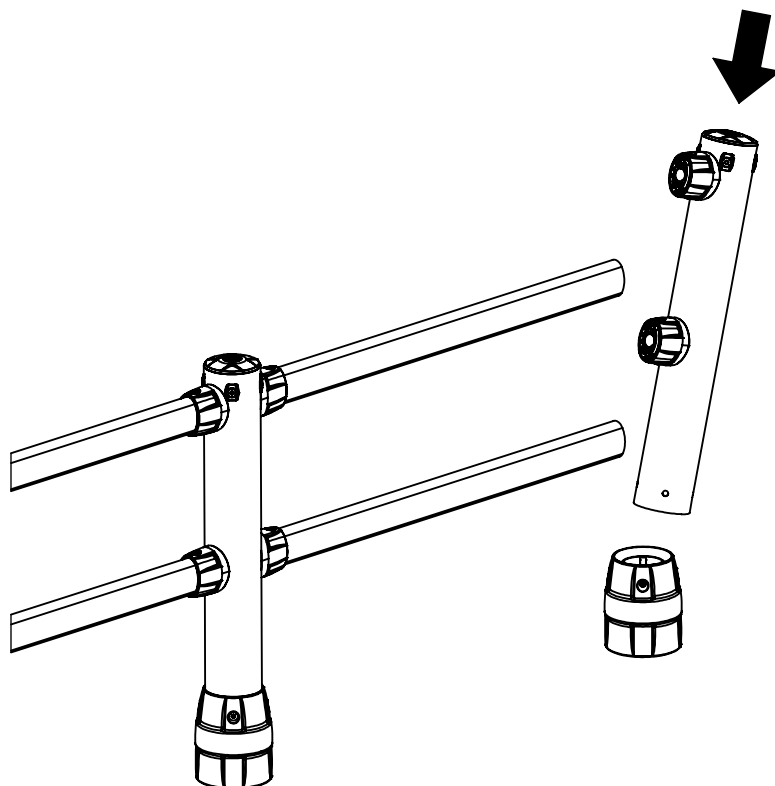

Step A8

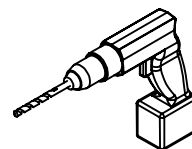
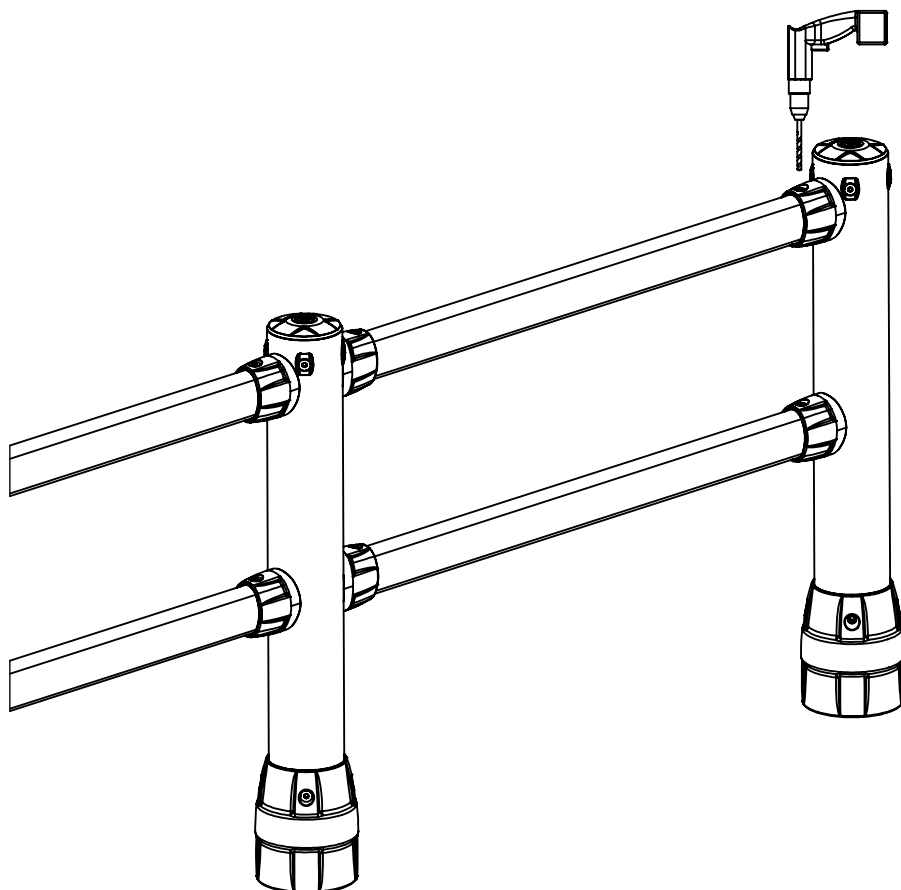

Drill with
20mm [3/4in] Bit

Step A9

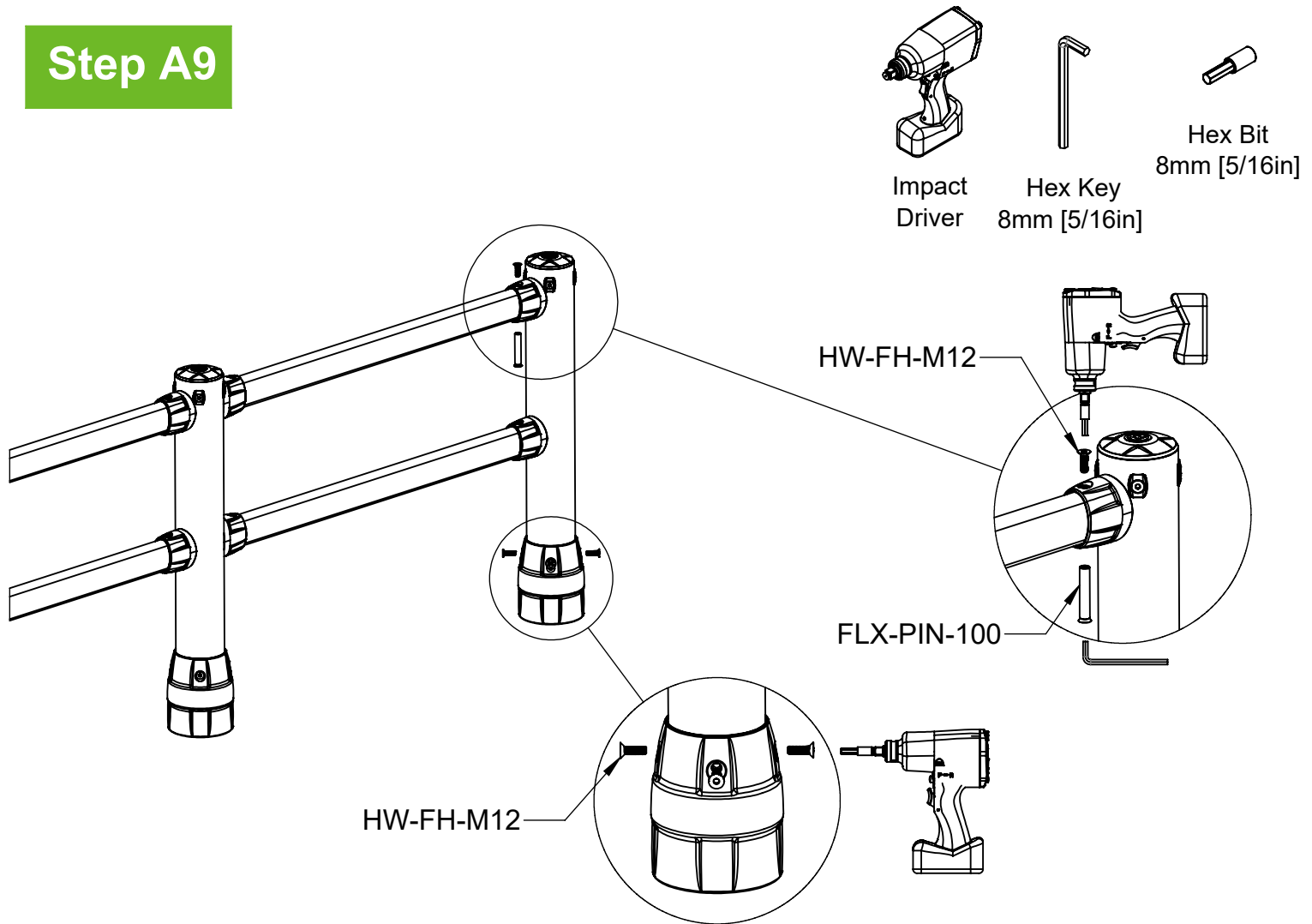

Installation Complete

