

SafeStop Goal Post

INSTALLATION INSTRUCTIONS

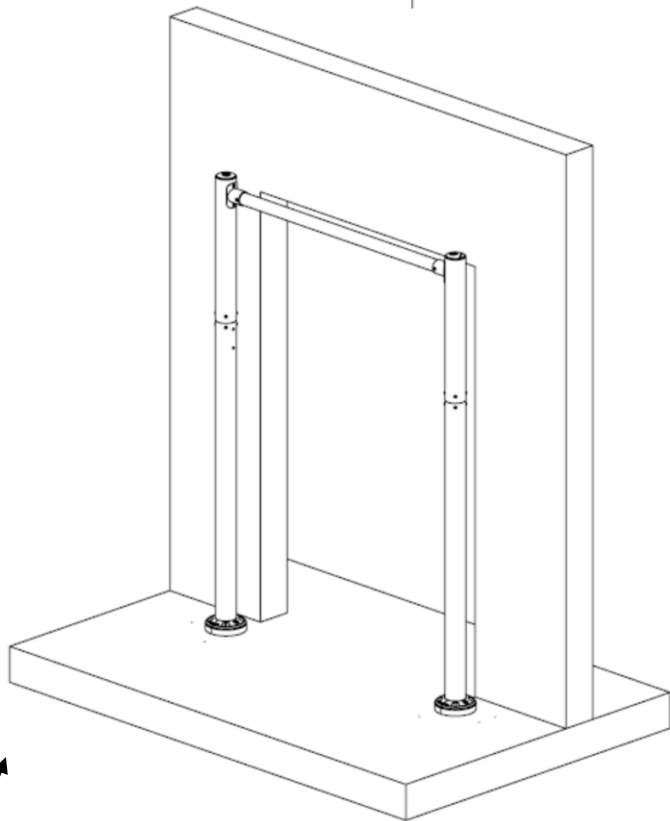

Components

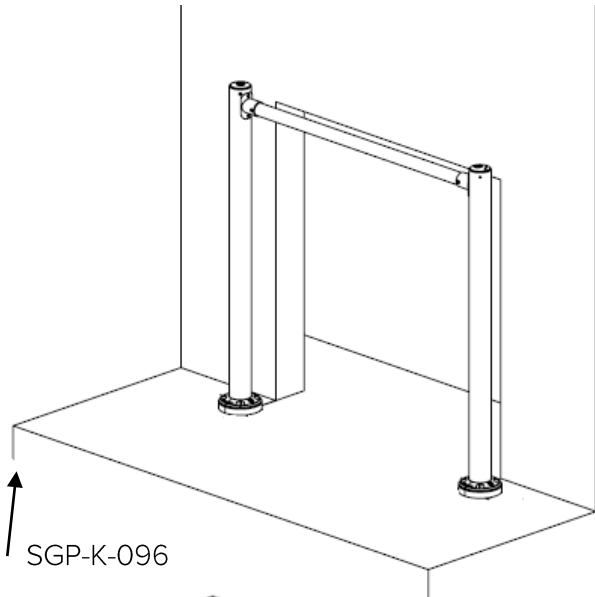
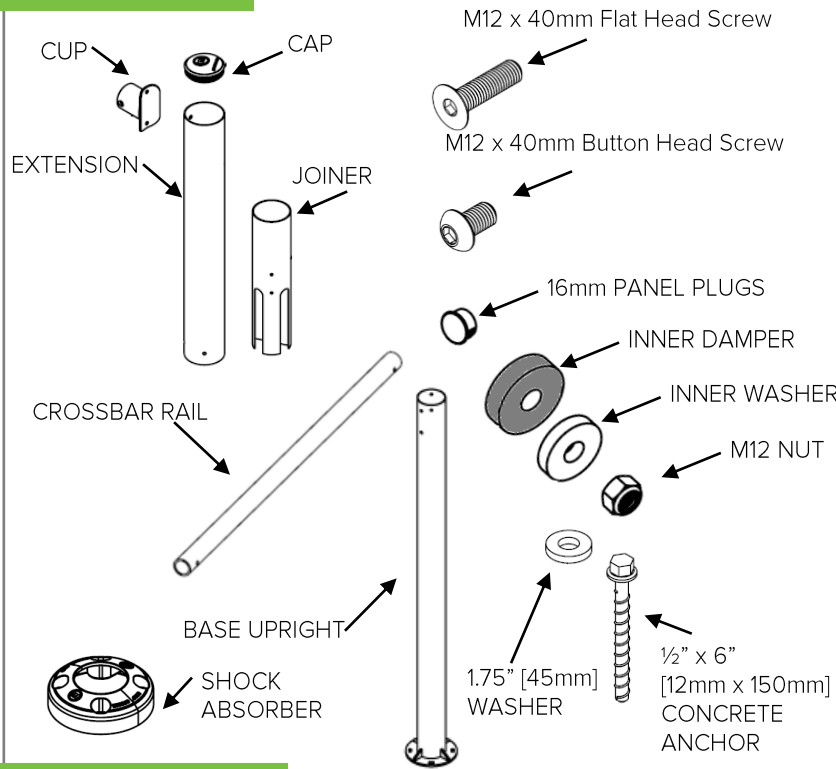

Required Tools

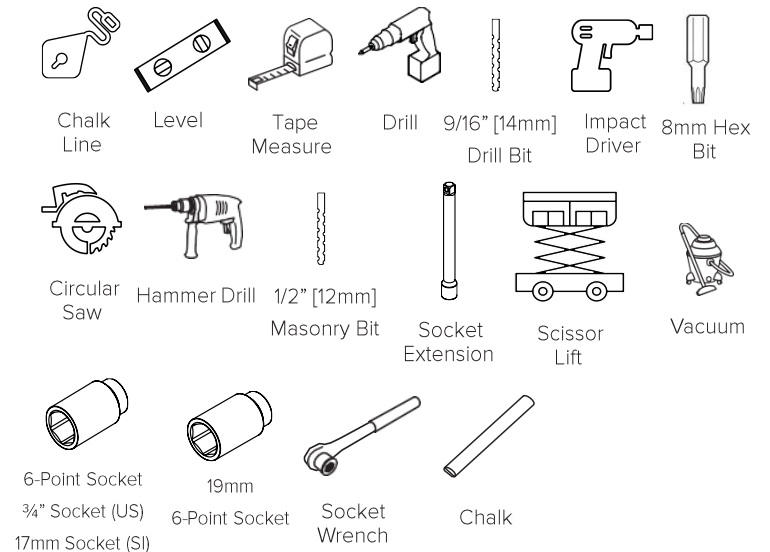

McCue Corporation
 Danvers, Massachusetts, USA
 +1 (800) 800 8503
 customercare@mccue.com

McCue UK & Europe
 Milton Keynes, United Kingdom
 +44 (0)1908 365 511
 uksales@mccue.com

McCue Asia
 迈客(厦门)有限公司
 Xiamen, Fujian, China
 +86-592-2200790

mccue.com

Step 1

SGP-K-120, 144, 168, 192
Remove cup, cap and plugs.
SGP-K-096
Skip to Step 6.

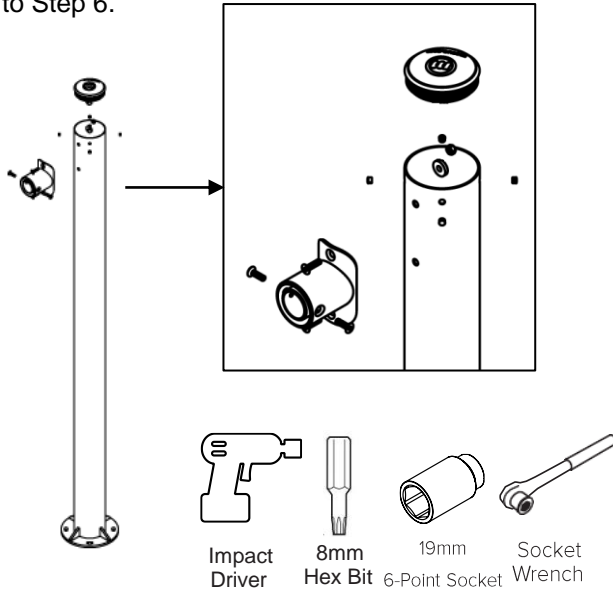

Step 2

SGP-K-120, 144, 168, 192
Insert joiner piece into base uprights.

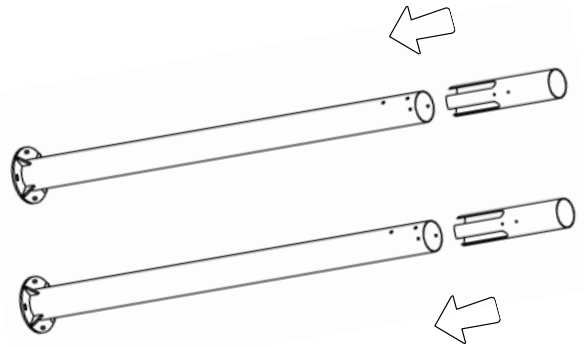

Step 3

SGP-K-120, 144, 168, 192
Fasten joiner to base uprights using QTY 4 x Button Head Screws per post through the lower set of holes in the joiner. There should be 4 joiner holes exposed above top of yellow post.
Insert plugs into two vertical holes.

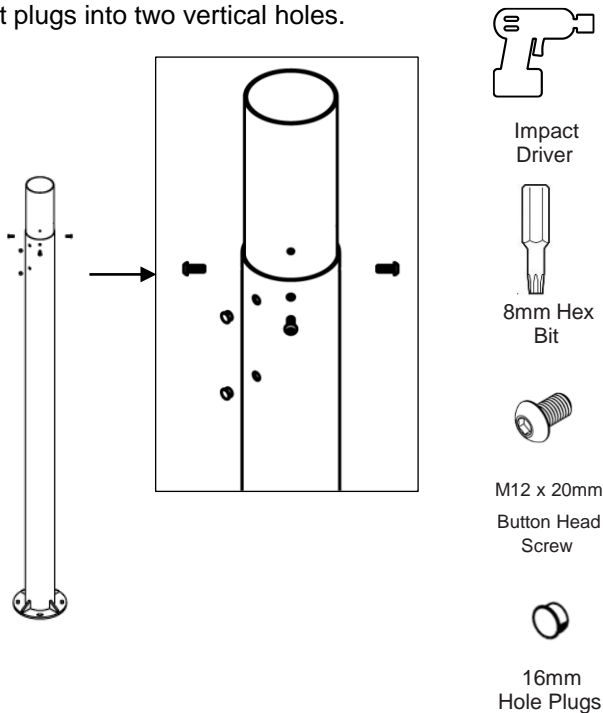

Step 4

SGP-K-120, 144, 168, 192
Reinstall cup on extension with QTY 2 X Washers, Dampers and M12 Nut inside the tube as shown below.

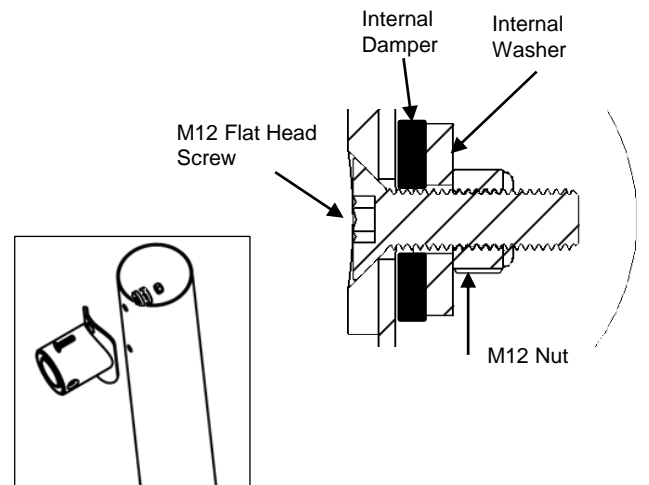
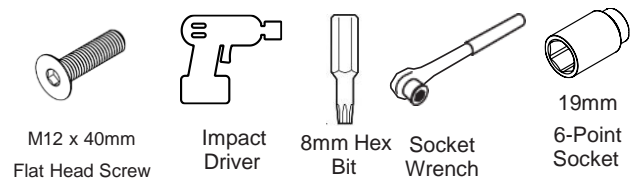

Step 5

SGP-K-120, 144, 168, 192
Reinstall cap.

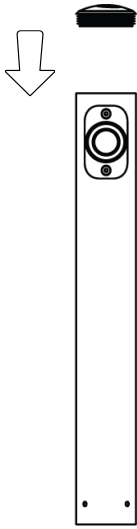

Step 6

All Sizes
Install shock absorbers on uprights.

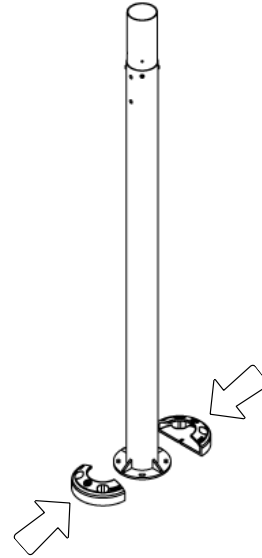

Step 7

All Sizes

Mark chalk lines tangent with door and along centerline. 24" to centerline is recommended but all installs are site dependent.

Check that posts are straight and level.

Mark holes through baseplate.

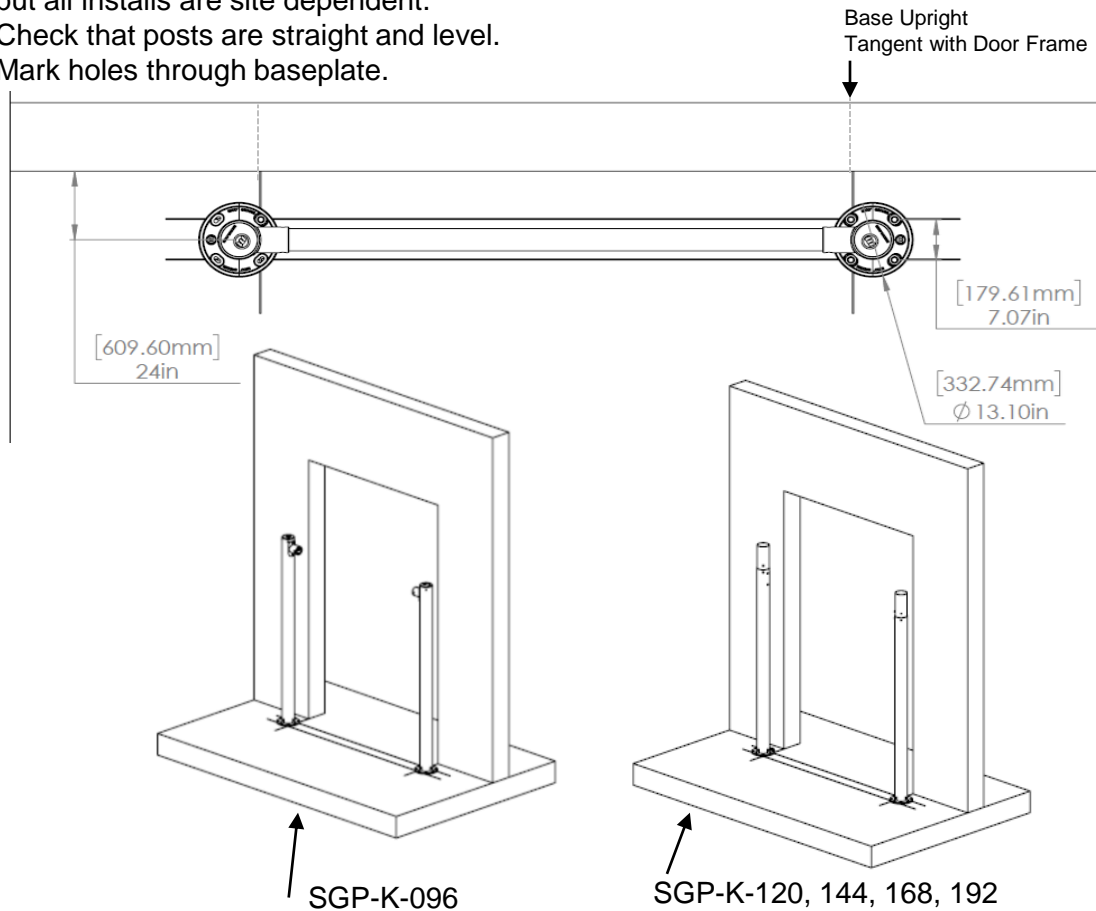

Step 8

All Sizes

Drill marked holes to min. 4-5/8" [118mm] depth with 1/2" [12mm] drill bit. Vacuum clean.

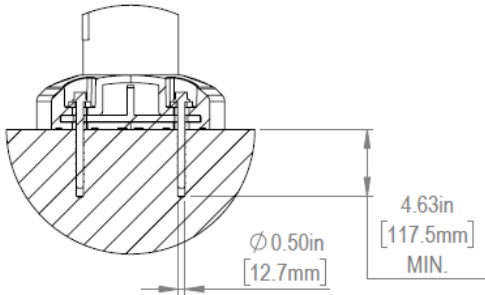

Hammer Drill



1/2" [12mm]
Masonry Bit



Vacuum

Step 9

All Sizes

Check dimension between posts down towards the base and higher towards the top of the uprights to confirm straightness. Fasten both uprights to the floor with QTY 4 x 1/2" [12mm] concrete anchors thru washers per post.



Tape Measure



Impact Driver



Socket Extension



6-Point Socket
3/4" Socket (US)
17mm Socket (SI)

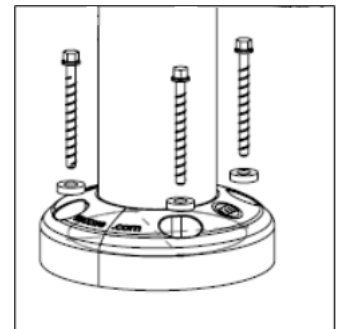
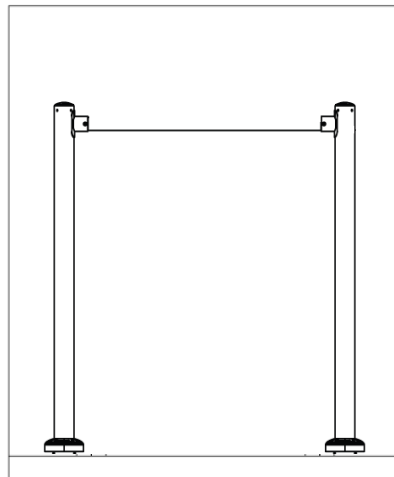
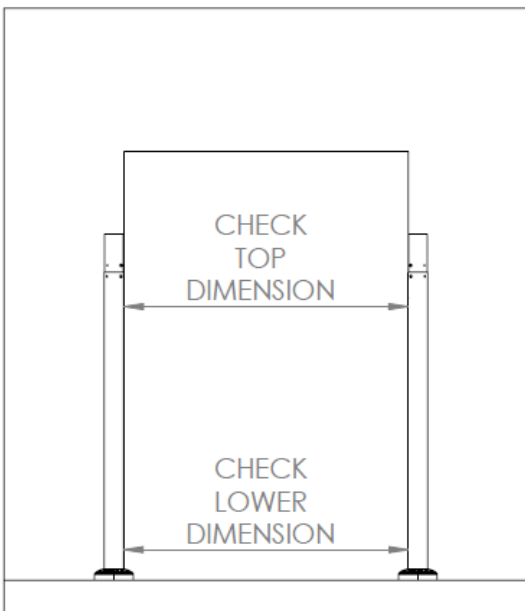

Step 10

All Sizes

Measure and cut Crossbar Rail to 1" [25mm] shorter than the width of the opening.

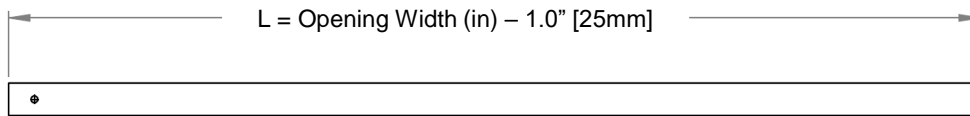
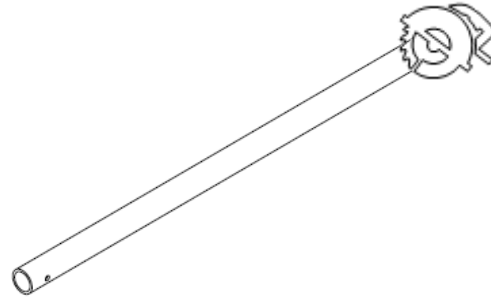
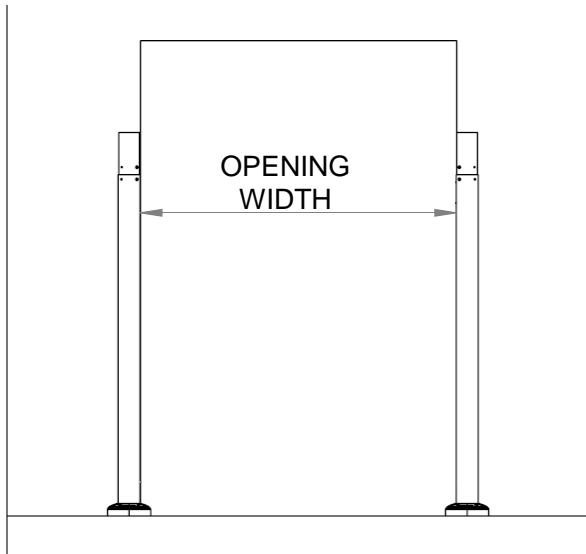

Circular
Saw



Tape
Measure

Step 11

SGP-K-096

Insert end of rail into cup of opposite post. Pivot post slightly outward to allow for rail to fit in cup.

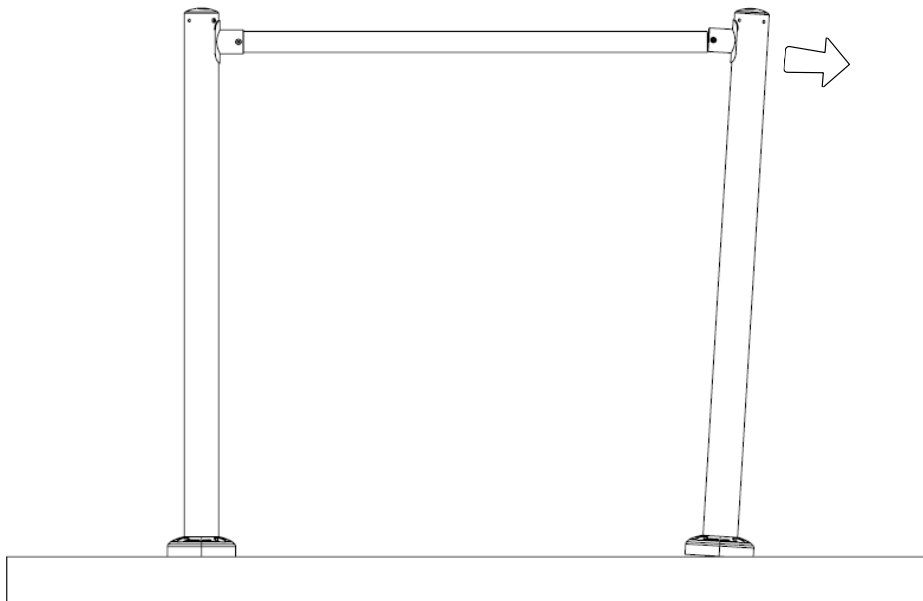

Step 12

All Sizes

Fasten drilled end of rail to one of the uprights using QTY 2 x Flat head screws.

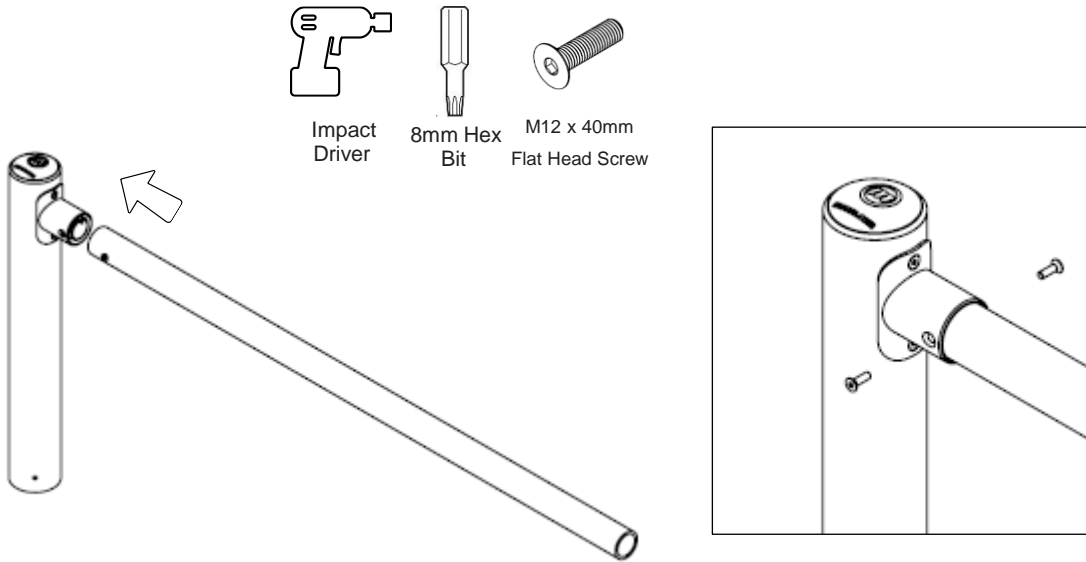

Step 13

SGP-K-120, 144, 168, 192

Insert cut-end of rail into second cup. Check and confirm opening width matches that of the doorway and check straightness.

Once assembled, drill thru-hole in rail using the cup as a template as shown in Figure C.



Drill



9/16" [14mm]
Drill Bit

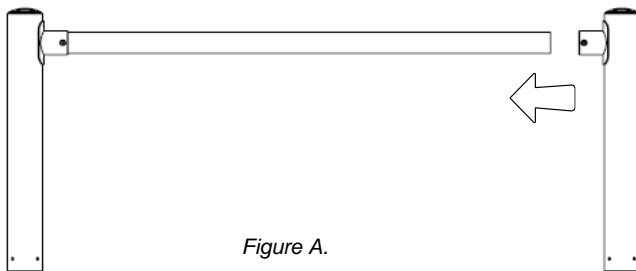

Figure A.

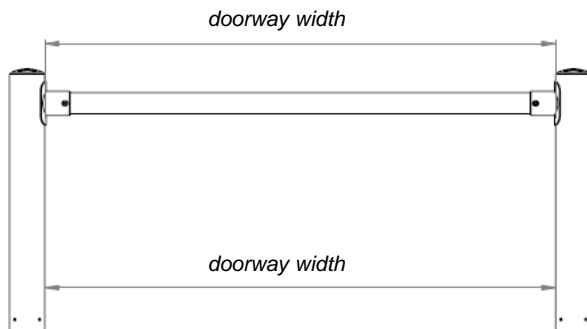

Figure B.

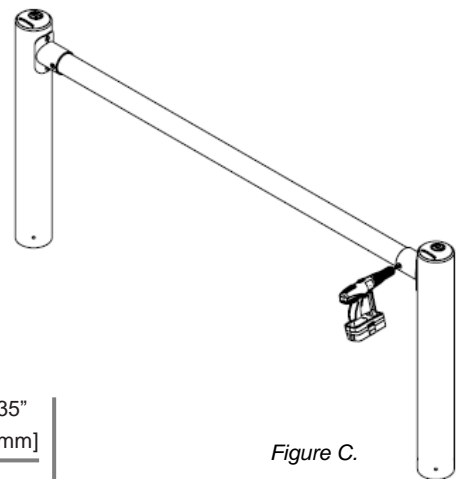

Figure C.

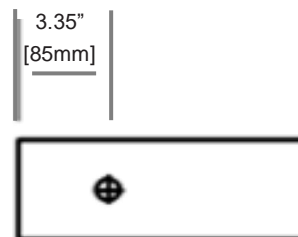
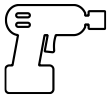

Figure D.

Step 14

All Sizes

Fasten rail to cup with QTY 2 x Flat Head screws



Impact Driver



8mm Hex Bit



M12 x 40mm
Flat Head Screw

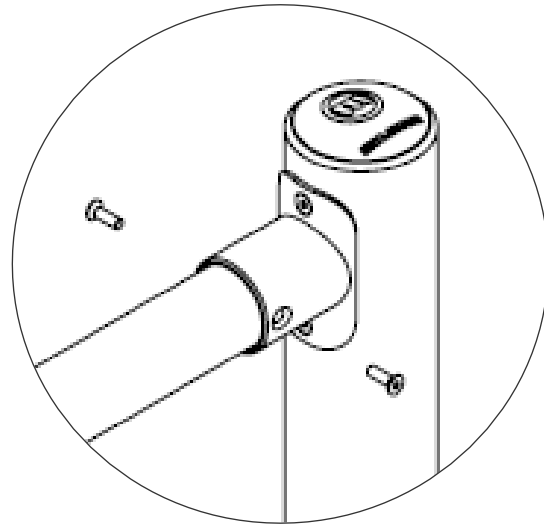

Step 15

SGP-K-120, 144, 168, 192

Lift assembly on to uprights using a scissor lift.

Fasten assembly with QTY 4 X Button Head screws per post with 8mm hex bit.

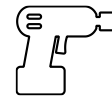

Impact Driver



8mm Hex Bit



M12 x 20mm
Button Head
Screw

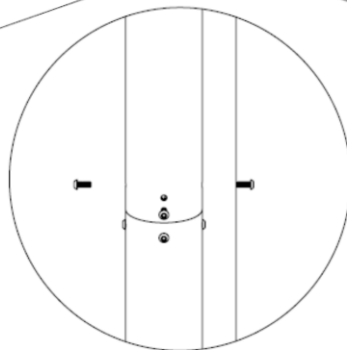
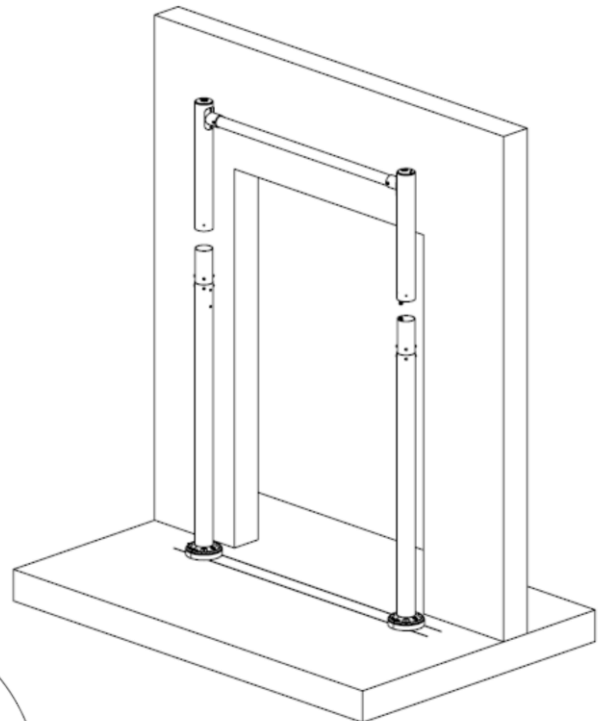
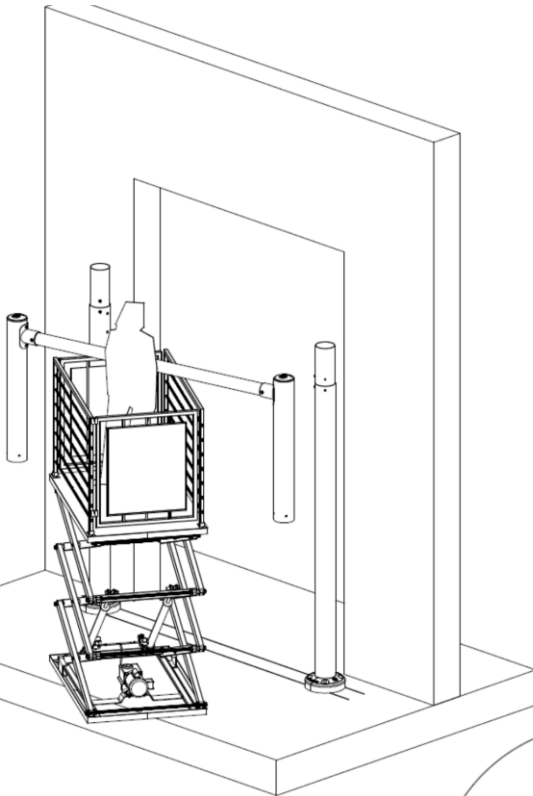

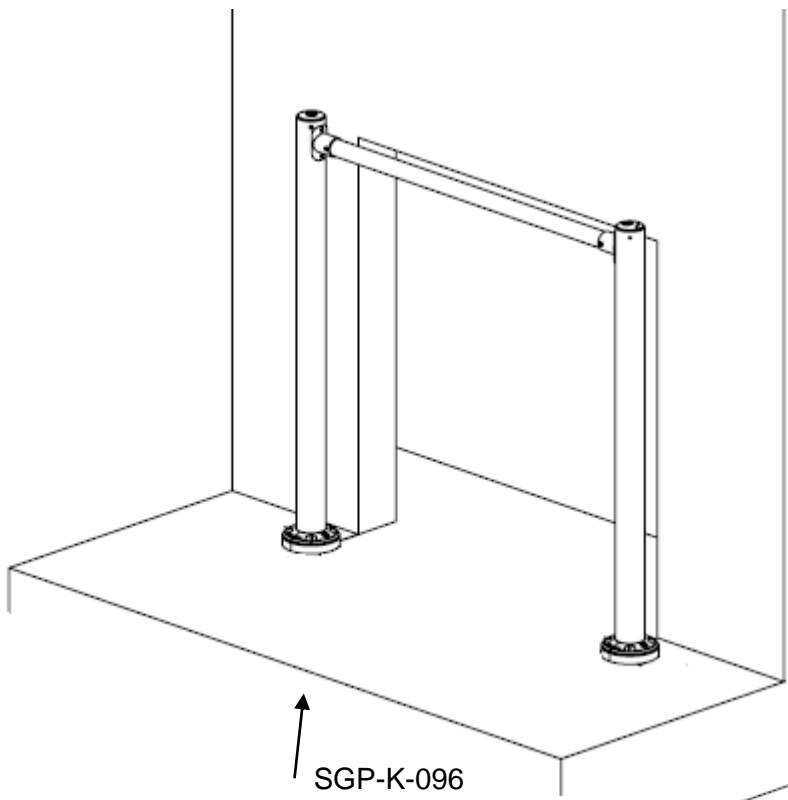

SGP-K-096

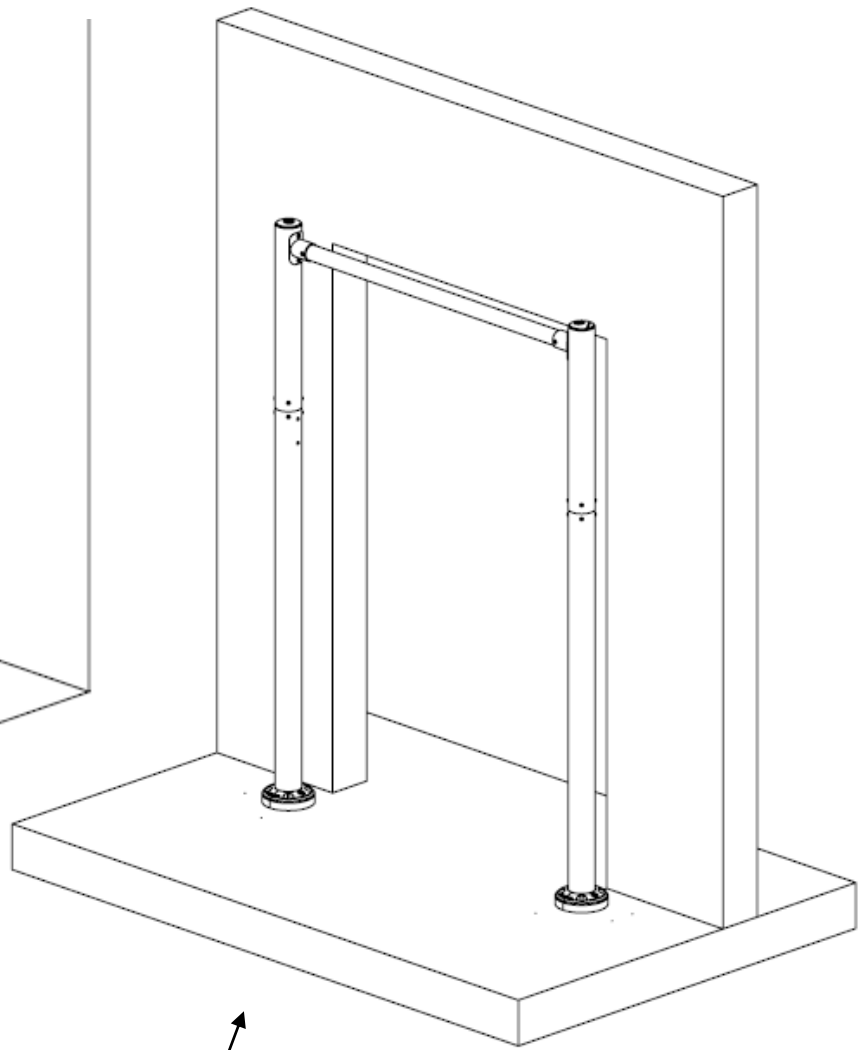

SGP-K-120, 144, 168, 192

SafeStop Pedestrian Swing Gate Add On Kit

INSTALLATION INSTRUCTIONS

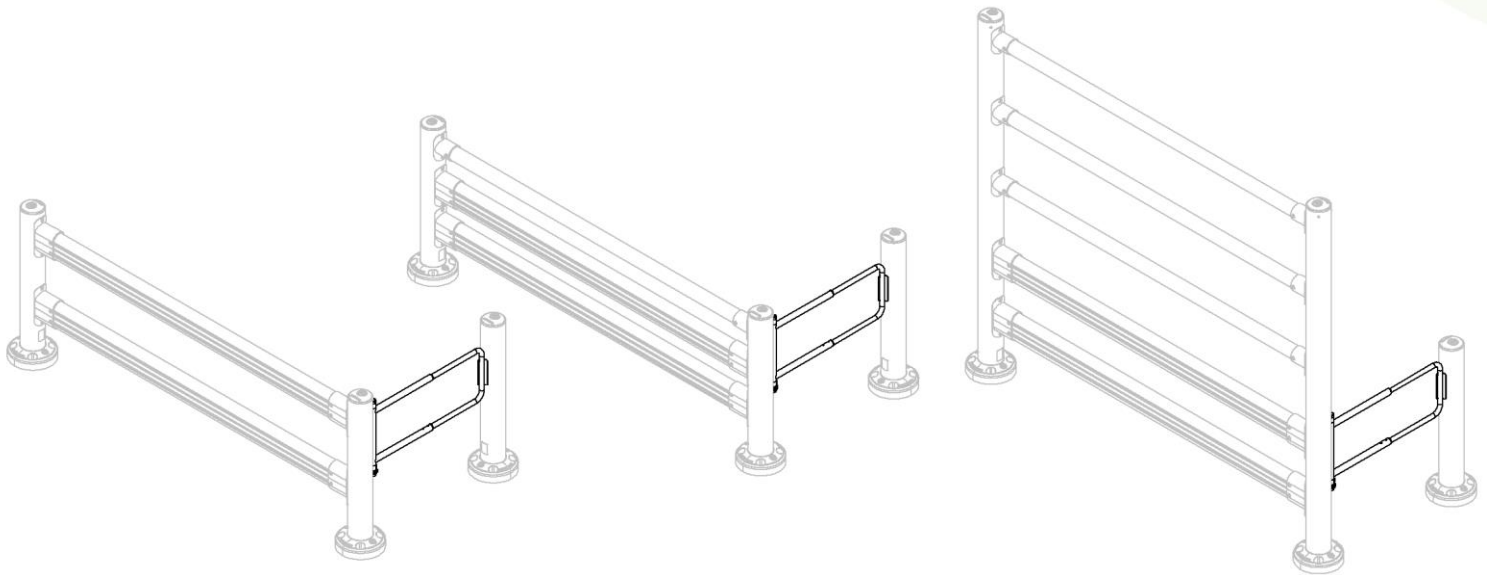

Components

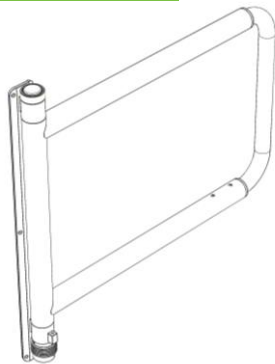

GATE



#12 X 1" HEX HEAD
SELF DRILLING SCREWS

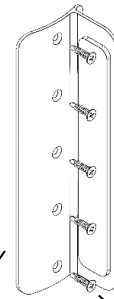

STOPPER

#8 X 3/4" PHILLIPS HEAD
SELF DRILLING SCREWS

Required Tools

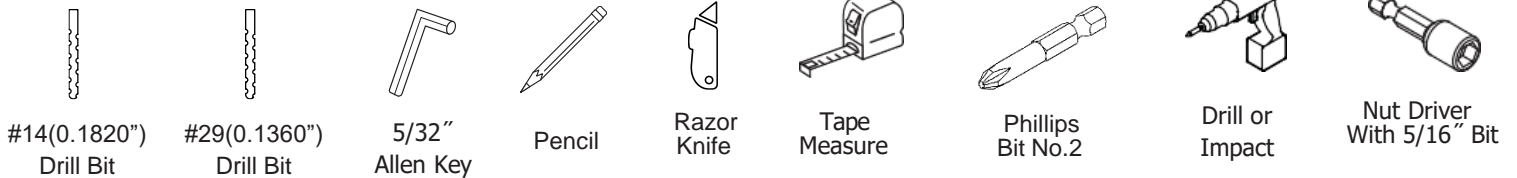

#14(0.1820")
Drill Bit

#29(0.1360")
Drill Bit

5/32"
Allen Key

Pencil

Razor
Knife

Tape
Measure

Phillips
Bit No.2

Drill or
Impact

Nut Driver
With 5/16" Bit



McCue Corporation
Danvers, Massachusetts, USA
+1 (800) 800 8503
customercare@mccue.com

McCue UK & Europe
Milton Keynes, United Kingdom
+44 (0)1908 365 511
uksales@mccue.com

McCue Asia
迈客(厦门)有限公司
Xiamen, Fujian, China
+86-592-2200790

mccue.com



Step 1

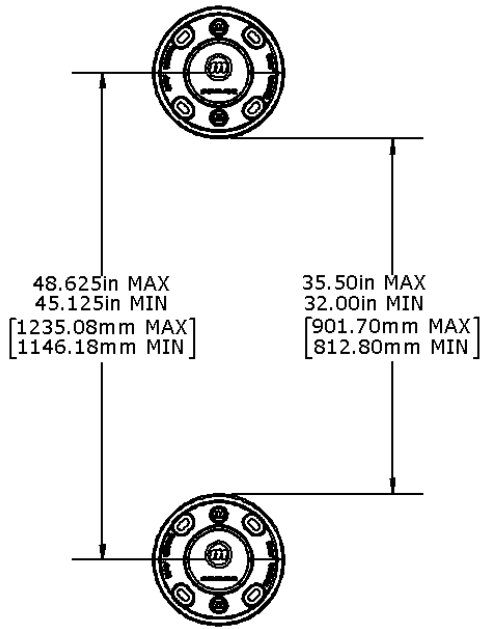

Install SafeStop Products with acceptable spacing as shown above. Refer to product specific installation instructions for Installation procedures.

Step 2

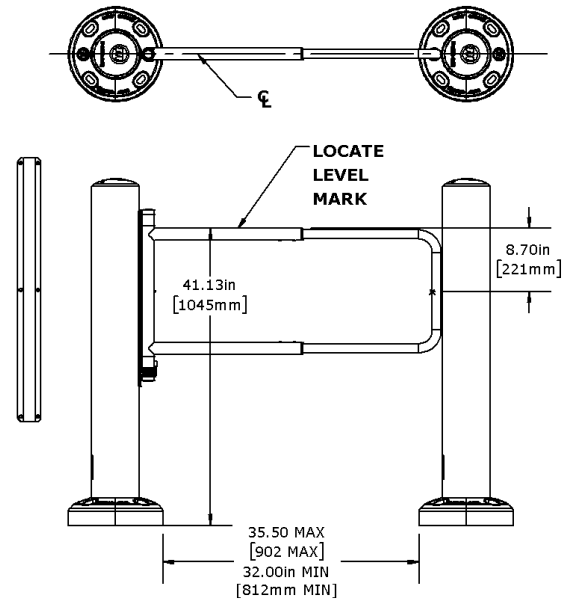

Locate gate on center and mark all the mounting hole locations.

Step 3

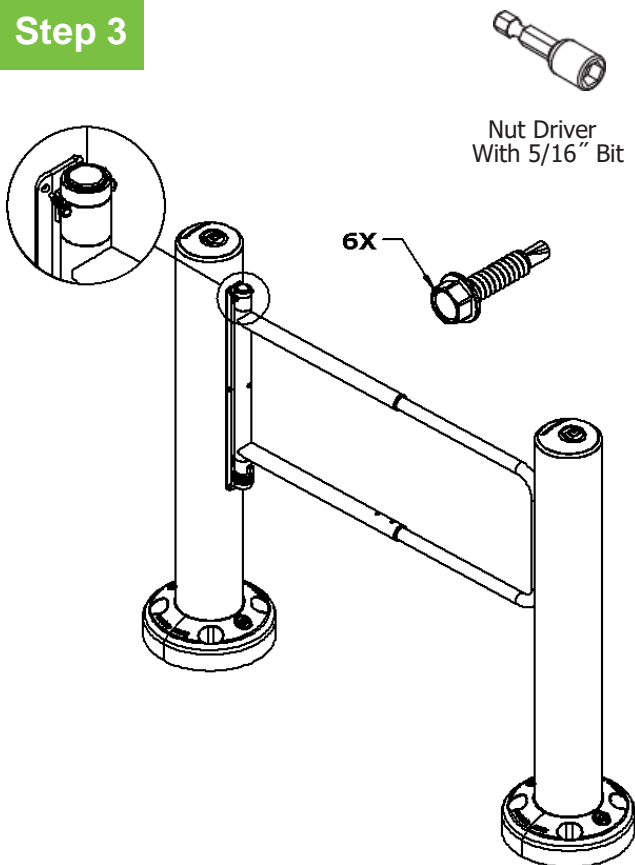

Secure using 5/16" Nut driver bit until flush. Do not over torque.

Step 4

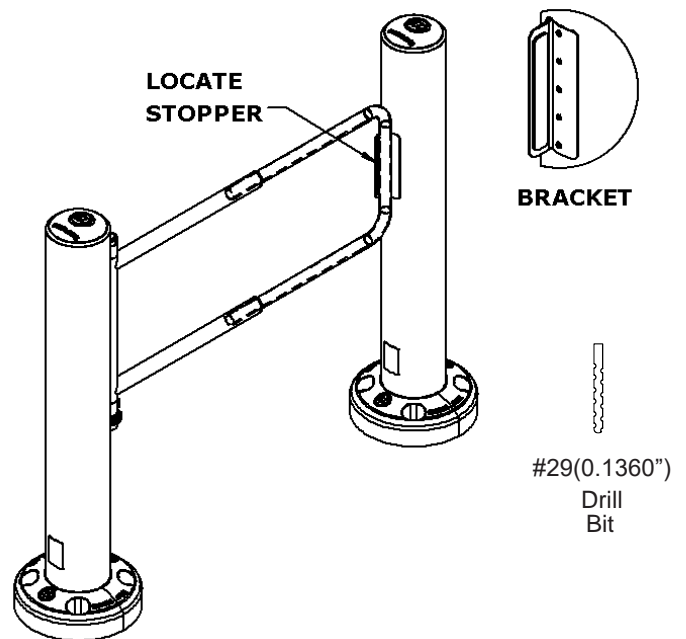

Mark hole locations and drill pilot holes using #29 drill bit.

Step 5

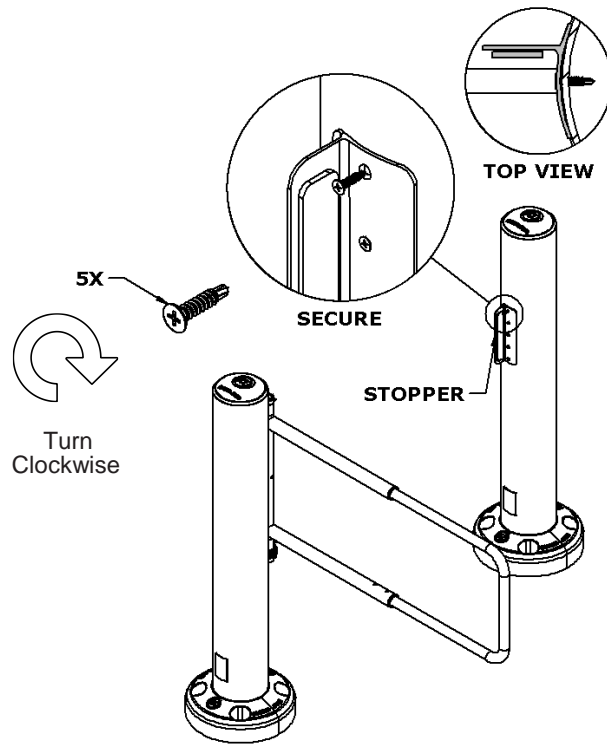

Secure using a drill with a Phillips bit until all screws are flush. Do not over torque.

Step 6

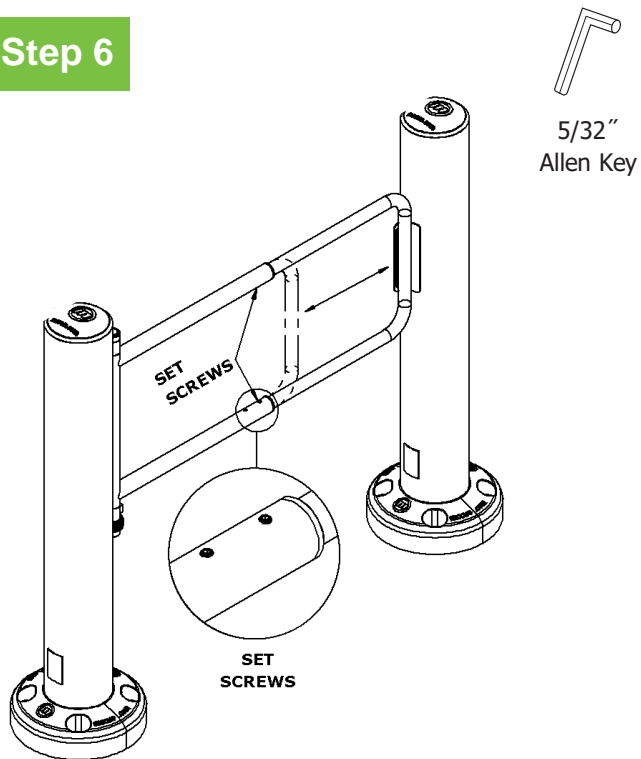

Telescoping arm can be adjusted by loosening set screws. Secure arm by tightening all set screws.

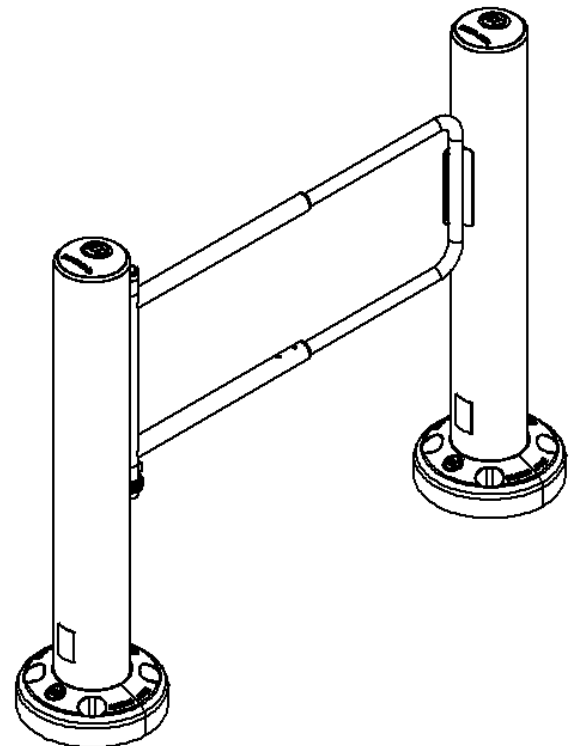

SafeStop Spinner Add On

INSTALLATION INSTRUCTIONS

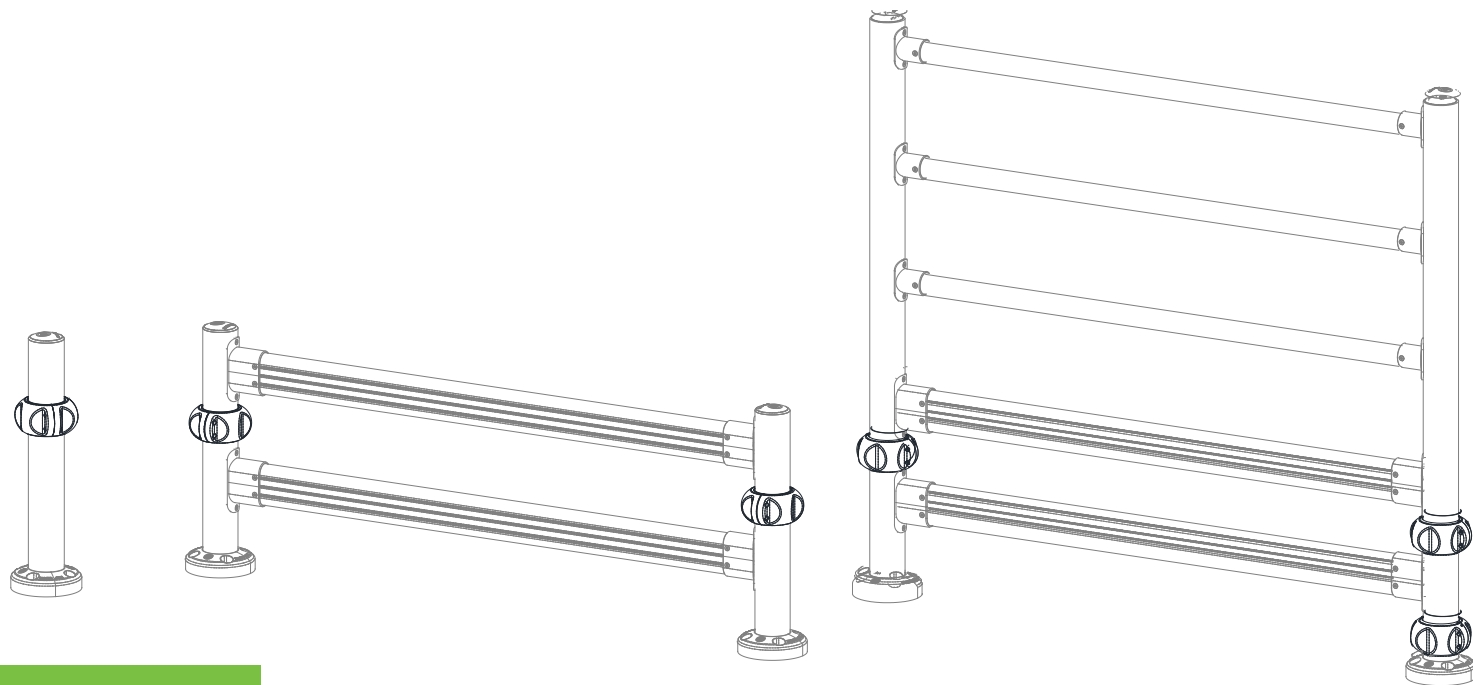

Components

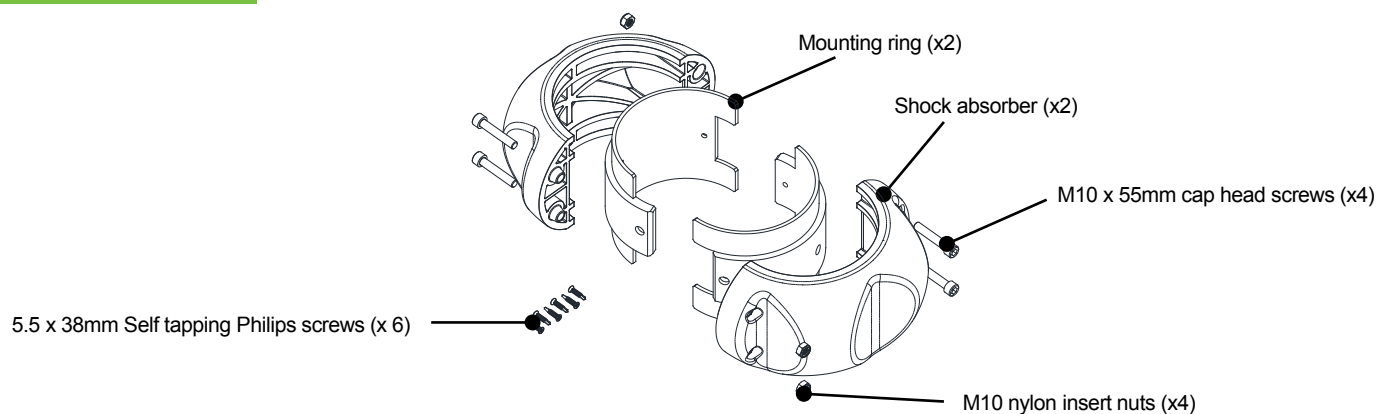

Kit: SSA-K-SPN

Required Tools



Pencil/
marker

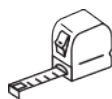

Tape
Measure



Drill



4mm [5/32"]
HSS Drill Bit



Phillip's
Screwdriver/drill bit



8mm
Allen Key



McCue Corporation
Danvers, Massachusetts, USA
+1 (800) 800 8503
customer-care@mccue.com

McCue UK & Europe
Milton Keynes, United Kingdom
+44 (0)1908 365 511
uksales@mccue.com

McCue Asia
迈客(厦门)有限公司
Xiamen, Fujian, China
+86-592-2200790

mccue.com



Recommended Install Heights

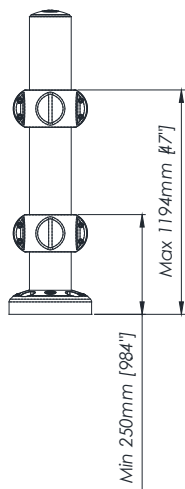

SafeStop Bollard

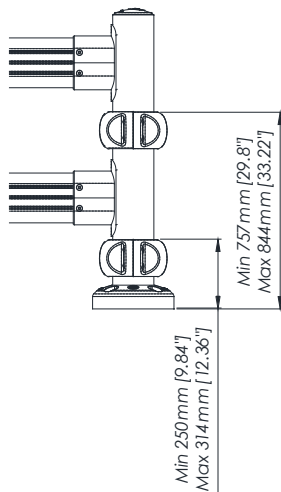

SafeStop GuardRail

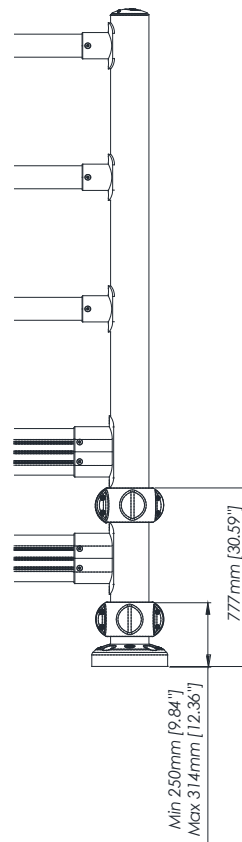

SafeStop Topple Barrier

Step 1

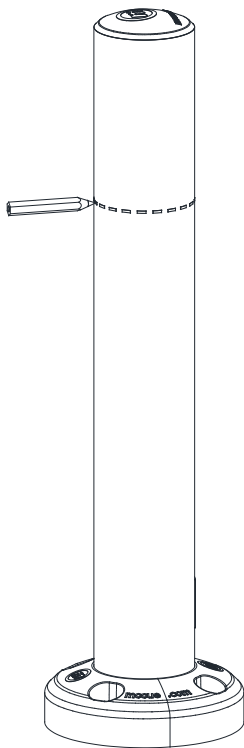

Measure and mark out the top height required for the Spinner

Step 3

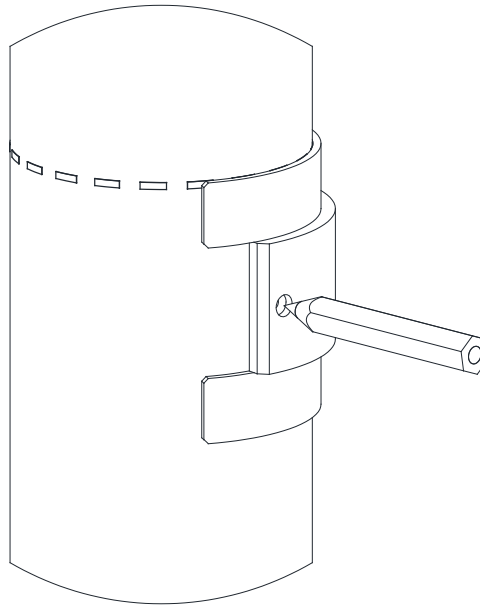

Position the 1st half of the mounting ring ensuring it is straight marking the 3-hole locations

Step 4

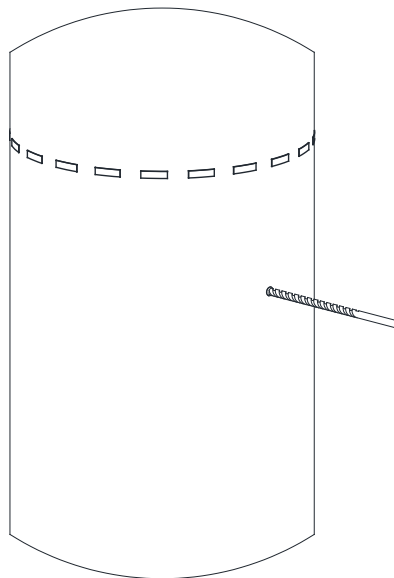

Using a drill and 4mm [5/32"] HSS drill bit pilot hole the 3 marked hole locations

Step 4

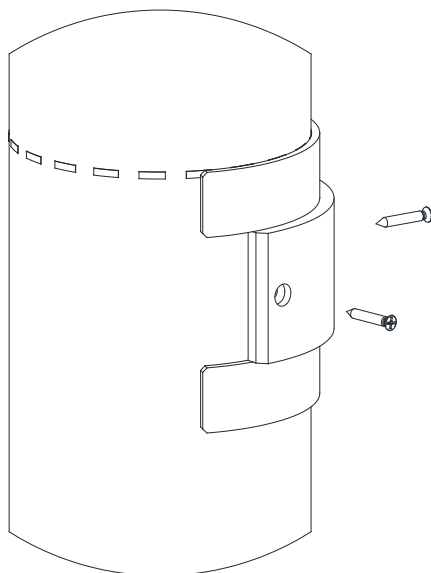

Using the self tapping screws supplied reposition and secure the 1st half of the mounting ring

Step 3

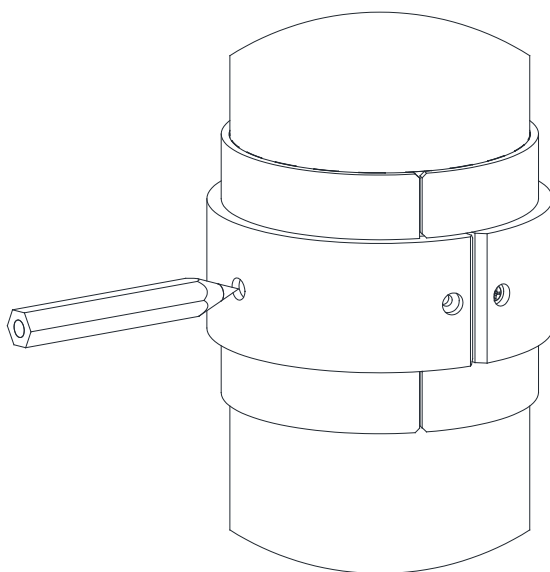

Position the 2nd half of the mounting ring and mark the 3-hole locations

Step 4

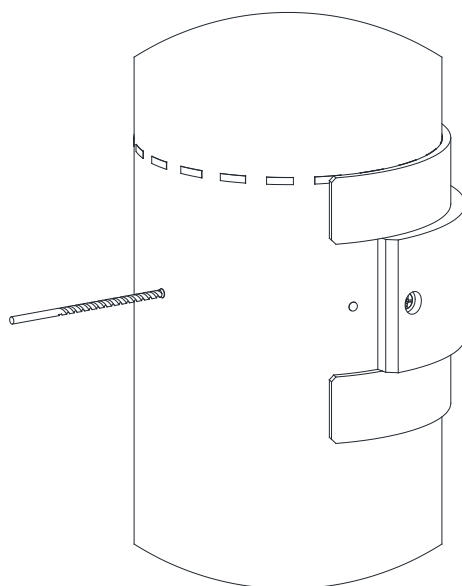

Using a drill and 4mm [5/32"] HSS drill bit pilot hole the 3 marked hole locations for the 1st half of the mounting ring

Step 5

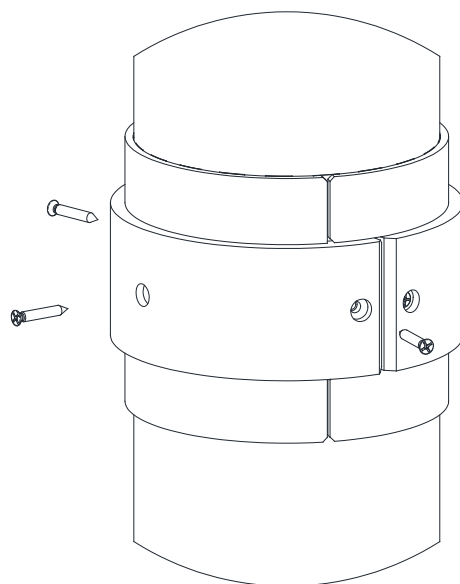

Using the self tapping screws supplied reposition and secure the 2nd half of the mounting ring

Step 7

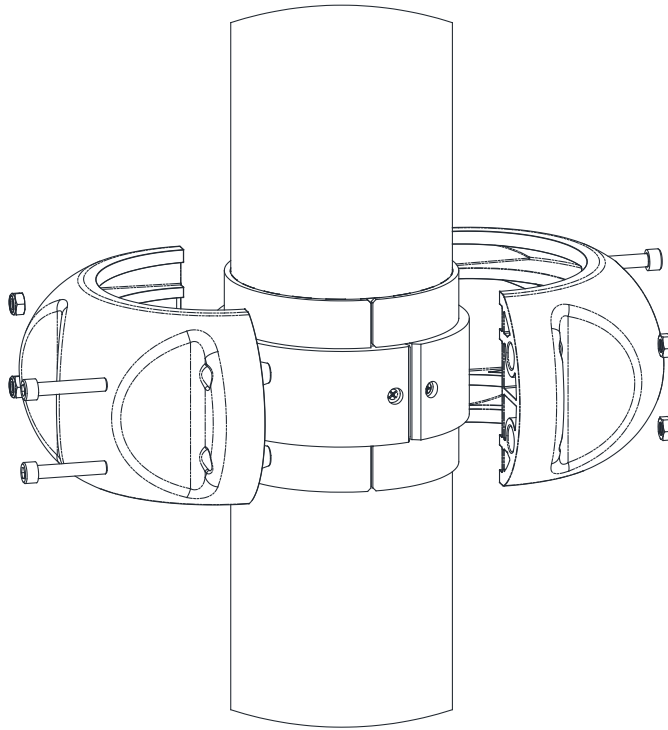

Using the M10 cap head screws and nuts supplied secure the shock absorber around the fixed mounting ring

Step 8

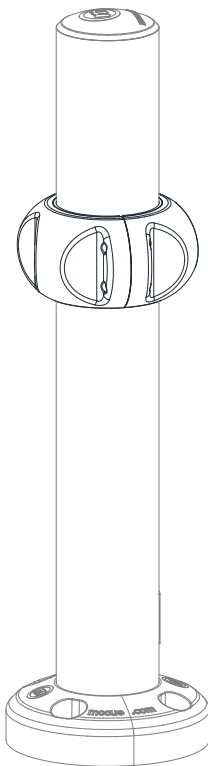

Installation Complete