

CartPark Architectural

INSTALLATION INSTRUCTIONS

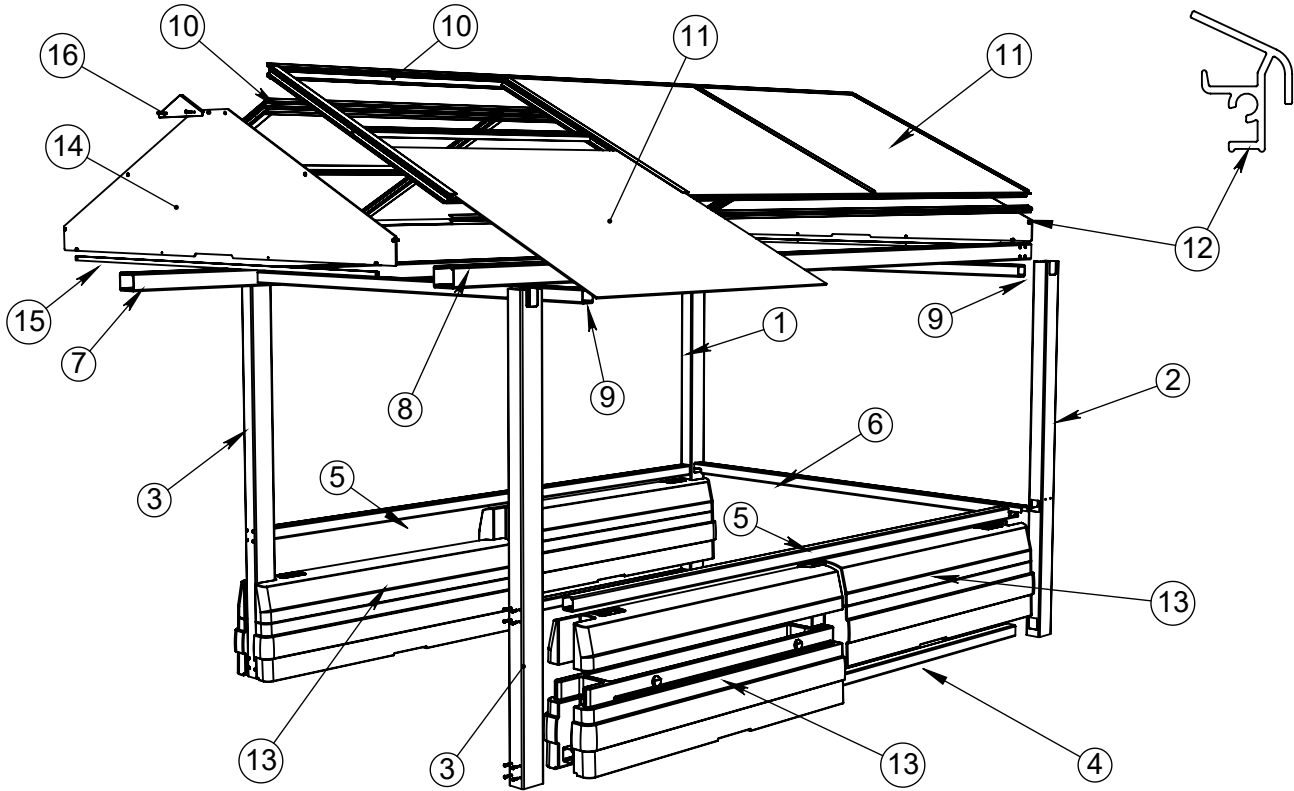

CARTPARK ARCHITECTURAL (CPAS-4B-UPT-419)			PART NUMBERS
ITEM #	QTY	DESCRIPTION	
1	1	REAR LEFT VERTICAL POST, 83.25" LONG	CCASFABVPRL
2	1	REAR RIGHT VERTICAL POST, 83.25" LONG	CCASFABVPRR
3	2	FRONT VERTICAL POST, 83.25" LONG	CCASFABVPPF
4	2	LOWER SIDE RAIL, BARRIER CONNECTOR, 135.4375" LONG	CCASFABLRS
5	2	UPPER SIDE RAIL, GUIDANCE RAIL, NOTCHED 135.4375" LONG	CPASC-UPPERSIDERAIL
6	1	BACK STOPBAR, 95.1785" LONG	CCASFABBR
7	1	TOP RAIL LEFT, HORIZONTAL BAR, 164.0" LONG	CCASFABTRL
8	1	TOP RAIL RIGHT, HORIZONTAL BAR, 164.0" LONG	CCASFABTRR
9	2	CROOSBAR ALONG TOP, 96.9375" LONG	CCASFABCR
10	2	ROOF FRAME ASSEMBLY, 164.0"X56.0"X2.0" FRAME	CCPAS-FABRF
8		ROOF SLOPE END, 51.295", HOLES FOR TRI-GLASS	CCPASFABRSE
2		TOP RIDGE, WITH WEATHER FOAM TAPE, 164" LONG	CCPASFABRDG
2		NO OVERHANG SILL, 164" LONG " NEW EXTRUSION"	CCPASFABSILL-V2
6		ROOF CROSS MEMBER, WITH DOUBLE SIDED TAPE 52.75" LONG	CCASFABCM
11	6	ROOF PANELS, FLUTED LEXAN SHEET, 53.875" X 52.875" X 0.24"	CCPAS-RFPNL-UPTOWN
12	2	RETAINER, ROOF DRIP EDGE, 164.0" LONG "NEW EXTRUSION"	CCAS-FABRET-V2
13	4	PLASTIC BARRIER, HDPE, 70.25" X 12.0" X 20.0"	CPAS-BARRIER-XXX
14	2	TRIGLASS PANEL, HIGH IMPACT ACRYLIC. 97.18" X 24.875"	CCPAS-TRIPNL-V2
15	2	TRIGLASS PANEL ALUMINUM SUPPOT, 88.983" LONG	CCPASFABTPNLSP
16	2	TRIGLASS PANEL TOP CAP, ALUMINUM SHEET 10.94 X 3.50	CCPASFABTCAP
HARDWARE			
94		1/4-20 X 1.0" TORX PAN HEAD SCREW, TAPTITE 2000, S/S	CCPAS-HARDWARE
7		1/4-20 X 1-3/4" HEX WASHER HEAD SCREW, S/S	
7		1/4-20 SERRATED WASHER NUT, S/S	
16		ALUMINUM SHOULDER SPARCER 1/4" ID X 3/8 LONG	
4		#10-32 X 3/8" LONG #2 DRIVE, THREAD CUTTING SCREW S/S	
1		SCREW WAX SMALL TINE .85oz * 24g	
REV APRIL 09, 2024			



McCue Corporation
 Danvers, Massachusetts, USA
 +1 (800) 800 8503
customer-care@mccue.com

McCue UK & Europe
 Milton Keynes, United Kingdom
 +44 (0)1908 365 511
uksales@mccue.com

McCue Asia
 迈客(厦门)有限公司
 Xiamen, Fujian, China
 +86-592-2200790

mccue.com



Two-Person Installation Recommended

Tools Required.

- (2) Six foot step ladders
- Tape Measure
- Cordless Screwdriver & back-up batteries (18V minimum)
- 7/16" hex head driver bit or 7/16" Socket & Ratchet handle
- 7/16" Wrench
- T30 Torx Bit
- Cleaning Rags
- 1,200 pounds (544 kilograms) of sand, pea stone or gravel for ballasting
- Wax for screws (Included)

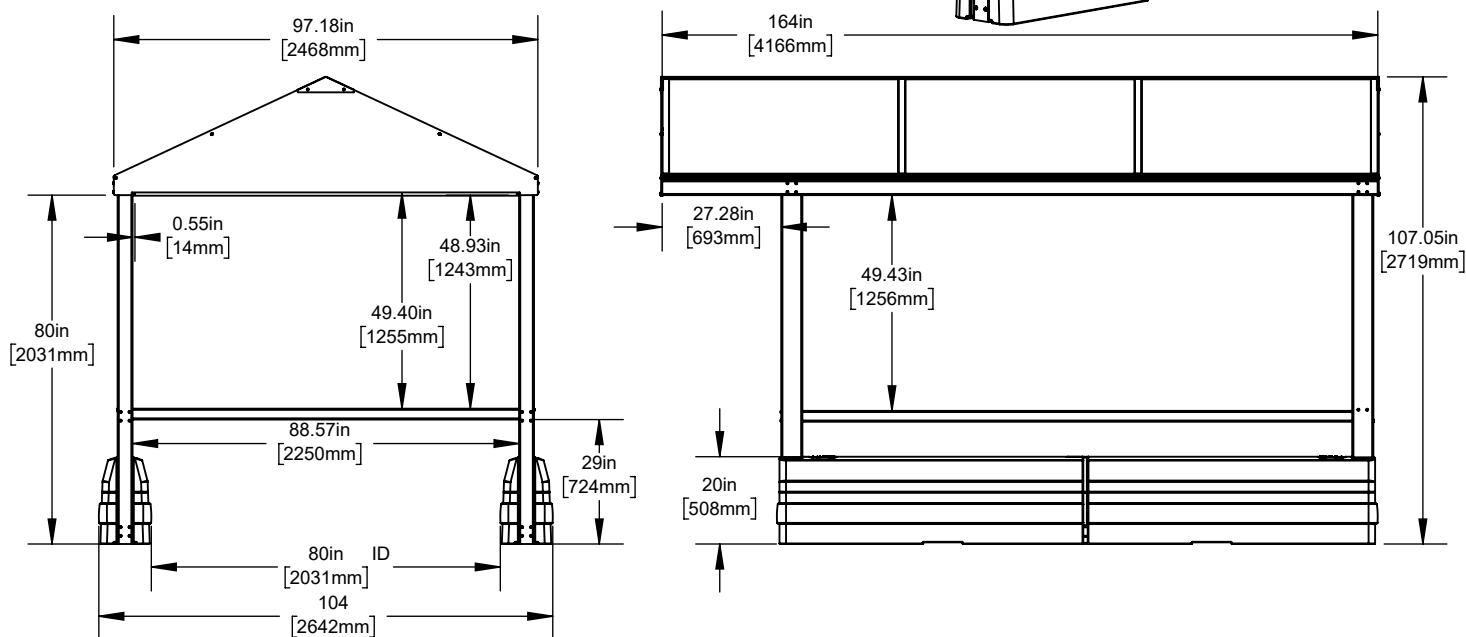
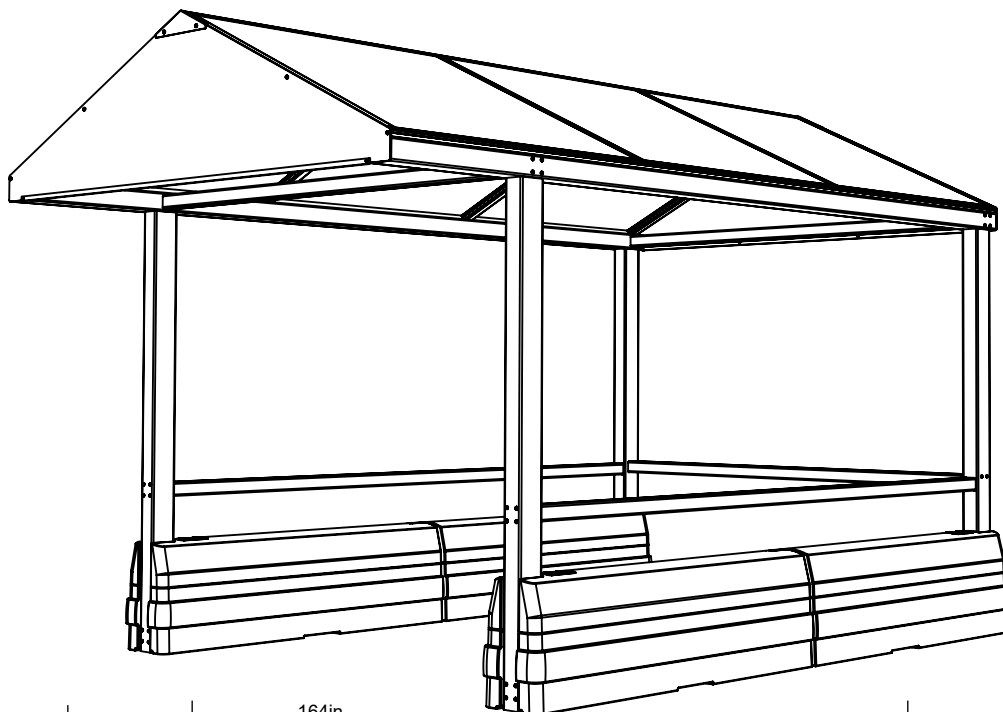

IMPORTANT: Assemble on a flat, level surface. All cart corrals should be inspected on a regular basis for damage. McCue recommends a minimum of two inspections per year in the spring and fall. Any damaged pieces should be replaced with McCue replacement parts.

Step 1: Assemble right and left side frames

On a flat surface, set the back right vertical post, front vertical, lower side rail and upper side rail as shown. Slide upper side rail so that the notch is facing up and into the back right post as shown in detail -A-. Secure both lower and upper side rail to vertical posts with (14) Taptite 1/4-20x1.0" screws coated with wax at the front and back of the vertical posts. Do not over-tighten the screws. Repeat this step to assemble the left side. Pieces should be protected from scratches during the installation process.

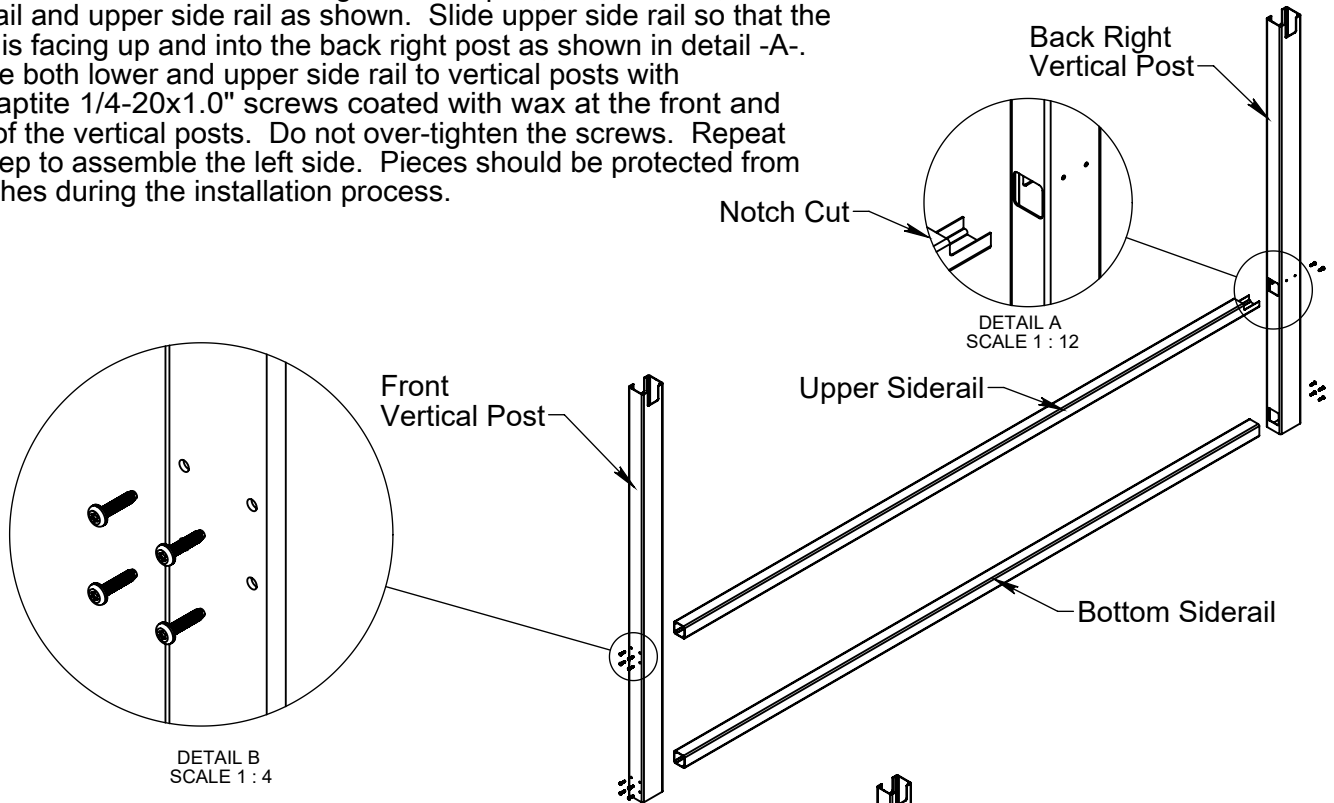

Step 2: Stand sides upright

When both left and right side frames are complete, stand sides frame upright making sure that the cut out openings for the stopbar are facing each other on the right and left back vertical posts. The stopbar openings should be located towards the back of the unit.

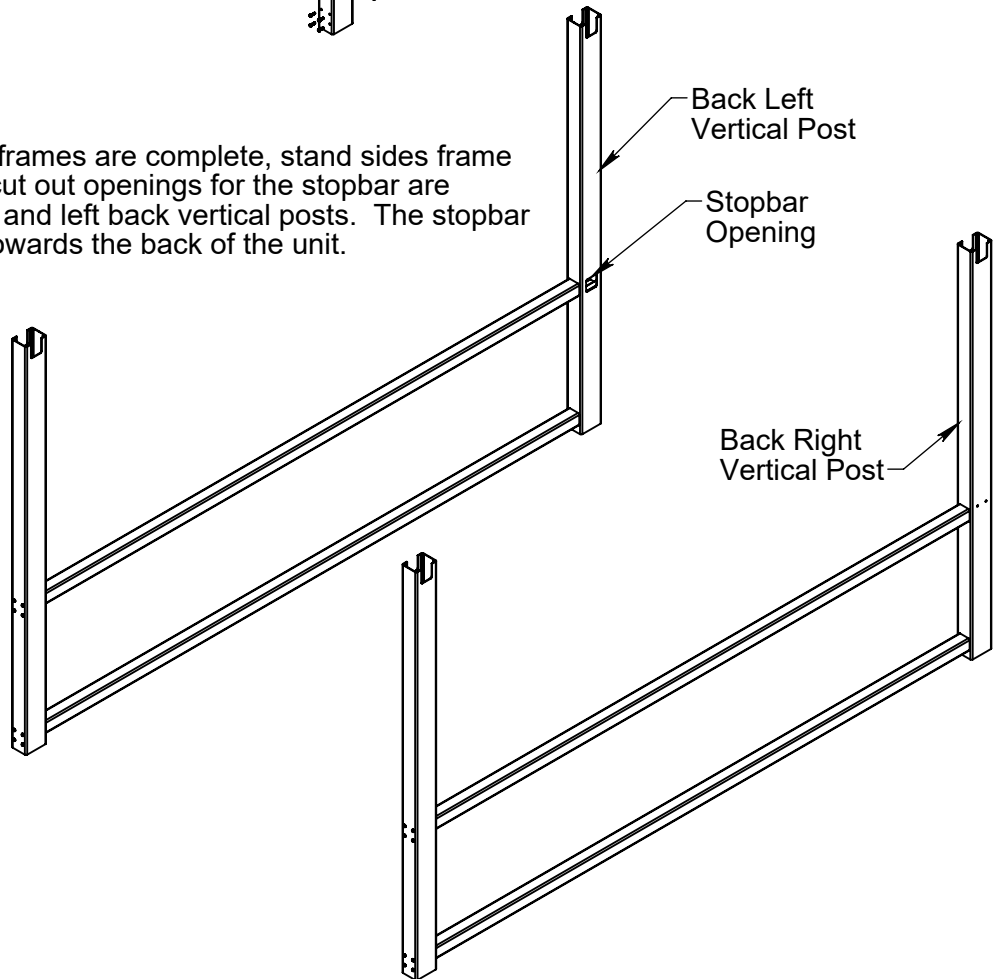

Step 3: Secure back stopbar

Slide the Stopbar into the back left and right vertical posts openings as shown. Orient back stopbar notches to face down prior to sliding into vertical post. Secure Stopbar to right and left vertical post with (4) Taptite 1/4-20x1.0" screws coated with wax from the outside of the unit. Do not over-tighten screws.

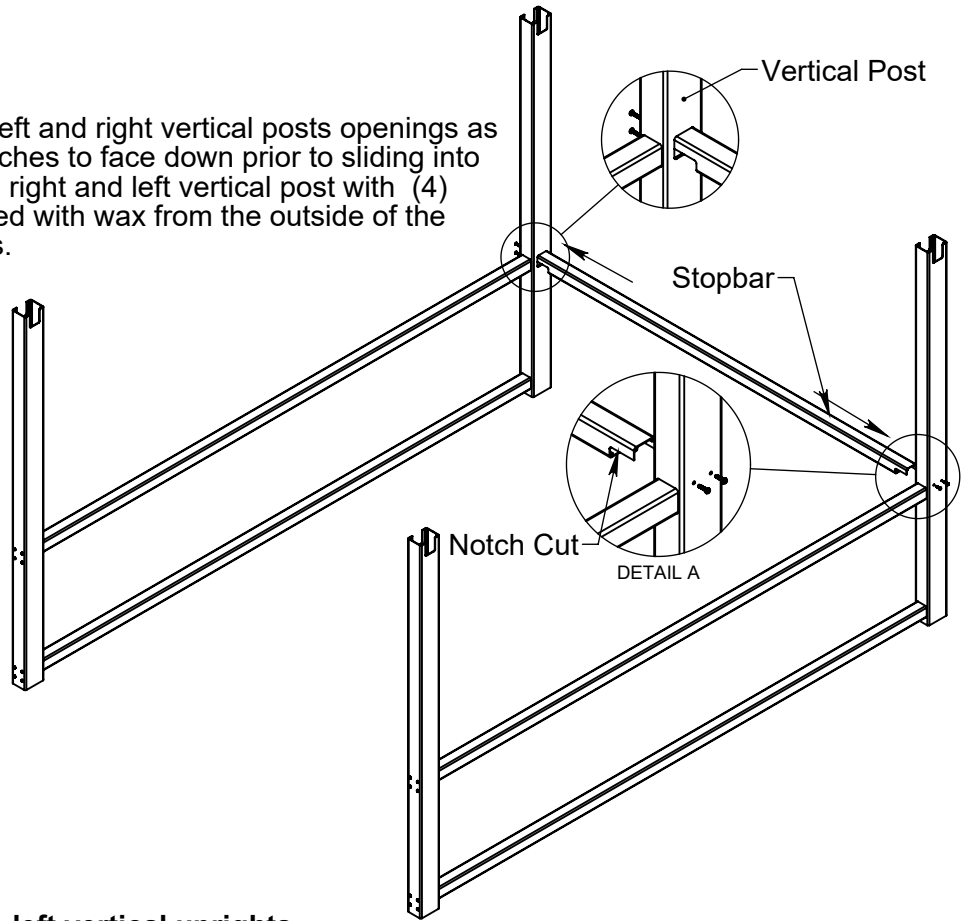

Step 4: Slide Left Toprail into left vertical uprights.

Slide Left Toprail into left frame vertical uprights so that the overhang leans toward the front of the unit. Cut out openings should face inside the unit.

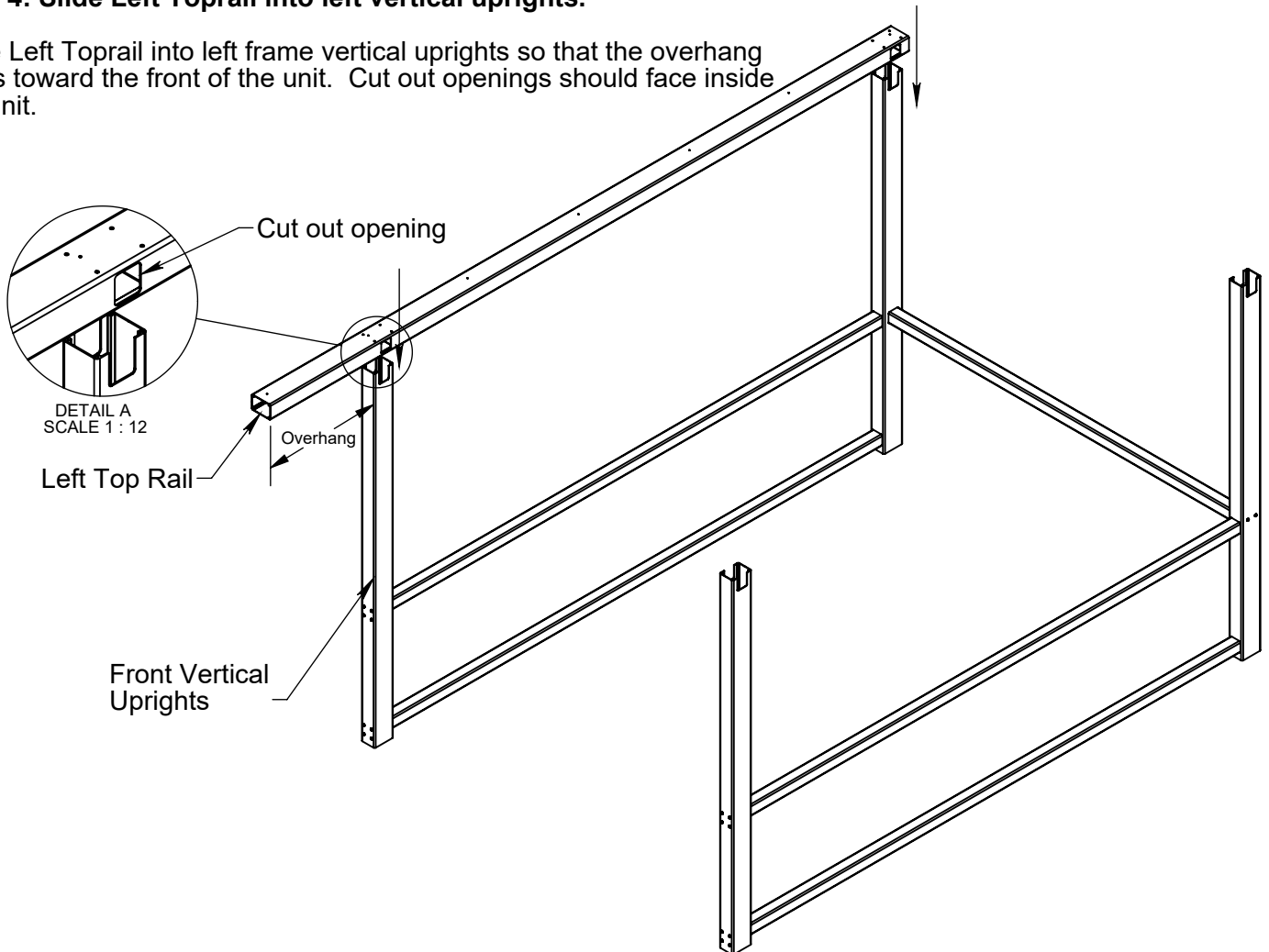

Step 4.1: Slide Top Cross Rail

Slide cross rail into the cut out openings of the Left Top Rail, out as shown. Rest opposite end of cross rails into the top of the right verticals. Do not secure crossbar and continue next step.

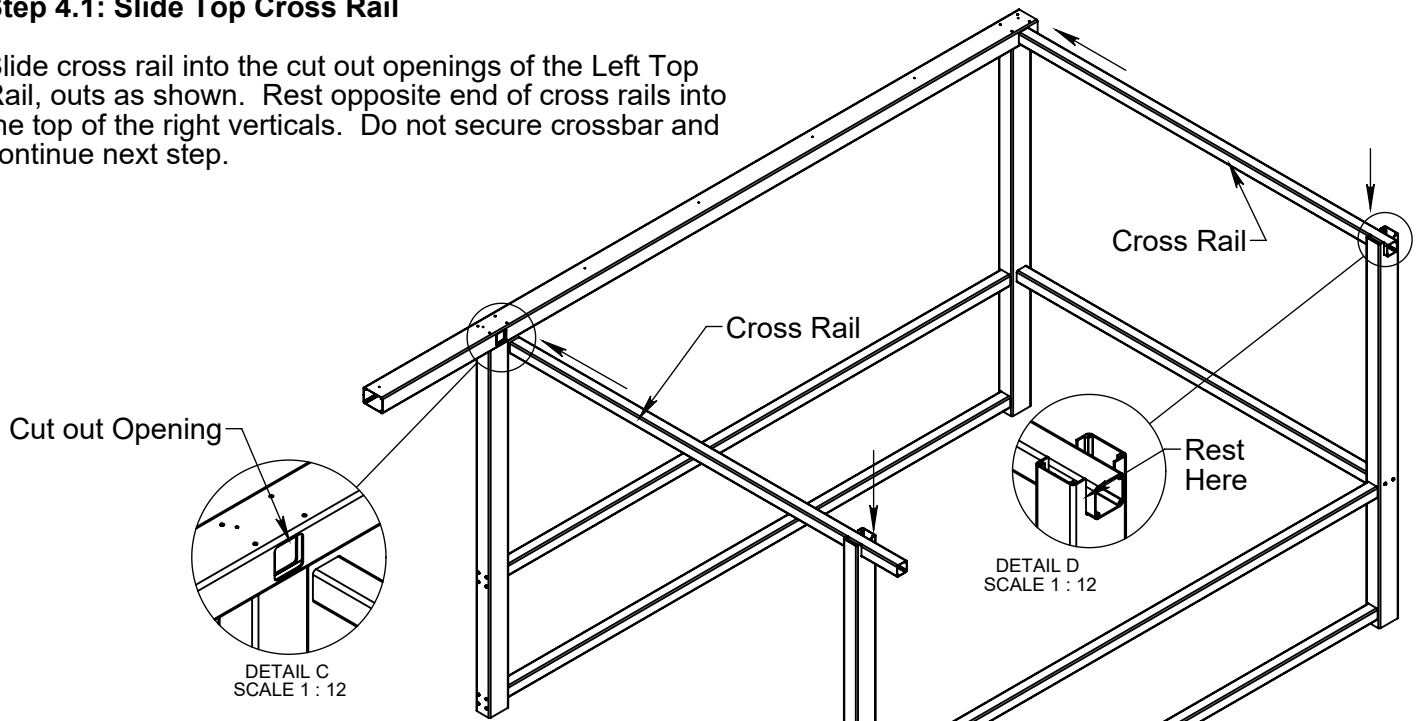

Step 4.2: Slide Right Toprail into Cross Rails and into the right vertical uprights.

- ① Slide Right Toprail into the open ends of the cross Rails.
- ② Once in place, lift Right Toprail up and over uprights so that the cross rails come off the uprights.
- ③ Slide Right Toprail over uprights.
- ④ lower into the open ends of the uprights.

Important: Make sure Toprails are locked into the verticals and ensure all attachment locations are fastened as described in 4.3. Make sure Cross Rail at front is sitting flush inside both Toprails.

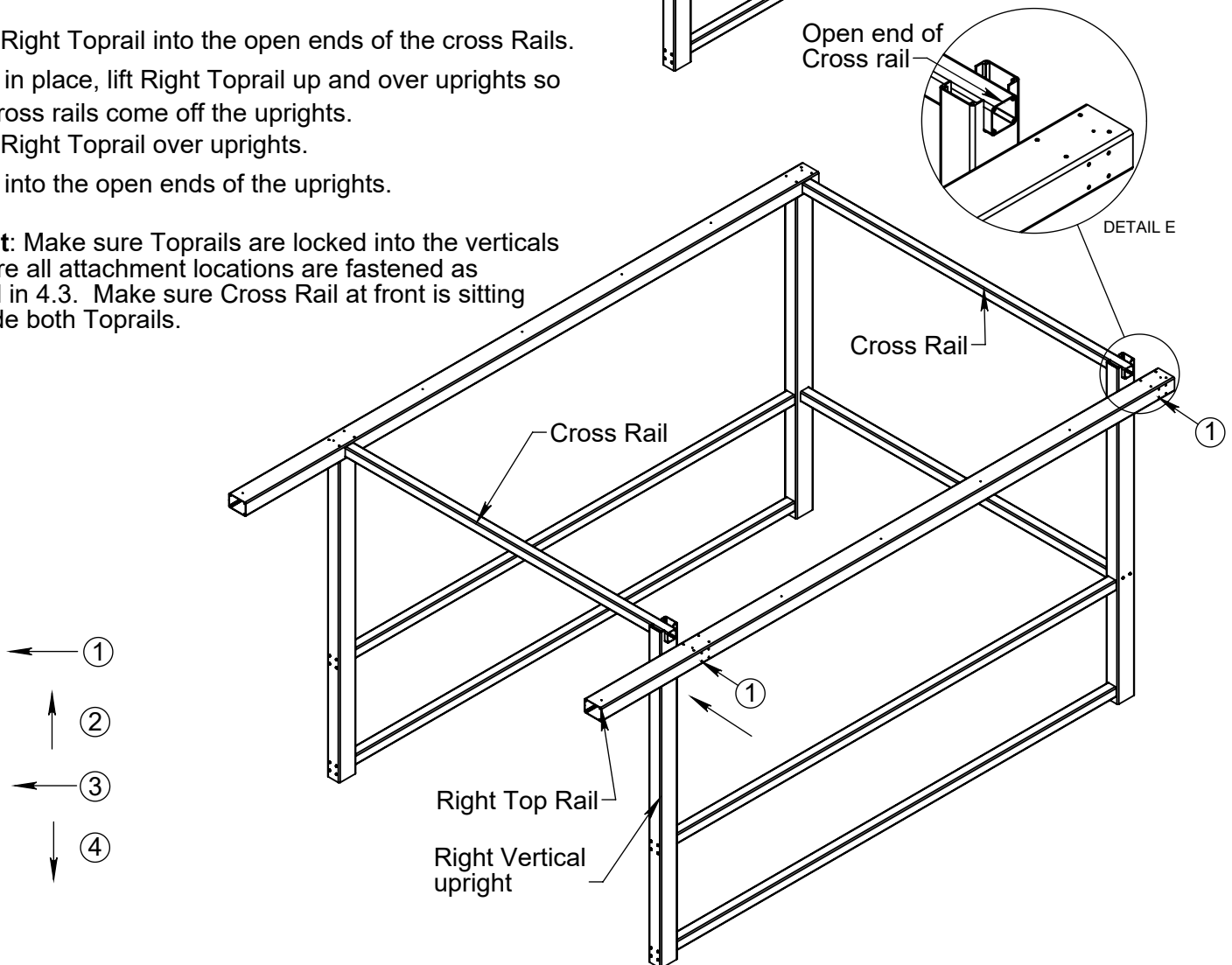

Step 4.3: Secure Toprails into vertical Uprights and into Cross Rails.

Make sure both Toprails are fastened to the verticals with (16) Taptite 1/4-20x1.0" screws coated with wax.

Make sure both Cross Rails are fastened to the Toprails with a total of (16) 1/4-20x1.0" Taptite screws coated with wax.

Important: Make sure every hole attachment is secured by a screw. A total of 32 screws are needed in this step.

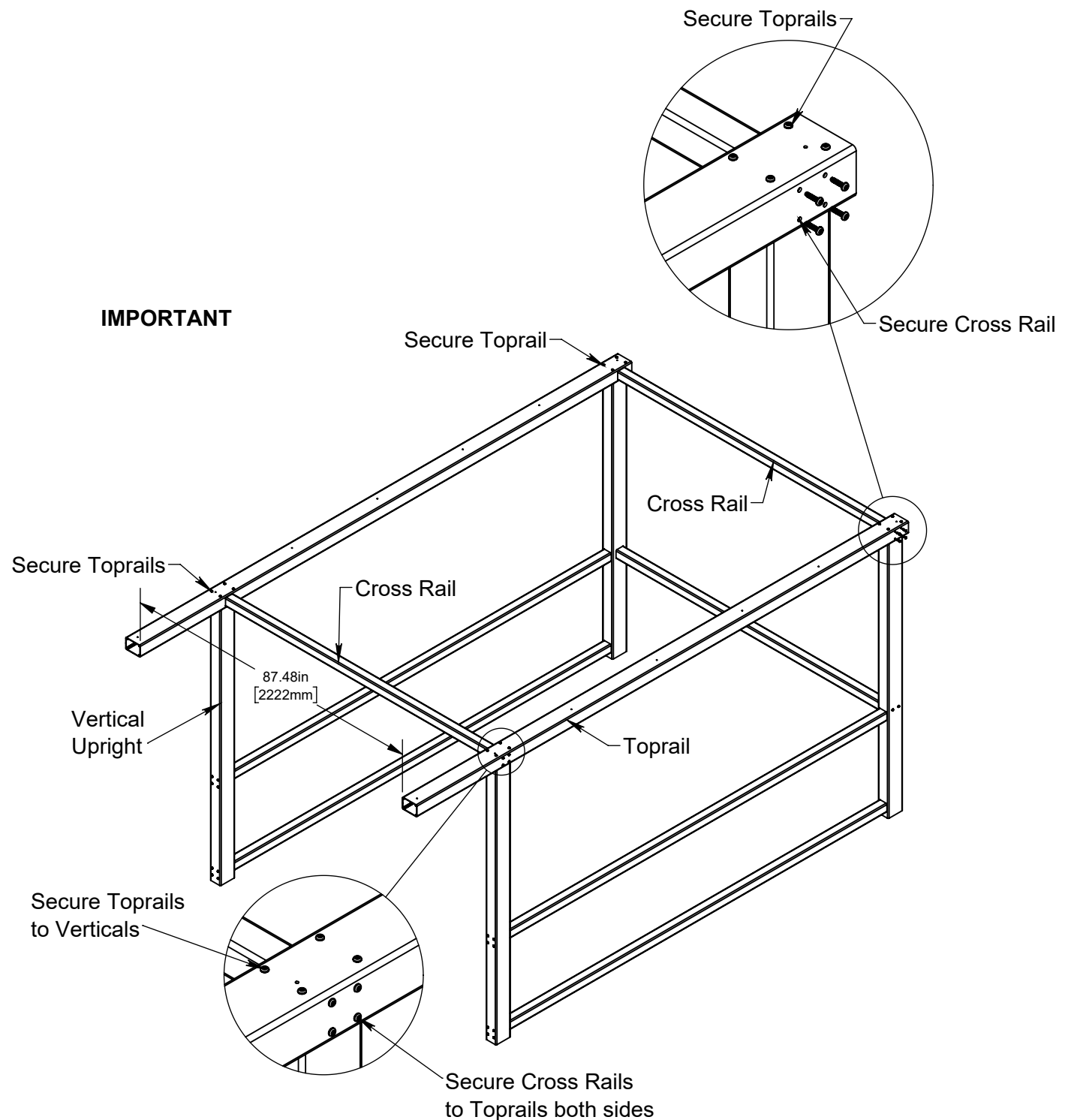

Step 5A: Lift Roof Frame Assemblies and position

Lift both roof frame assemblies onto the top of the unit as shown so that the outside edges run parallel to both horizontals and 3/4" away from edge. Make sure that the roof panel groove is on the upper side and that the top ridge extrusions are at the center of unit as shown in detail -C-. The front and back of the roof assemblies should be flush with front of horizontals.

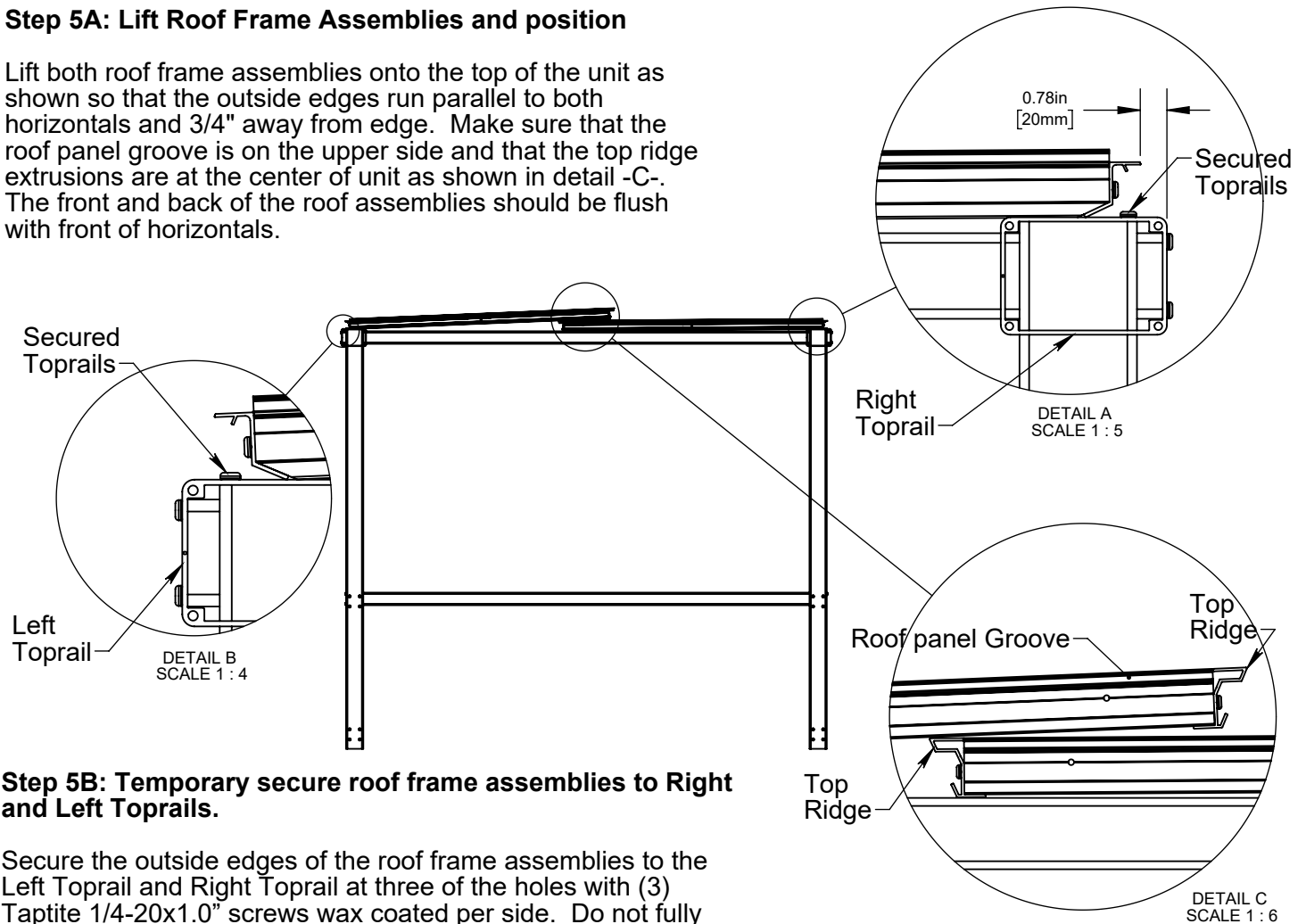

Step 5B: Temporary secure roof frame assemblies to Right and Left Toprails.

Secure the outside edges of the roof frame assemblies to the Left Toprail and Right Toprail at three of the holes with (3) Taptite 1/4-20x1.0" screws wax coated per side. Do not fully secure screws to allow roof frames assemblies to pivot on these screw.

Note: do not fully secure the screws at this time. Please see next step.

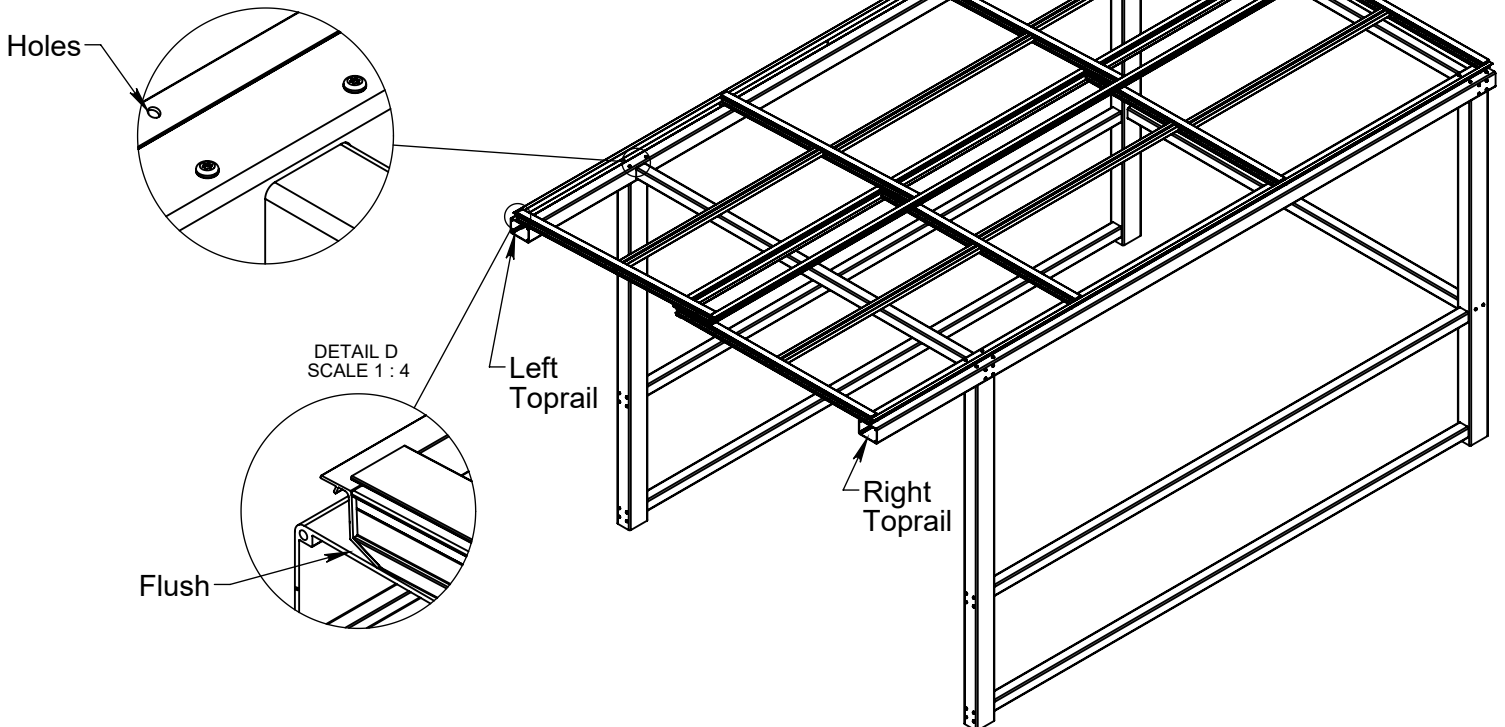

Step 6A: Lift Roof Frame Assemblies to meet at the peak and Secure

Lift roof frame assemblies up and over each other. Lower roof frame assemblies until both frames aligned at the peaked as shown in Detail - A-. Secure roof frame Assemblies at the ridge with (7) 1/4-20 x 1-3/4" Long Hex Washer Head Screws, and (7) 1/4-20 Serrated Washer Nuts.

Important: Careful not to rip Foam weather-strip tape and do not over torque screws.

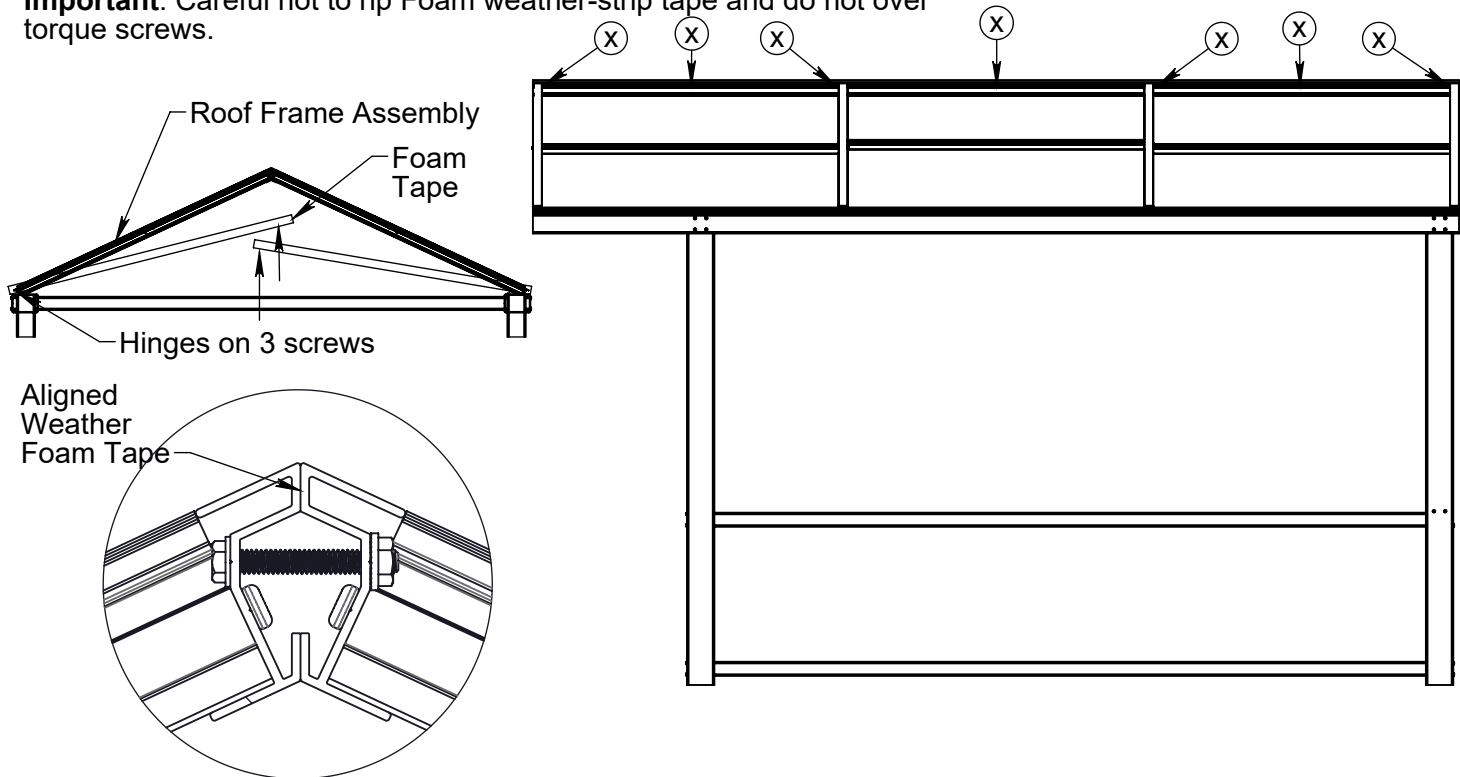

Step 6B: Secure Roof Frame Assemblies to Toprails.

Secure Roof Frame assembly to both Toprails with four (4) additional Taptite 1/4-20x1.0" screws coated with wax per side. Retighten screws noted by the -S- on both sides.



Step 7: Installing the roof panels

Each roof panel has a protective film that indicates the UV side. Position the panel so that the UV side is facing out. Remove the protective film from both sides. From the outside of the unit, slide both outer edges of the roof panel measuring 53.875" into the grooves of the roof slope as shown. Slowly guide the roof panel into place and be careful not to peel double sided tape on cross member. Once near the top, guide the top edge of the roof panel into the recessed area at the ridge as shown. You may need to push roof panel up from the inside of the unit to allow it to slide into the ridge groove.

Repeat this step to install the remaining roof panels.

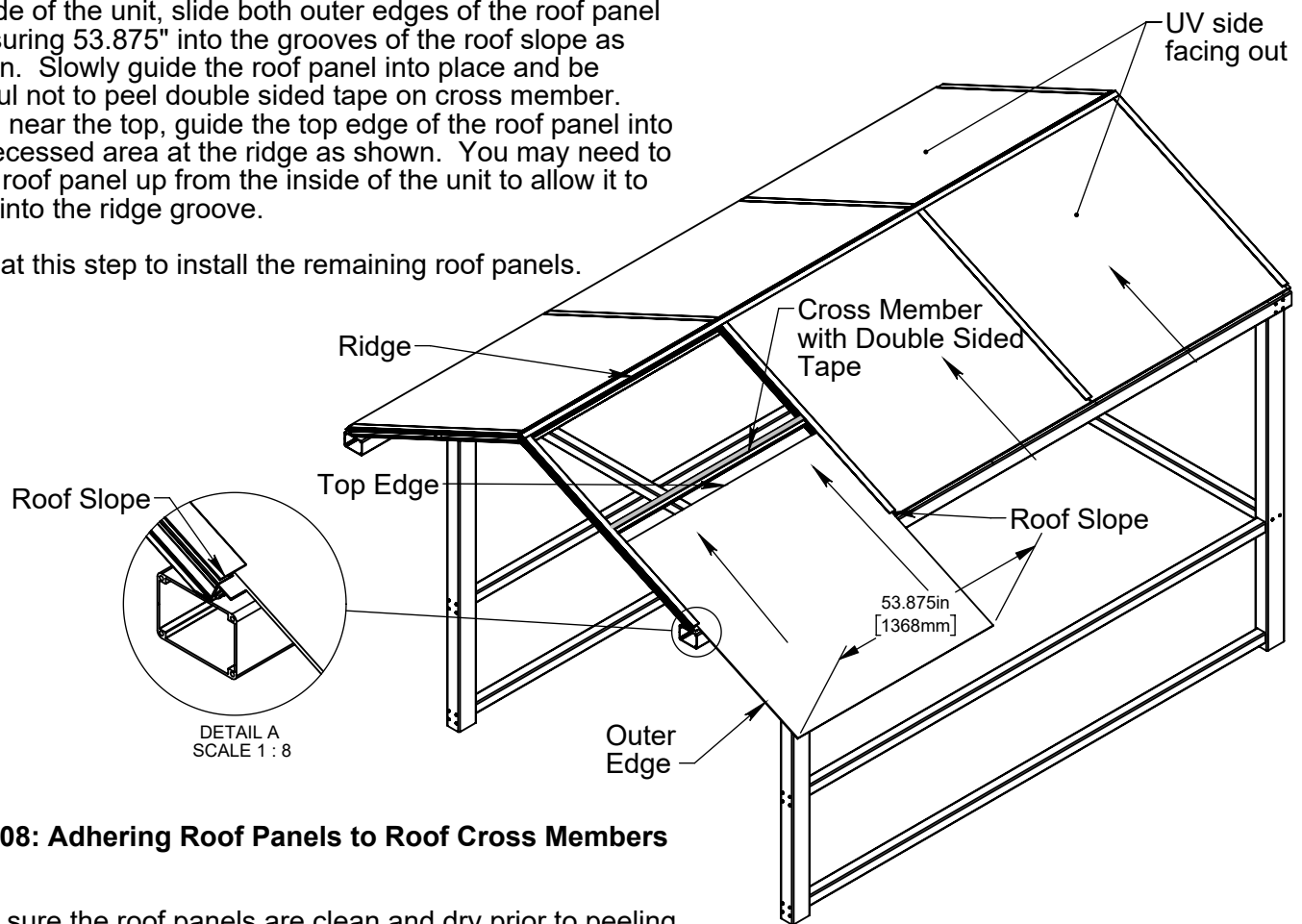

Step 08: Adhering Roof Panels to Roof Cross Members

Make sure the roof panels are clean and dry prior to peeling off the double sided tape on top of the cross members.

Peel off the protective paper from the double sided tape on top of the cross members. You will need to push panel upwards and away from cross member. Press roof panel into the cross member from the outside to make the panels adhere to the double sided tape.

Repeat for the remaining roof panels.

IMPORTANT: Make sure all Roof panels adhere to the double sided tape on cross members.

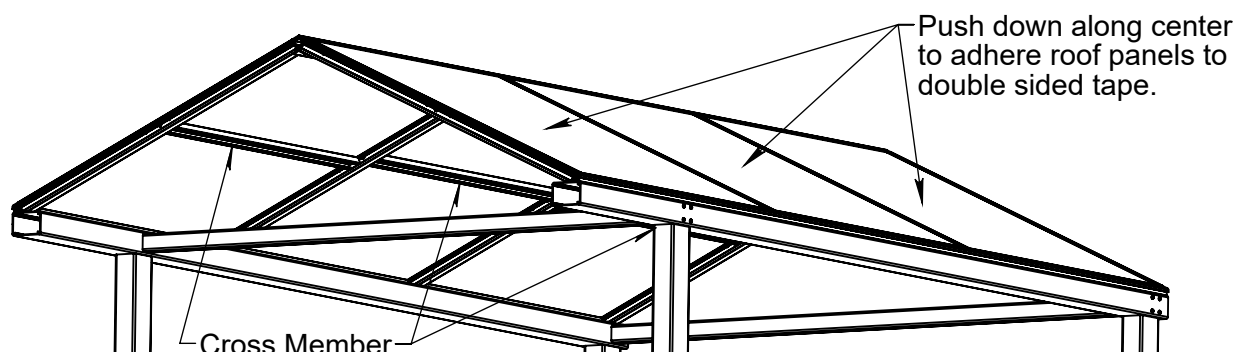

Step 9: Installing the retainer

From the front of the unit, slide the retainer so that the outer edge of roof panels are encapsulated. Please note that the lip will engage with sill on the inside. Make sure that the retainer is flush with the front and back of roof frame assembly. Repeat step to install the other retainer.

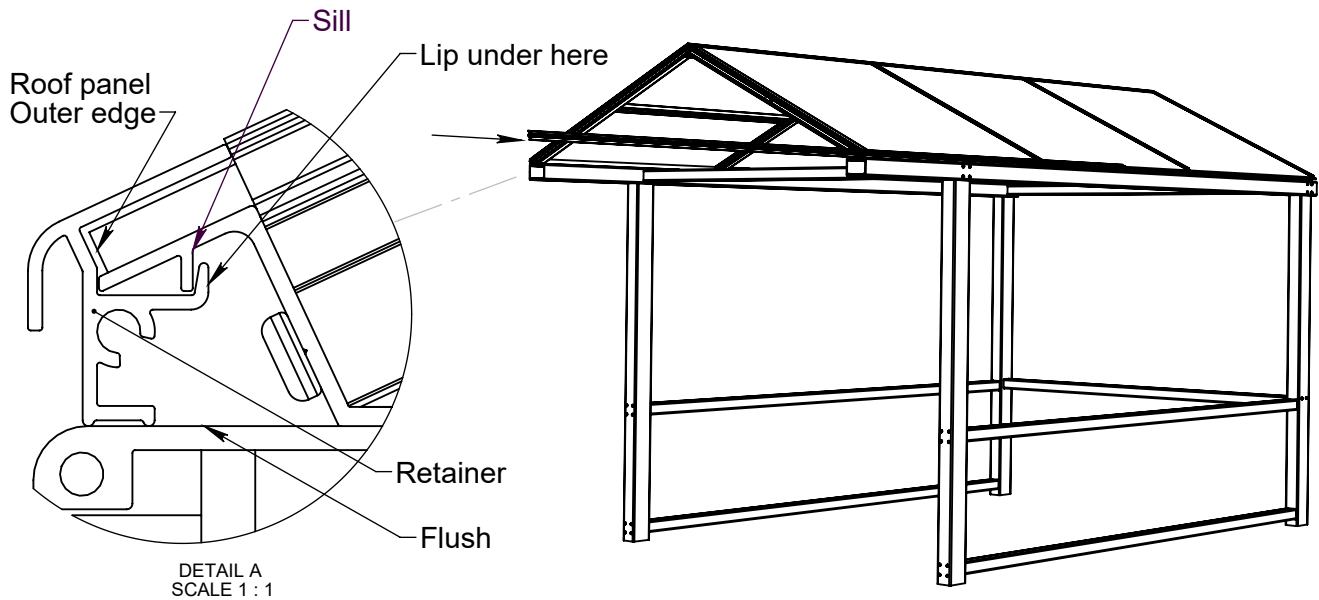

Step 10: Triglass Panel

Peel off the protective film from both sides of the tri-glass panel with Aluminum bottom support assembly. Locate tri-glass panel assembly onto the front of the unit so that its flush with the top outside perimeters of roof frame and that the aluminum support screws face the inside of the unit. Secure panel to roof frames with , (8) 1/4-20 x 1.0" Pan head Taptite screws coated with wax, and (8) 1/4" ID X 3/8" long aluminum shoulder spacers. Please slide aluminum spacers before installing Top Cap and all other fasteners. Repeat for additional tri-glass panels.

Important: Every fastener must have an aluminum spacer.

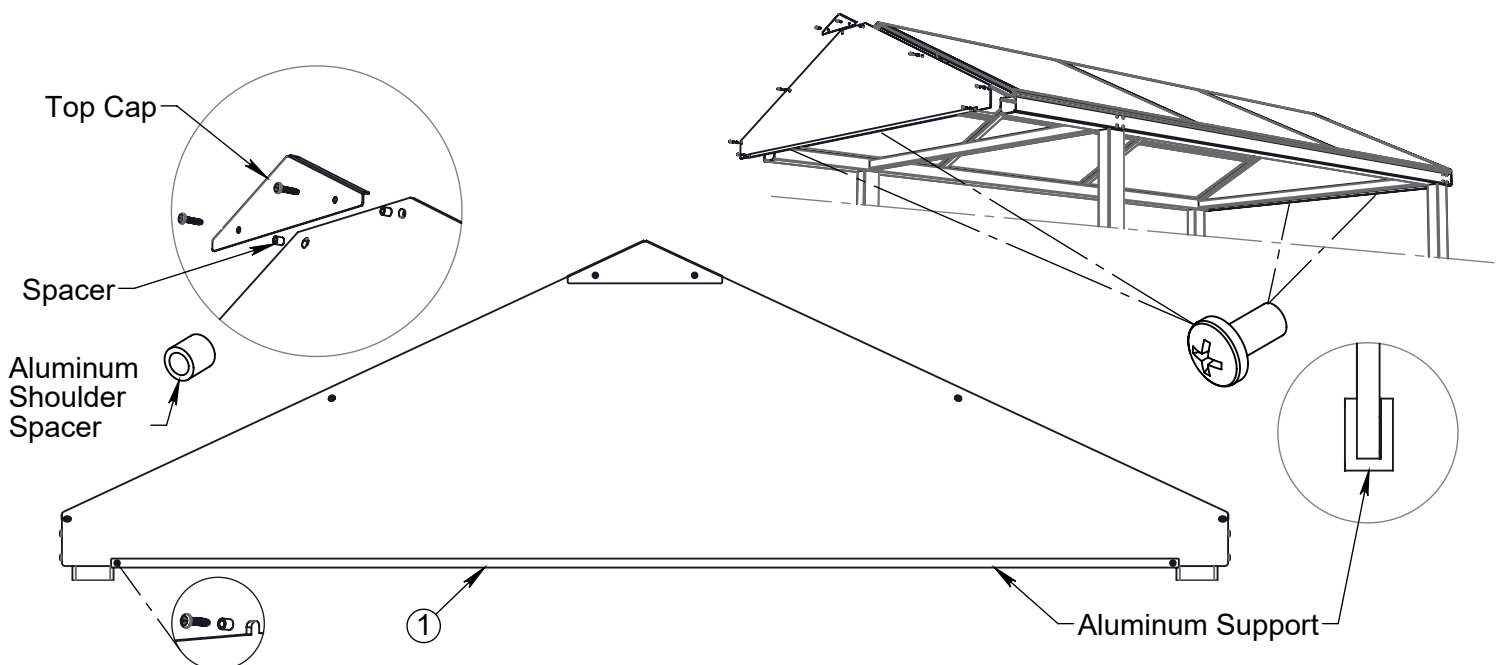

Step 11: Installing the Plastic Barriers

Remove lid caps from barriers by squeezing base where shown and pulling lid cap upwards. Slide barriers onto lower side rail and in between uprights. Slide -C- shape opening of barrier towards the vertical uprights until flush.

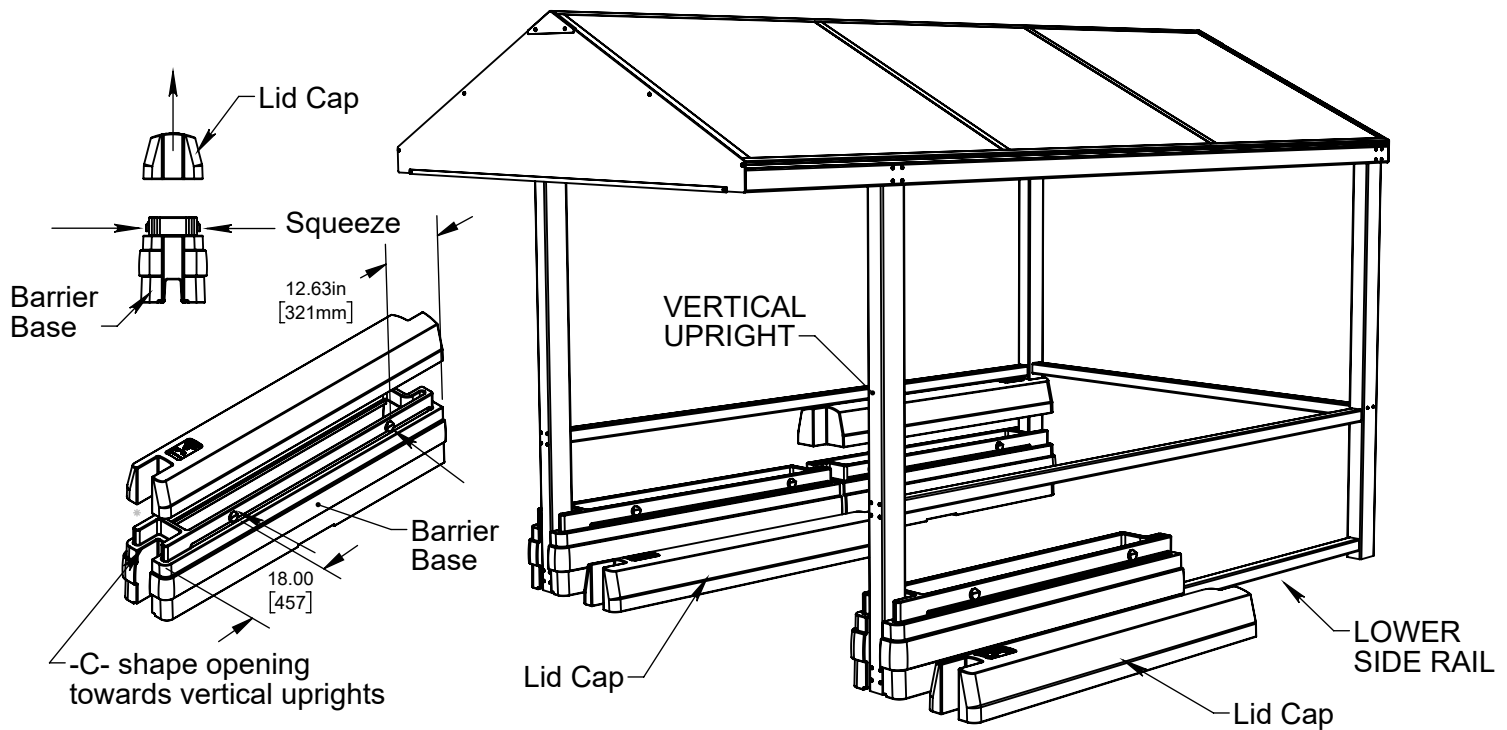

Step 12: Ballasting with Pea Stone, Sand or Gravel

Make sure unit is square and that is positioned straight and parallel inside parking space. **IMPORTANT:** ballast Cart Corral unit with sand, pea stone or gravel. Fill each barrier base with 300 pounds of sand, pea stone or gravel. The entire unit should be ballasted with a total weight of 1200 pounds. Balance the weight in each barrier by pouring along the entire length of barrier. Avoid compacting the material; this is not necessary.

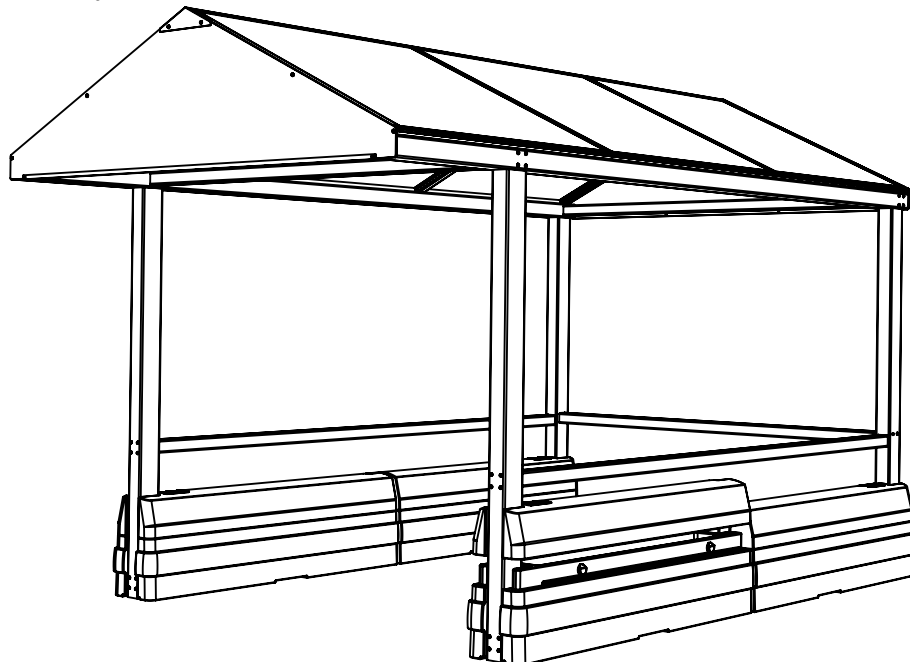

Step 13: Installing the Plastic Barrier Lid Caps

Cover each barrier base with its own lid cap. Slide open -C- at the front of the lid caps into the vertical uprights. Locate lid cap on top of barrier base and push down until the sides of lid cap locks and sit flush with barriers base. Repeat step to the remaining lid caps.

Important: Make sure all lid caps are sitting flush with barriers and locked.

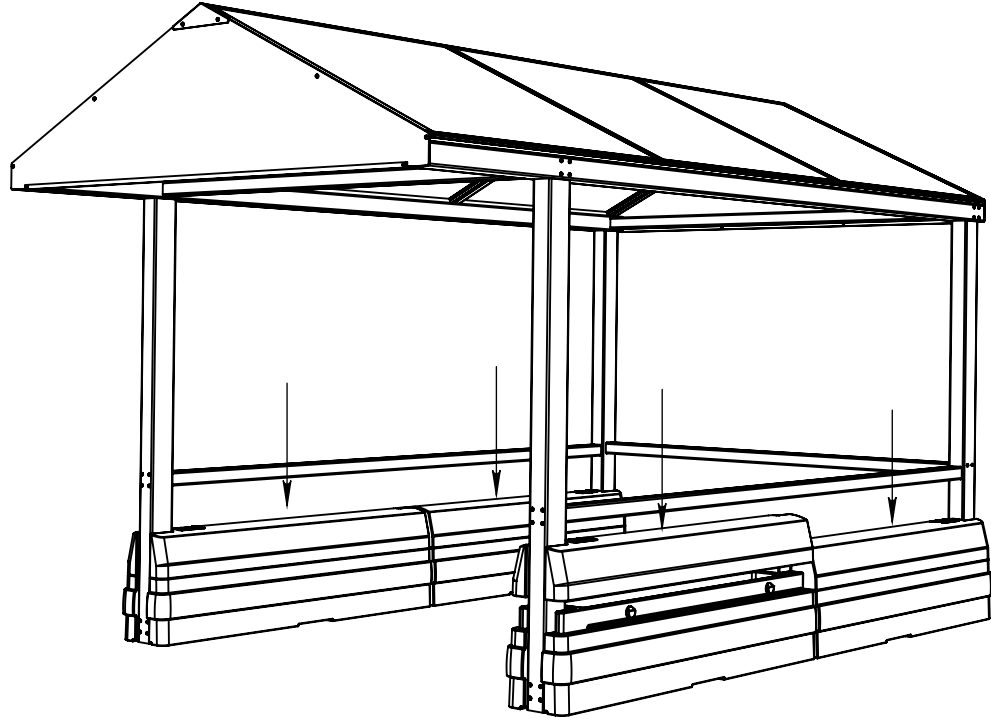

Step 14: Inspect and complete

Go over entire unit and make sure every hole has a screw.

Your unit is now complete!

