

CartGuard® 2 Flex



Eye-catching color with superior protection.

Our impact-resistant bumper provides reliable protection and a simply beautiful, curved aesthetic. It's designed to fit rounded fixture corners or other curved applications for strong, seamless protection.

Strong Flexible PVC flattens out upon impact and releases impact energy away from store fixtures

Speedy Install All parts snap together for easy installation and guaranteed alignment

Innovative Designed to wrap around curved fixtures and can complete a radius as small as 4 inches

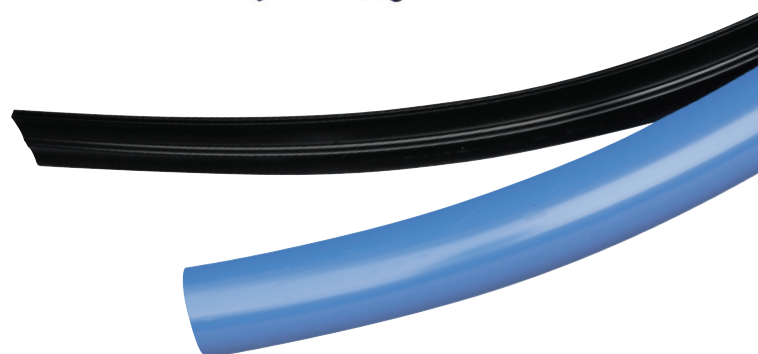

CartGuard® 2 Flex

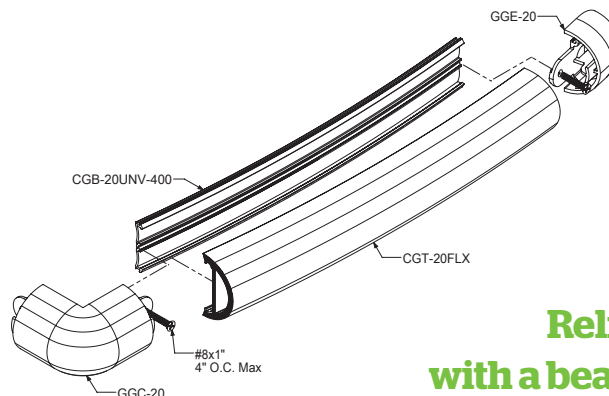
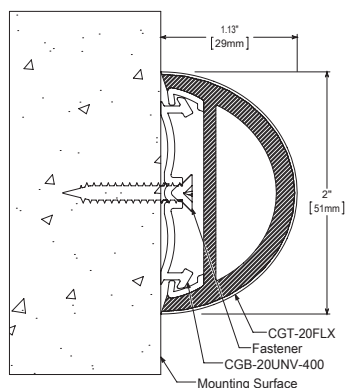

**Reliable protection
with a beautiful aesthetic!**

Components:

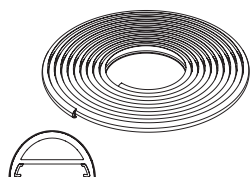

Flexible CartGuard® 2\"/>

CGT-20FLX-COLOR

Sold in 72' lengths

Packed: 72' coil per box



2\"/>

CGB-20UNV-400

Sold in 12' lengths

Packed: 24 per box (288' total)

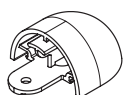

2\"/>

GGE-20-COLOR

Packed: 200 per box

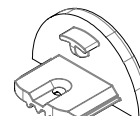

2\"/>

GGE-20DS-COLOR

Packed: 250 per box

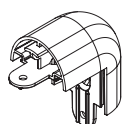

2\"/>

GGC-20-COLOR

Packed: 100 per box

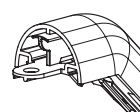

2\"/>

GGC-20.45-COLOR

Packed: 100 per box

* 2\"/>



Stock Colours
4 week lead time.



Standard Colours
4 week lead time.



Custom Colour Matching
12 week lead time, otherwise
allow 16 weeks for delivery.
Minimums may apply.



Global Headquarters
Danvers, MA, 01923, USA
(800) 800-8503
cservices@mccue.com

McCue UK
Milton Keynes, United Kingdom
+44 1908-365-511
uksales@mccue.com

McCue Asia
Xiamen, Fujian, China
+86-592-2200 790
rchen@mccue.com

McCue Europe
Ulm, Germany
+49 731 40 38 82 68
eusales@mccue.com

mccue.com



April 2024